



# Sd.Kfz. 247 Ausf.B

1/35 SCALE MODEL KIT No 35110

## Sd.Kfz. 247 Ausf.B

### Германский командный броневеомобиль II MB

Schwerer geländegängiger gepanzerter Personenkraftwagen (Sd.Kfz. 247 - тяжёлый внедорожный бронированный пассажирский автомобиль) - специализированный штабной бронированный невооружённый автомобиль вермахта. Единственным производителем был Daimler-Benz.

Двухосная модификация Sd.Kfz. 247 Ausf.B производилась на базе шасси Horch 108. В 1941-1942 г. было выпущено 58 экземпляров.

Несмотря на немногочисленность, машина активно применялась на начальном этапе Второй мировой войны.

### Тактико-технические характеристики броневеомобилья Sd.Kfz. 247 Ausf.B

Боевая масса, т	4,46
Экипаж, чел.	2+4
Длина, мм	5000
Ширина, мм	2000
Высота, мм	1800
База, мм	3000
Колея передняя, мм	1646
Колея задняя, мм	1646
Двигатель	Auto-Union V8-108, 81 л.с.
Максимальная скорость, км/ч	80
Запас хода, км	400
Бронирование, мм	8
Радиостанция	Fu Spr Ger (f)

## Sd.Kfz. 247 Ausf.B

### WWII German Armoured Command Vehicle

Schwerer geländegängiger gepanzerter Personenkraftwagen (Sd.Kfz. 247 - heavy off-road armored passenger vehicle) was a specialized command armored unarmed vehicle of the Wehrmacht. Daimler-Benz was the only manufacturer.

Four-wheeled modification of the Sd.Kfz. 247 Ausf.B was produced on the basis of the Horch 108 chassis. In 1941-1942 58 were produced.

Despite the small number, the car was actively used at the initial stage of the Second World War.

### Tactical and Technical Specifications of Sd.Kfz. 247 Ausf.B

Combat weight, kg	4,46
Crew, men	2+4
Length, mm	5000
Width, mm	2000
Height, mm	1800
Wheel base, mm	3000
Track front	1646
Track rear, mm	1646
Engine	Auto-Union V8-108, 81 hp
Max. Speed, km/h	80
Range, km	400
Armour, mm	8
Radio station	Fu Spr Ger (f)

## ИСПОЛЬЗУЕМЫЕ КРАСКИ / USED COLORS:

	COLOR	Revell	Tamiya
A	Черный, полуматовый   Semigloss Black	302	X18
B	Темно-серый, матовый   Tank Grey	178	XF63
C	Белый, матовый   Flat White	105	XF2
D	Дерево   Wood	189	XF78
E	Темно-желтый, матовый   Dark Yellow	188	XF60
F	Сталь   Steel	191	X32

	COLOR	Revell	Tamiya
G	Темная сталь   Gunmetal	109	X10
H	Серебристый   Chrome Silver	190	X11
J	Ржавчина   Rust	183	XF64
K	Серо-зеленый, матовый   Feldgrau	167	XF22
L	Красный, глянцевый   Red	131	X7

### 01 СТАДИЯ СБОРКИ ASSEMBLY STEP

### A ИСПОЛЬЗУЕМАЯ КРАСКА USED COLOR

### ПРИ СБОРКЕ НЕ ИСПОЛЬЗУЕТСЯ PARTS NOT FOR USE

### 03 СБОРОЧНАЯ ЕДИНИЦА ASSEMBLY UNIT

### x2 СДЕЛАТЬ ДВЕ ДЕТАЛИ MAKE 2 PCS

### ? ПРОИЗВОЛЬНЫЙ ВЫБОР OPTIONAL

## ВНИМАНИЕ!

Перед сборкой внимательно прочитайте руководство по монтажу. Каждая деталь пронумерована. Соблюдать последовательность монтажа. Необходимые рабочие инструменты: нож и напильник для зачистки деталей; резиновая лента, клейкая лента и зажимы для сушки белья для прижимания склеиваемых деталей. Детали из пластика очистить в растворе мягкого моющего средства и высушить на воздухе для того, чтобы краска и переводные картинки лучше прилипали. Перед приклеиванием проверить, подходят ли детали; клей наносить экономно. Хром и краску удалить с поверхностей склеивания. Небольшие детали покрасить перед тем, как они будут удалены из рамок. Краску необходимо хорошо просушить, только после этого продолжать сборку. Каждую соответствующую переводную картинку отдельно вырезать и примерно на 20 секунд окунуть в теплую воду. На обозначенном месте картинку отделить от бумаги и прижать промокательной бумагой.

## CAUTION!

Read the instructions thoroughly prior to assembly. Each component is numbered. Adhere to specified sequence of assembly. Tools required: knife and file for removal of components from frame; rubber bond, adhesive tape and clothes pegs for clamping components together after applying adhesive. Clean plastic components in a mild detergent solution and allow to air-dry so that paint and transfers adhere better. Prior to applying adhesive, check to see whether the components fit together; apply adhesive sparingly. Remove chrome and paint from the contact surfaces. Paint small components before removing them from the frame. Allow paint to dry well, and only then continue to assemble. Cut out each transfer individually and immerse in warm water for approx. 20 seconds. Slide transfer off paper and into designated position, then press on with blotting paper.

ООО ICM Холдинг  
ул. Бориспольская 9, строение 64,  
02099, Киев, Украина  
Тел./факс: +38(044) 369 54 12  
E-mail: export@icm.com.ua



ICM Holding  
Borispolskaya, 9, build. 64,  
02099, Kiev, Ukraine  
Tel./Fax: +38(044) 369 54 12  
E-mail: export@icm.com.ua

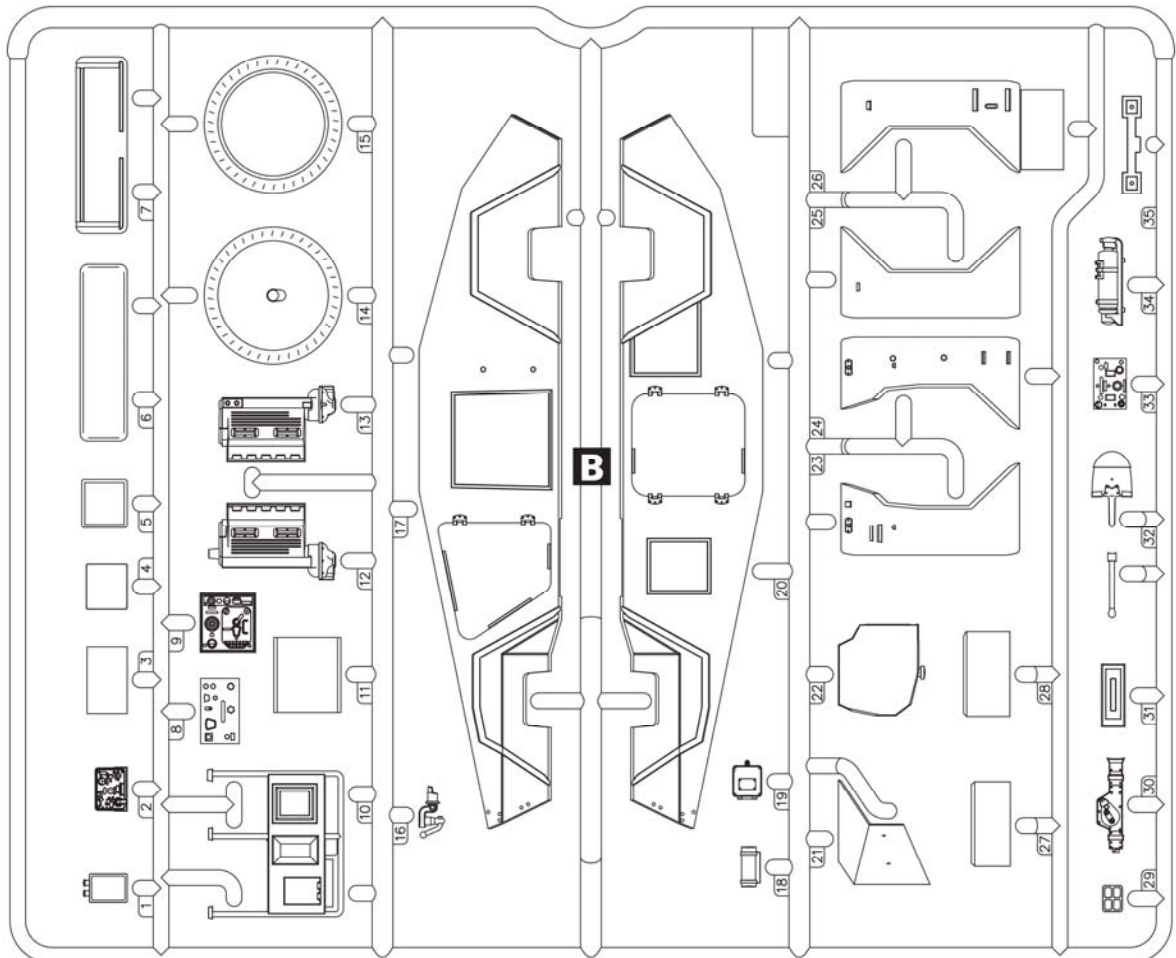
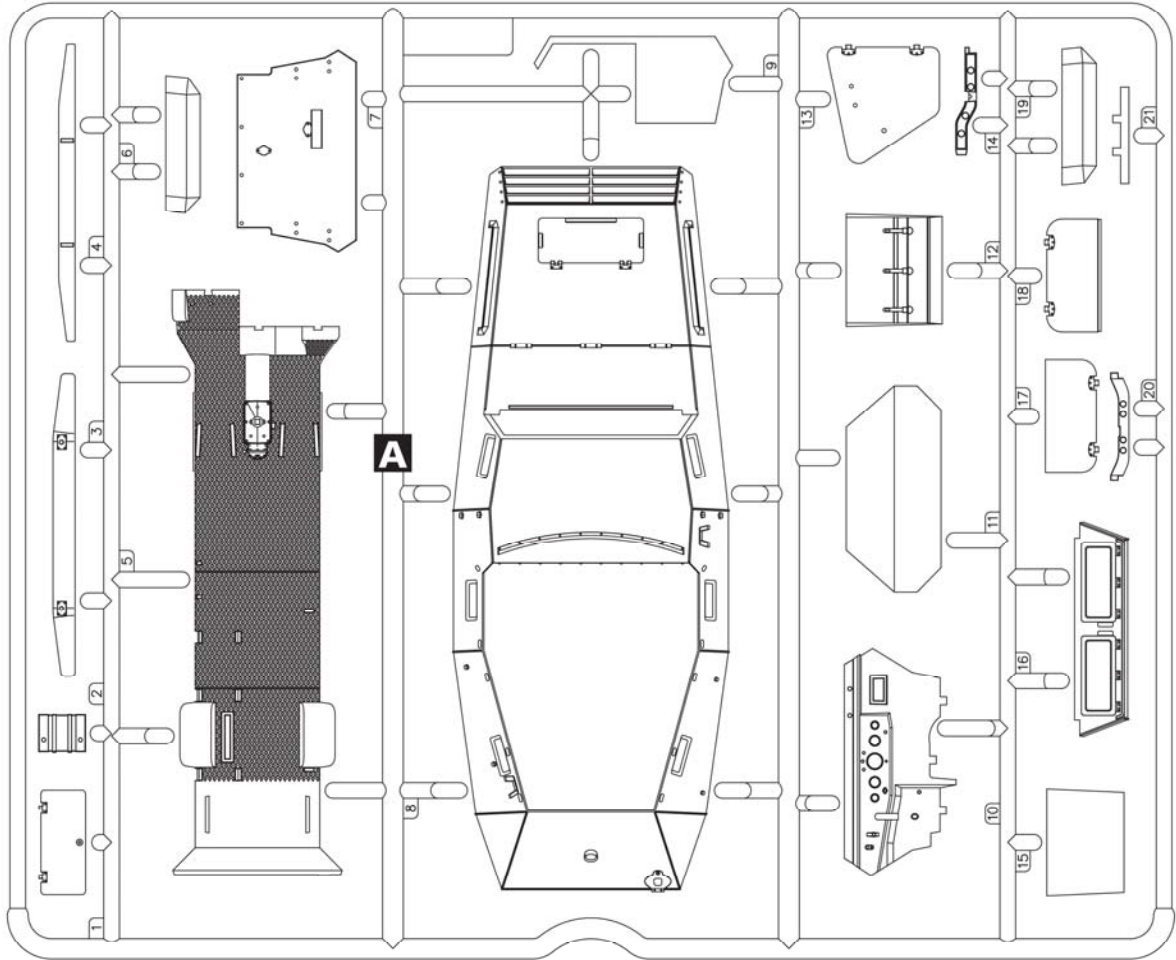

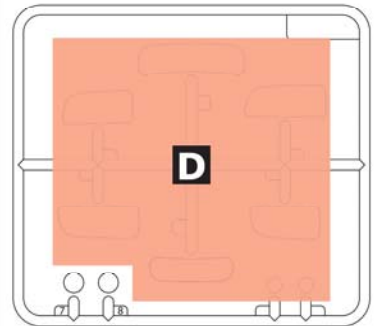
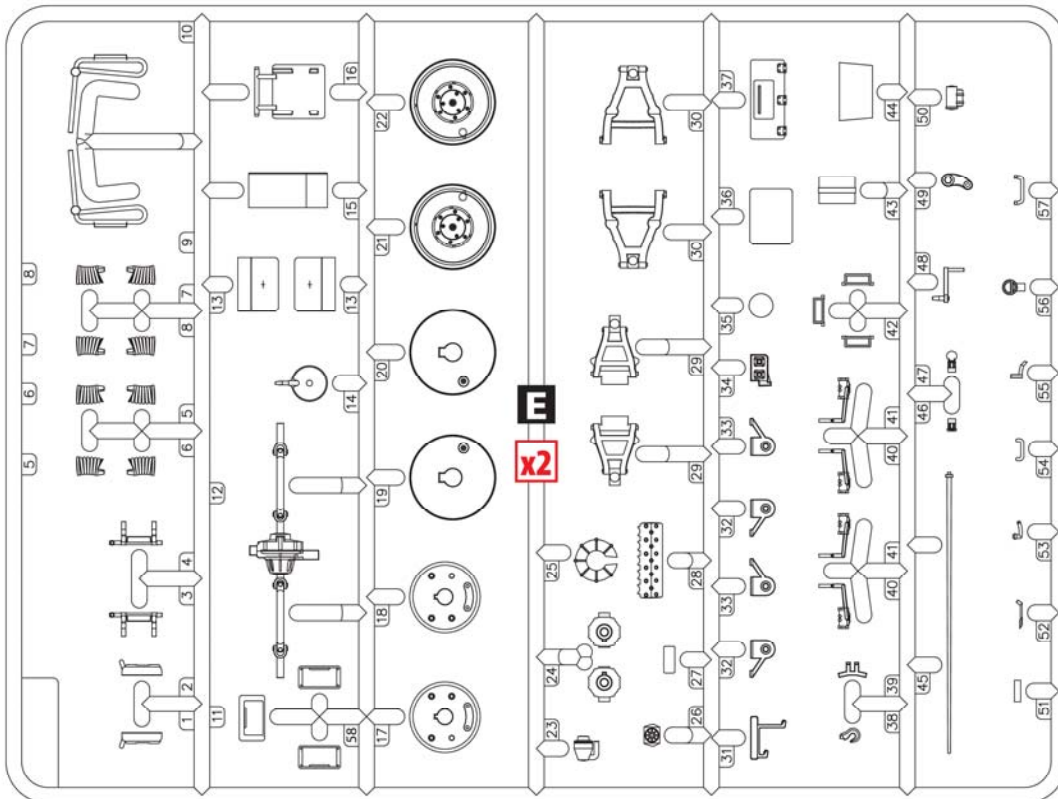
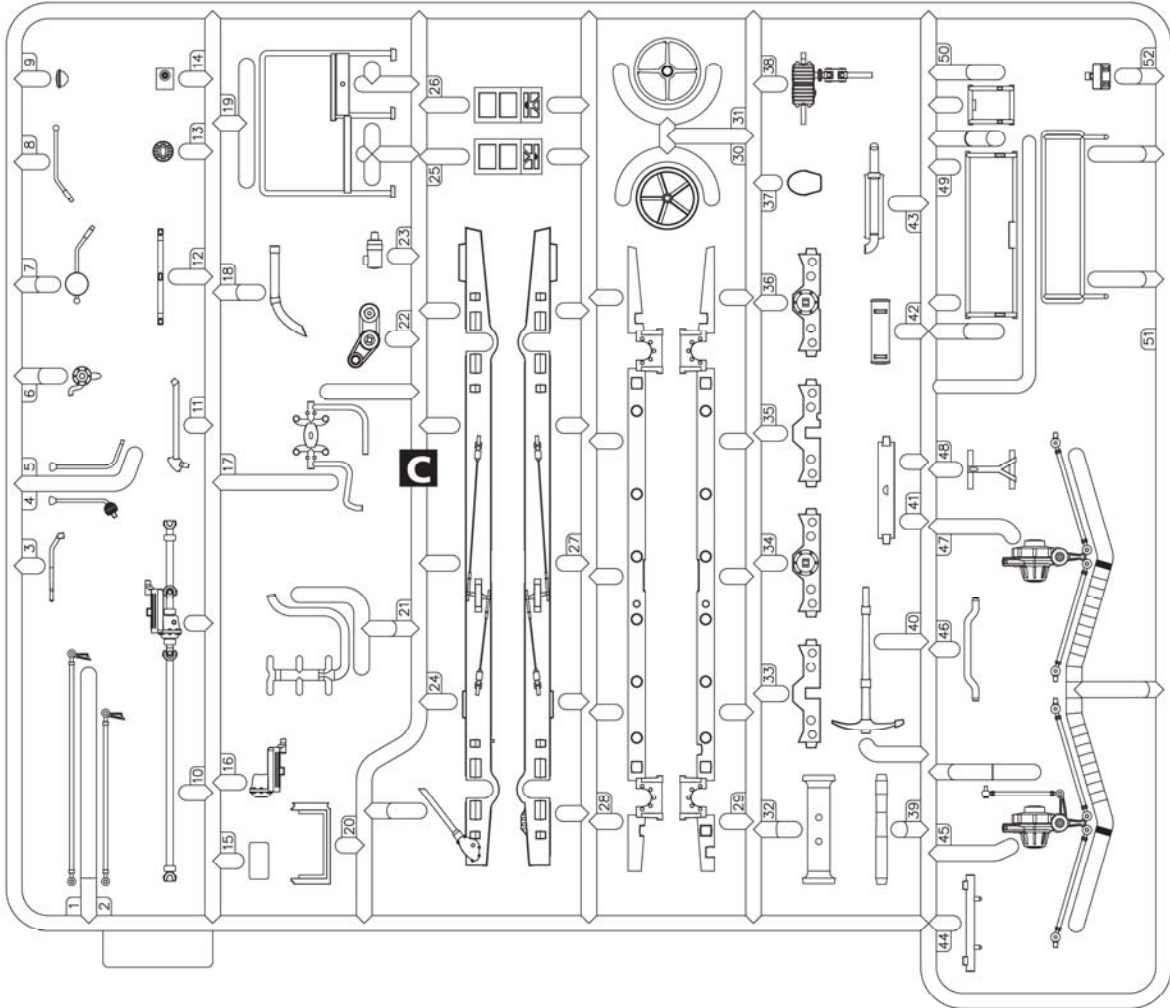

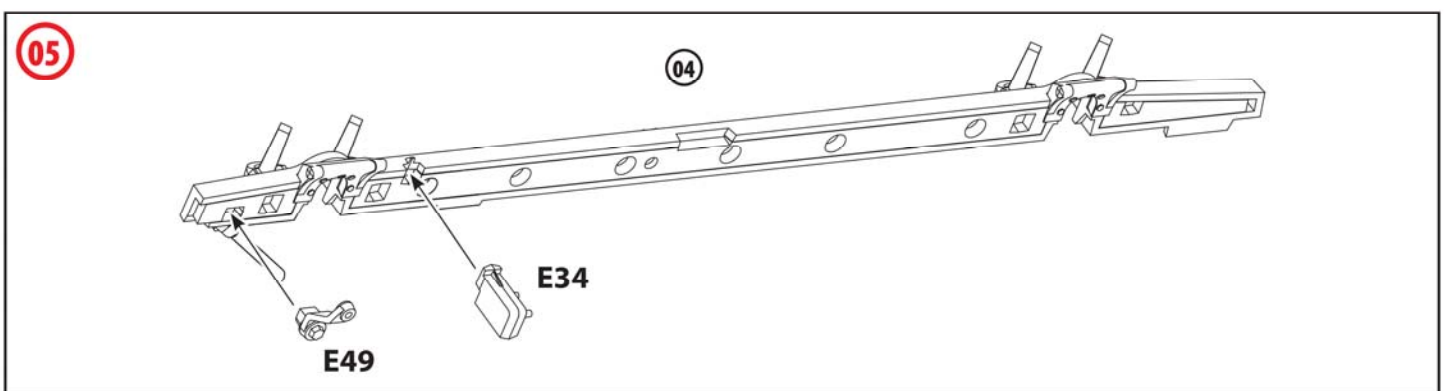
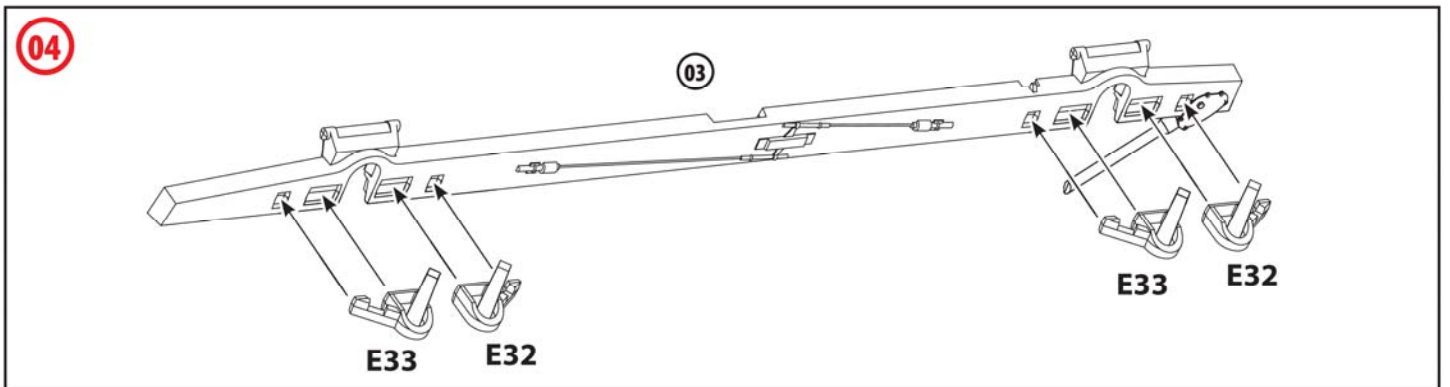
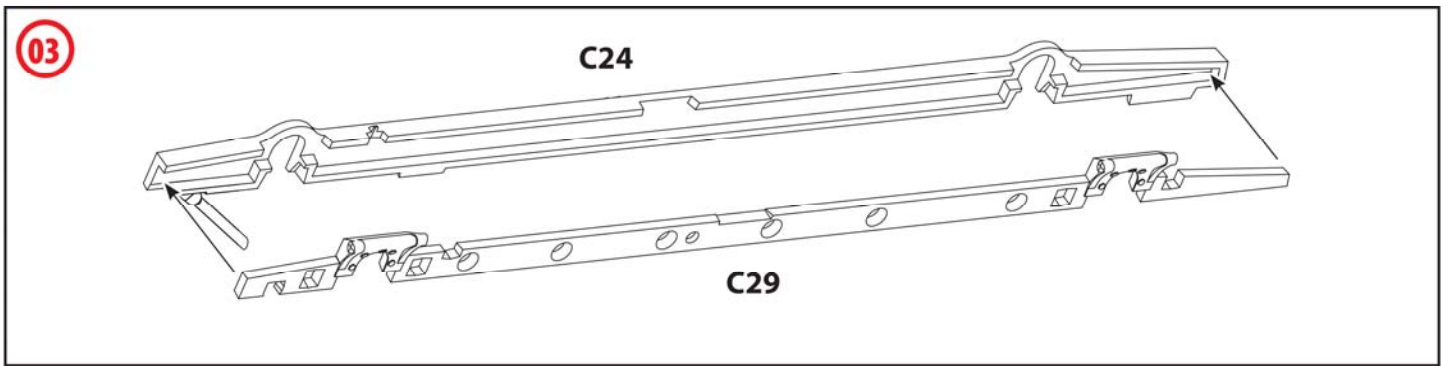
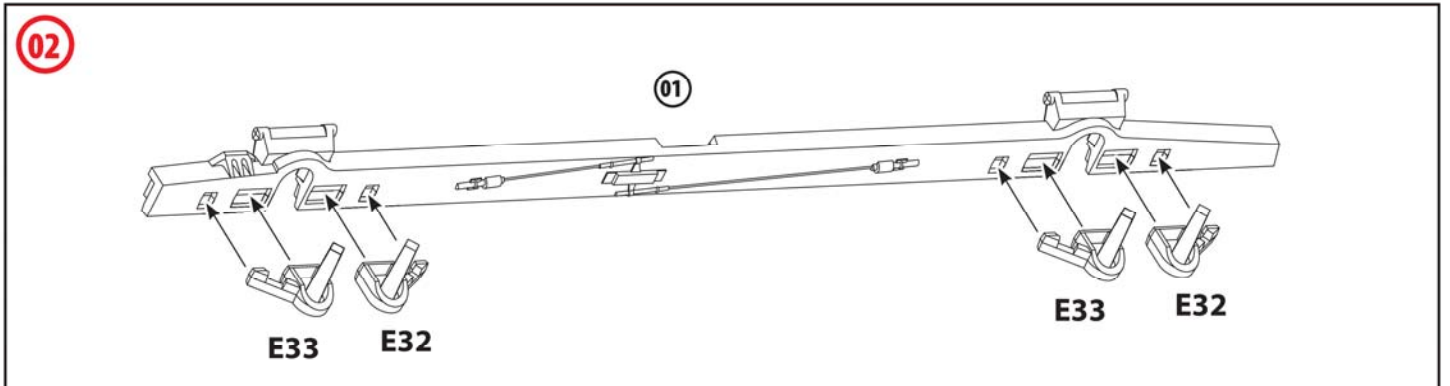
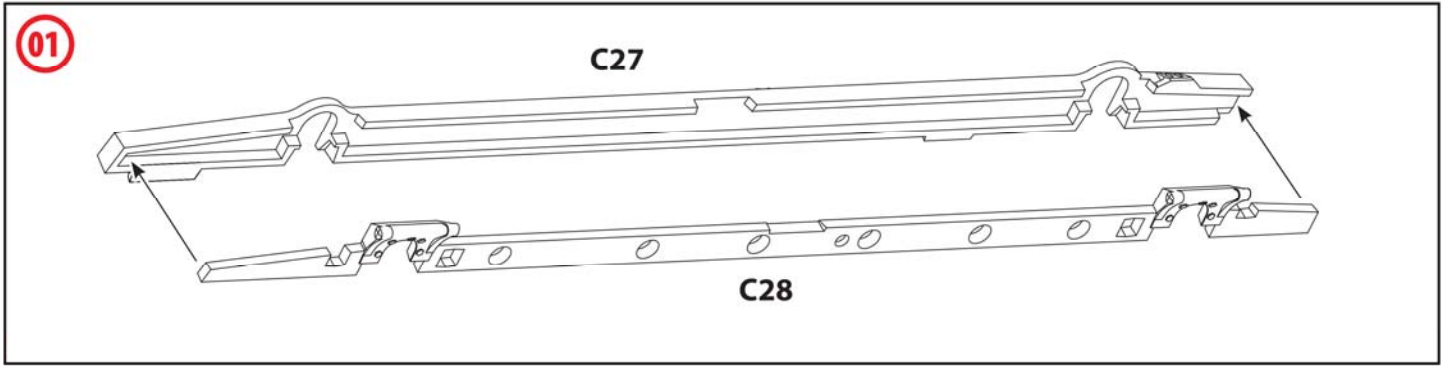

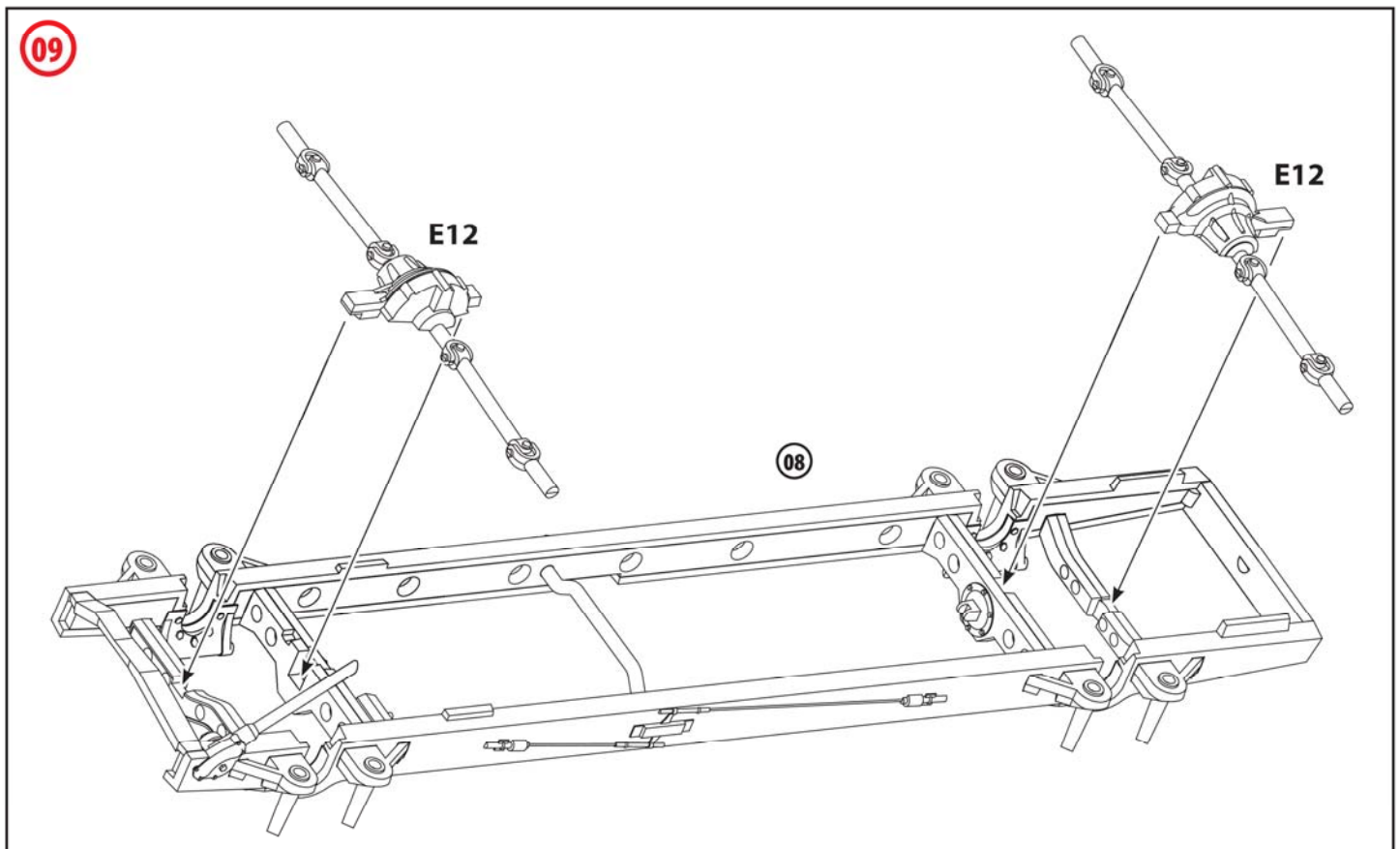
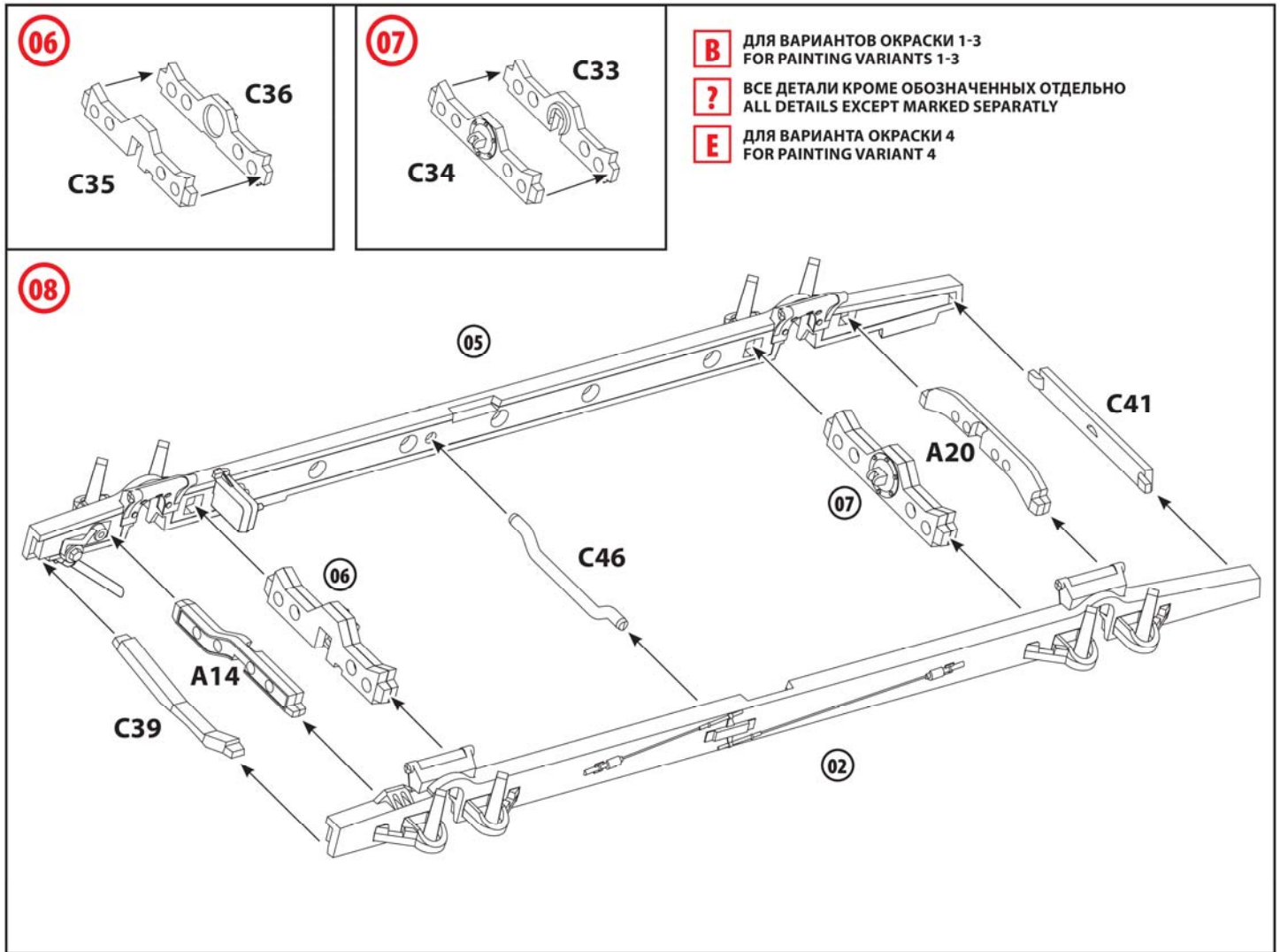

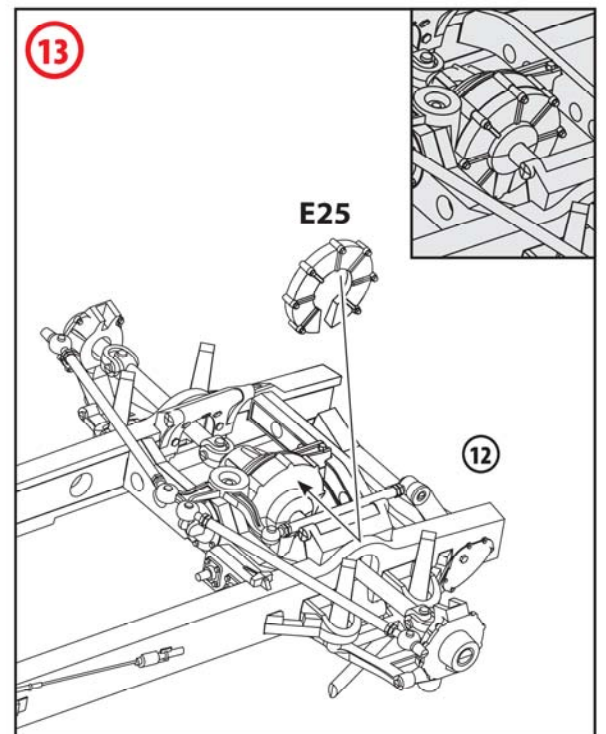
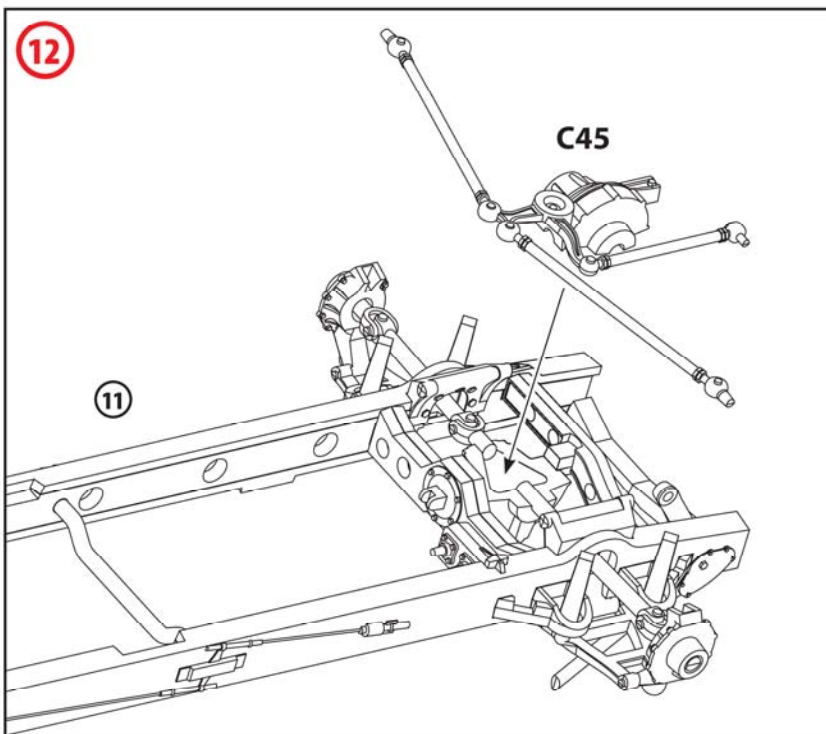
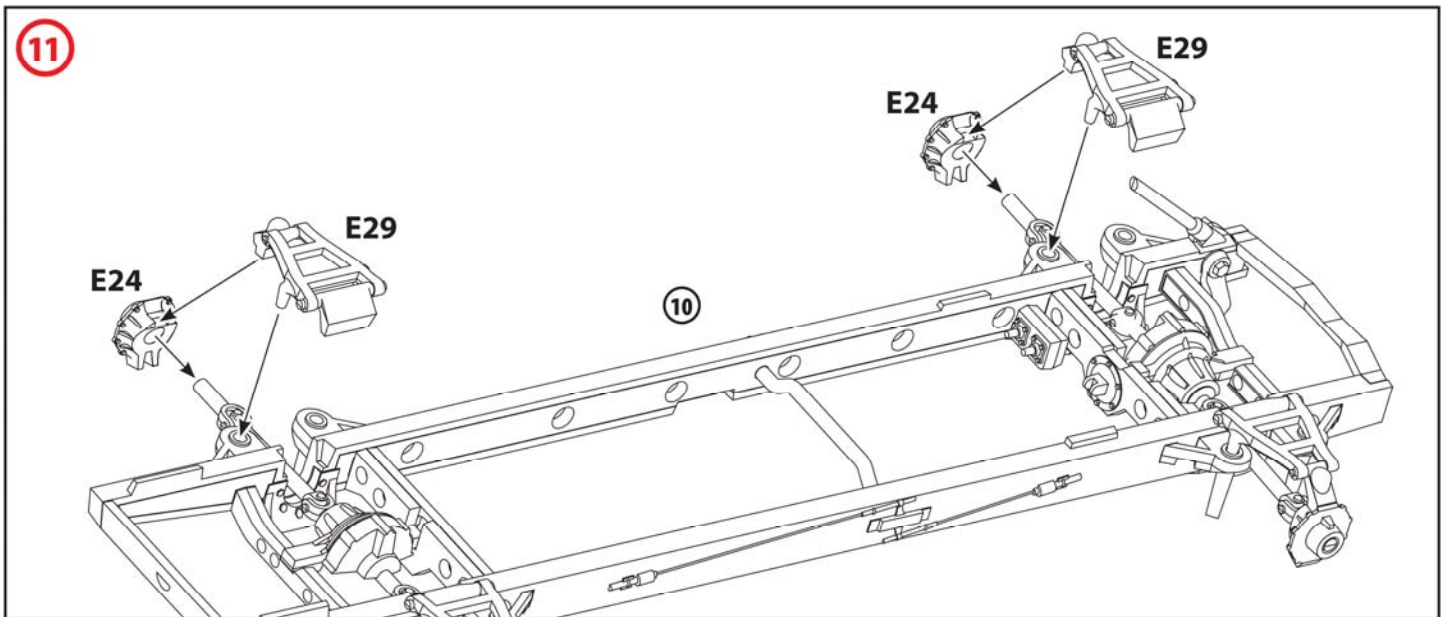
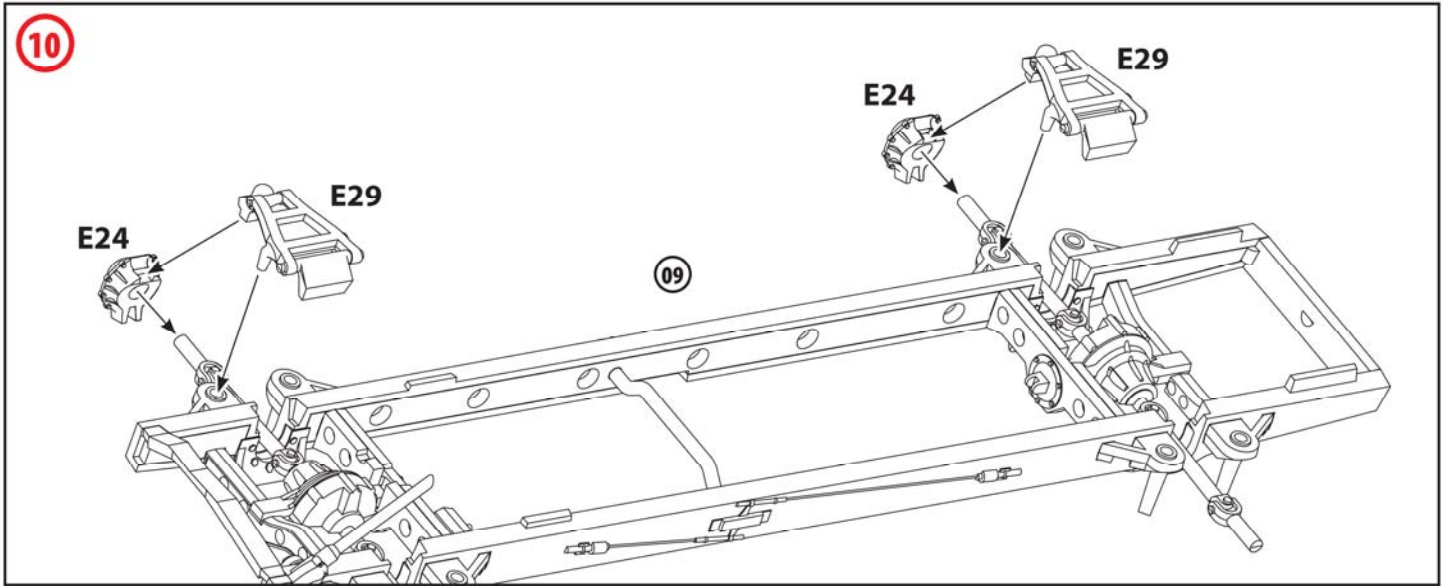

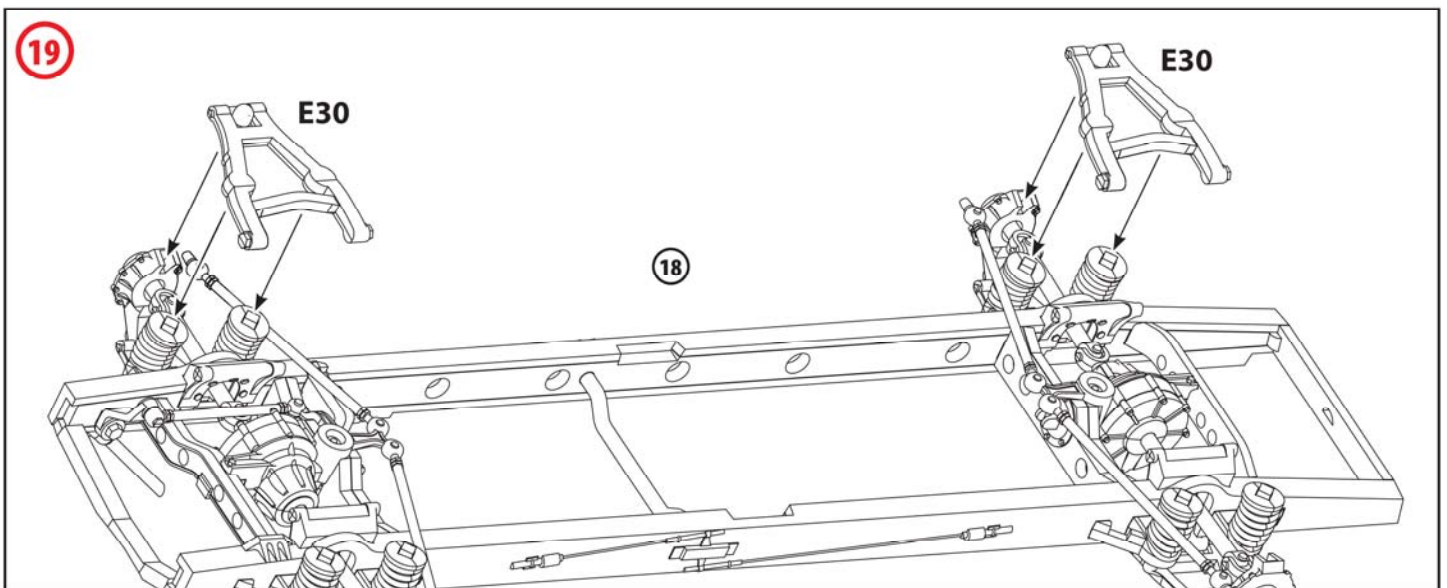
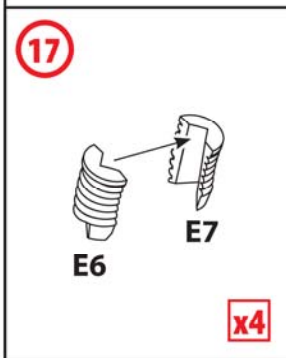
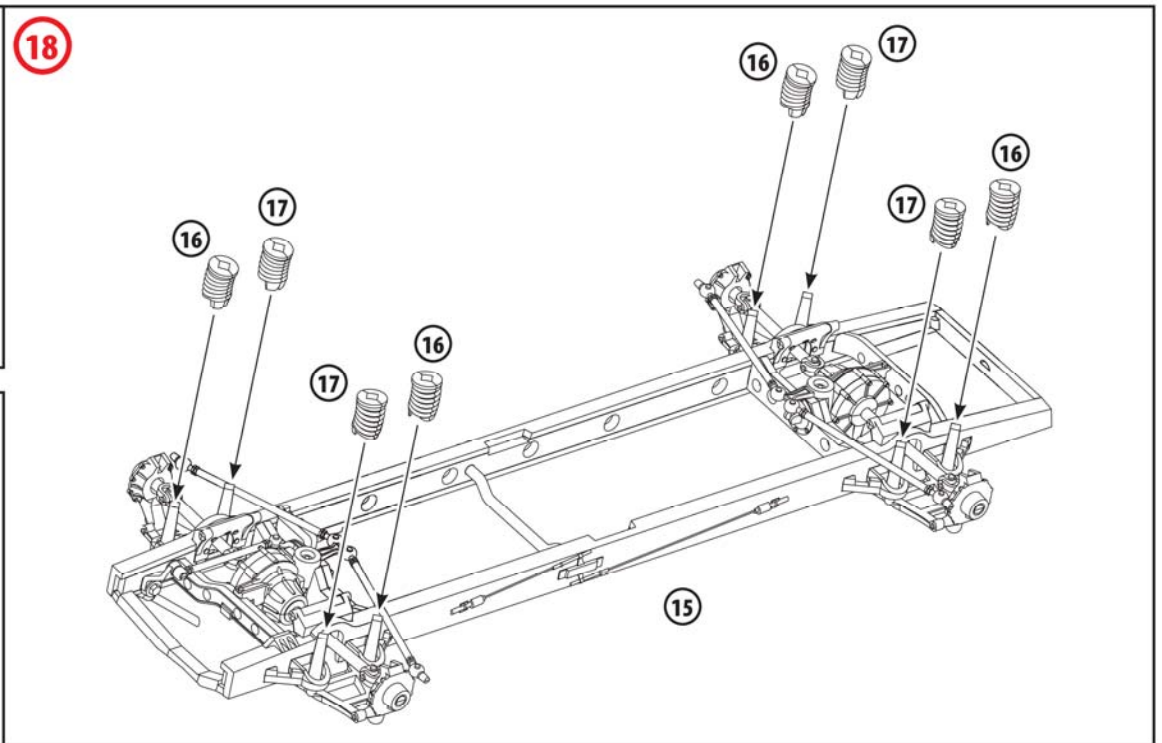
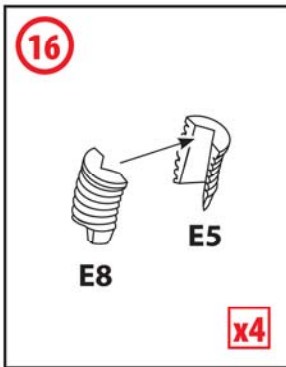
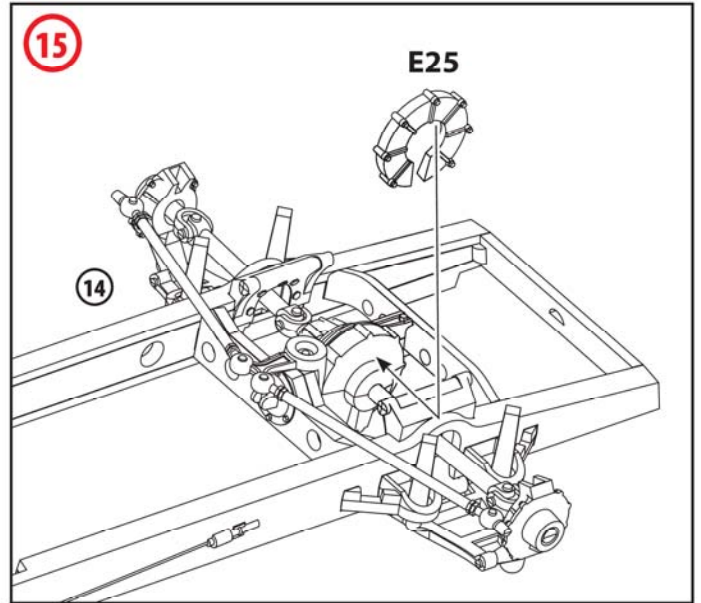
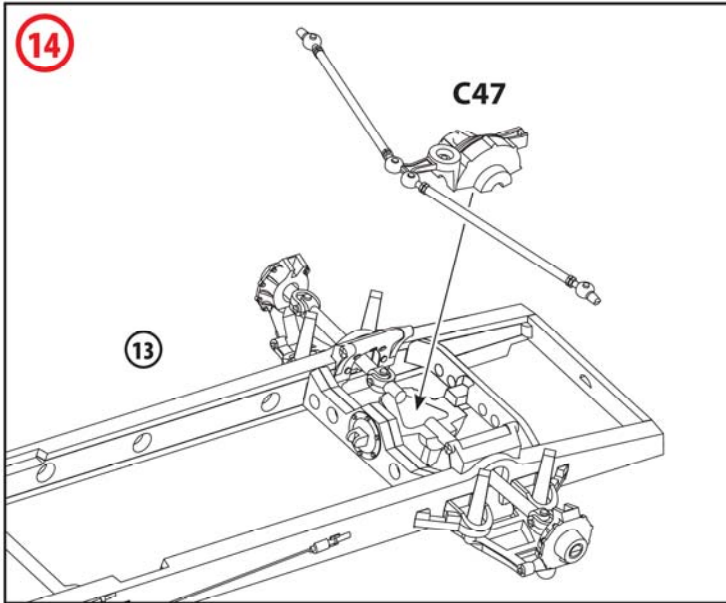

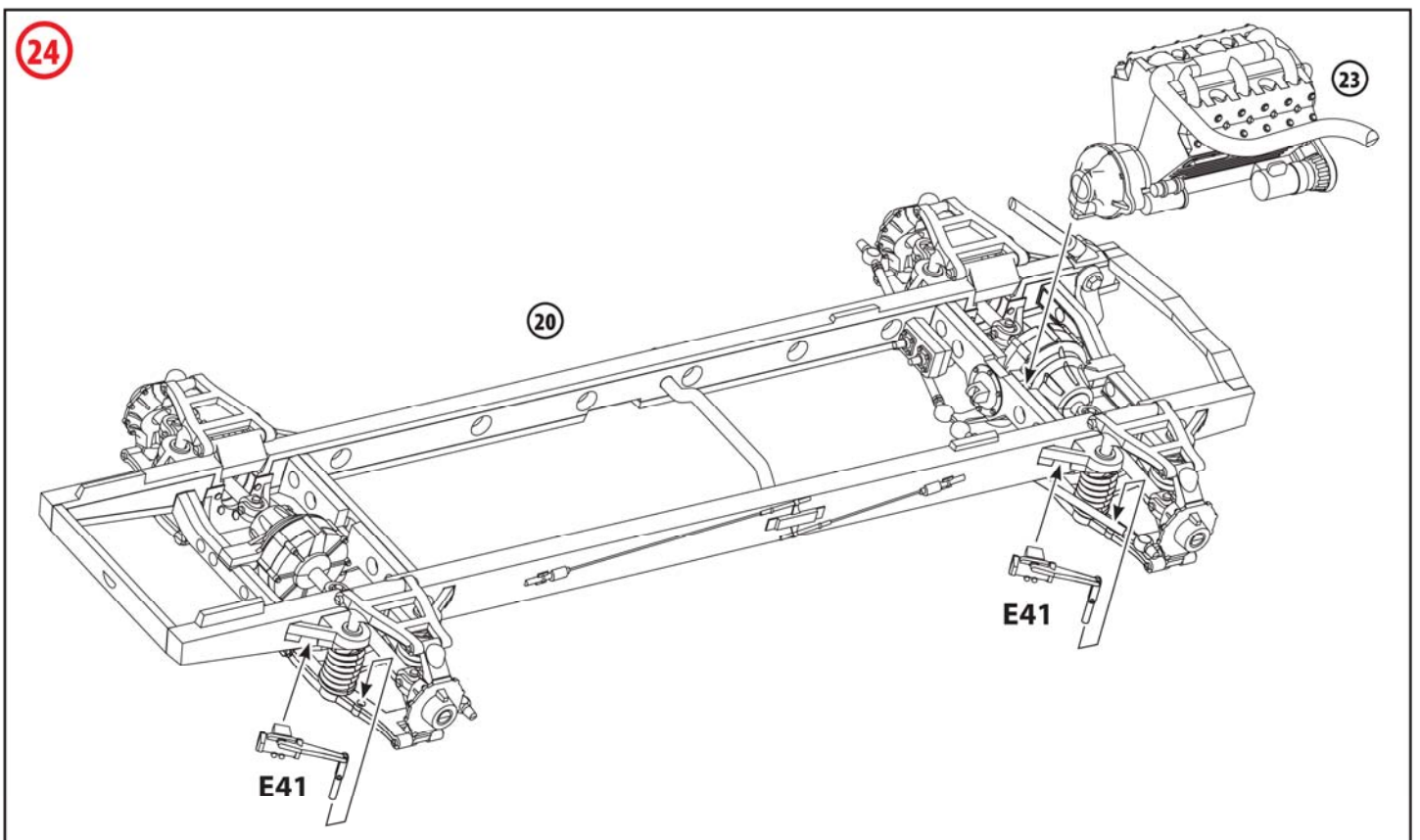
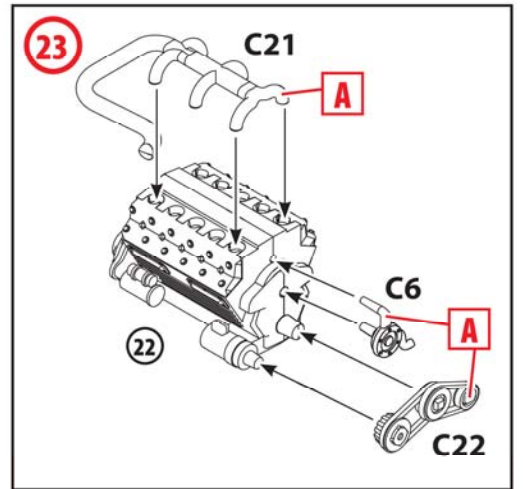
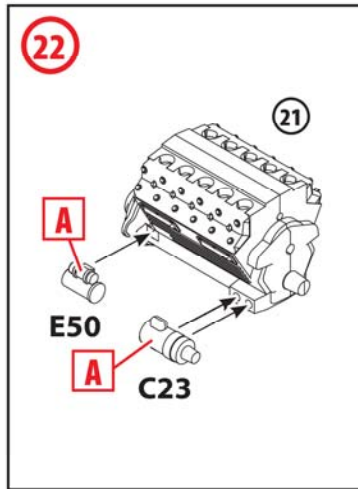
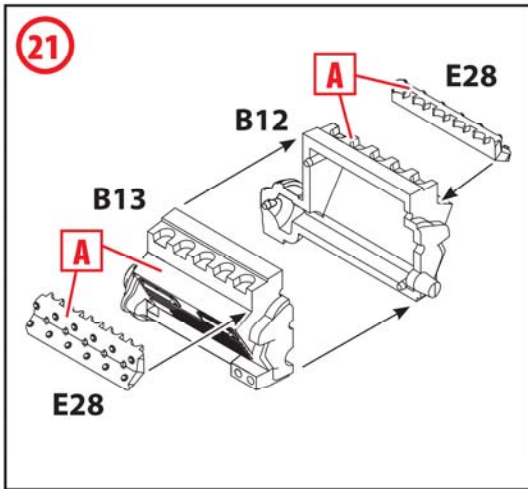
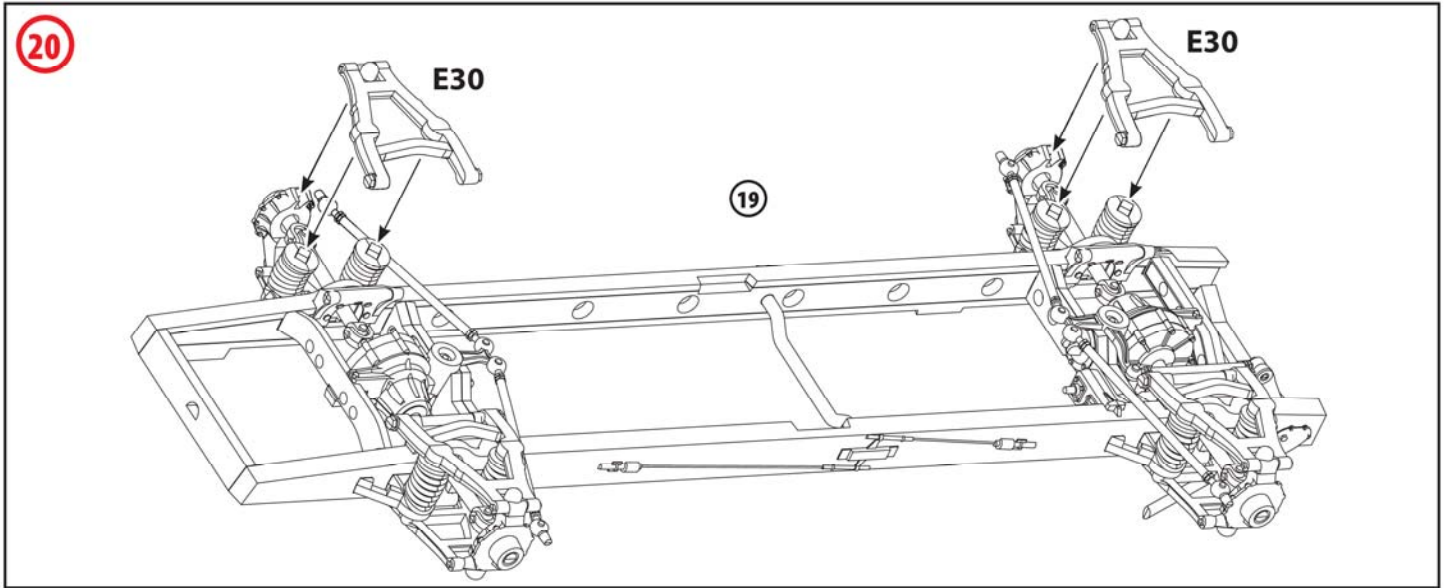



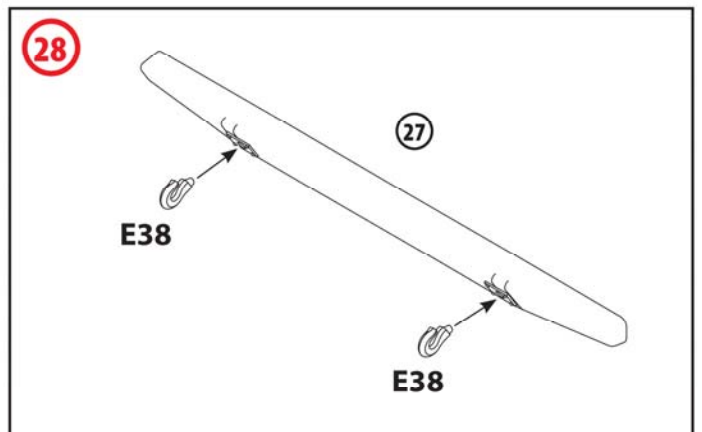
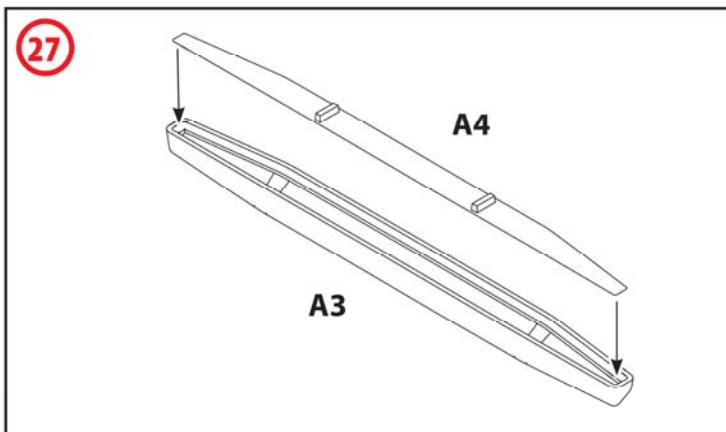
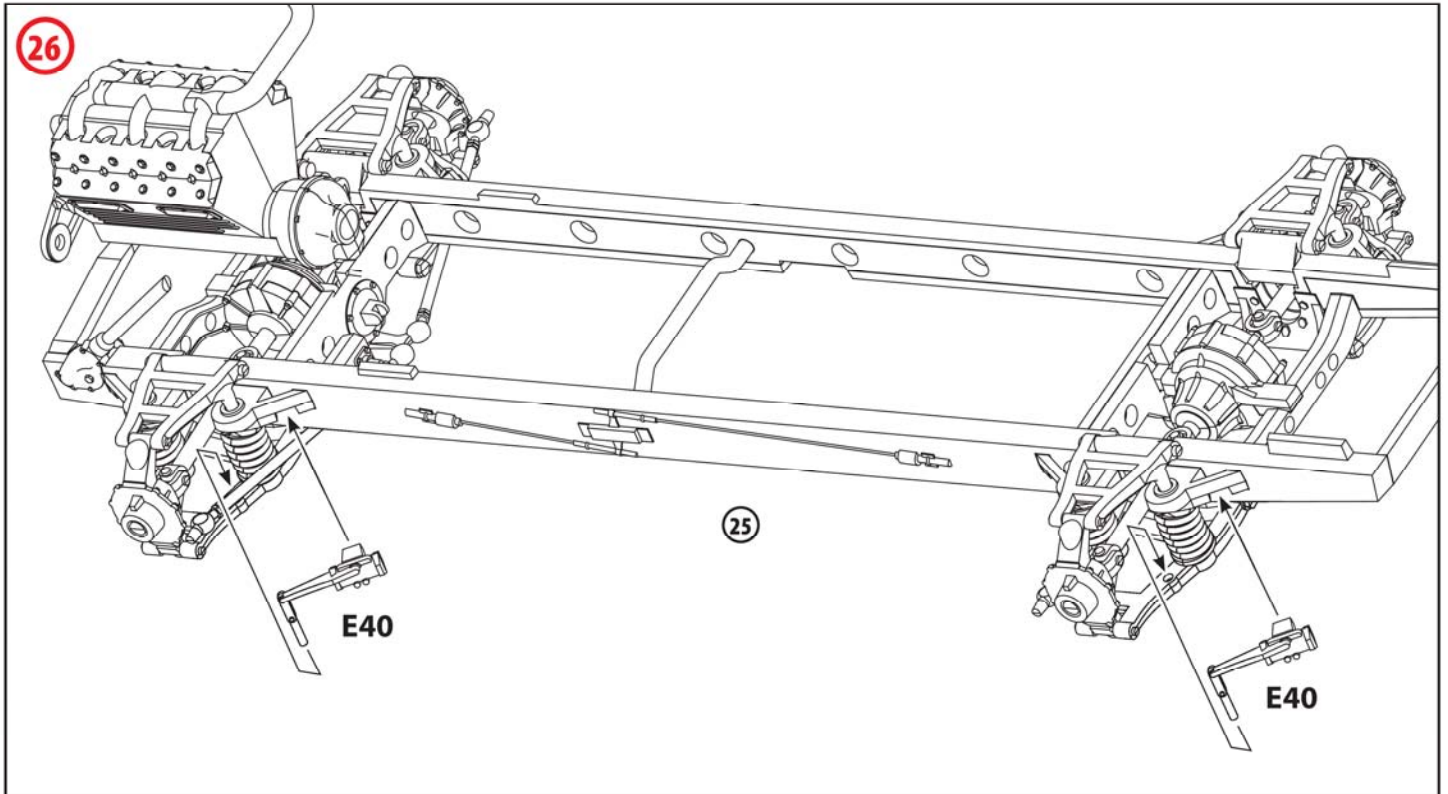
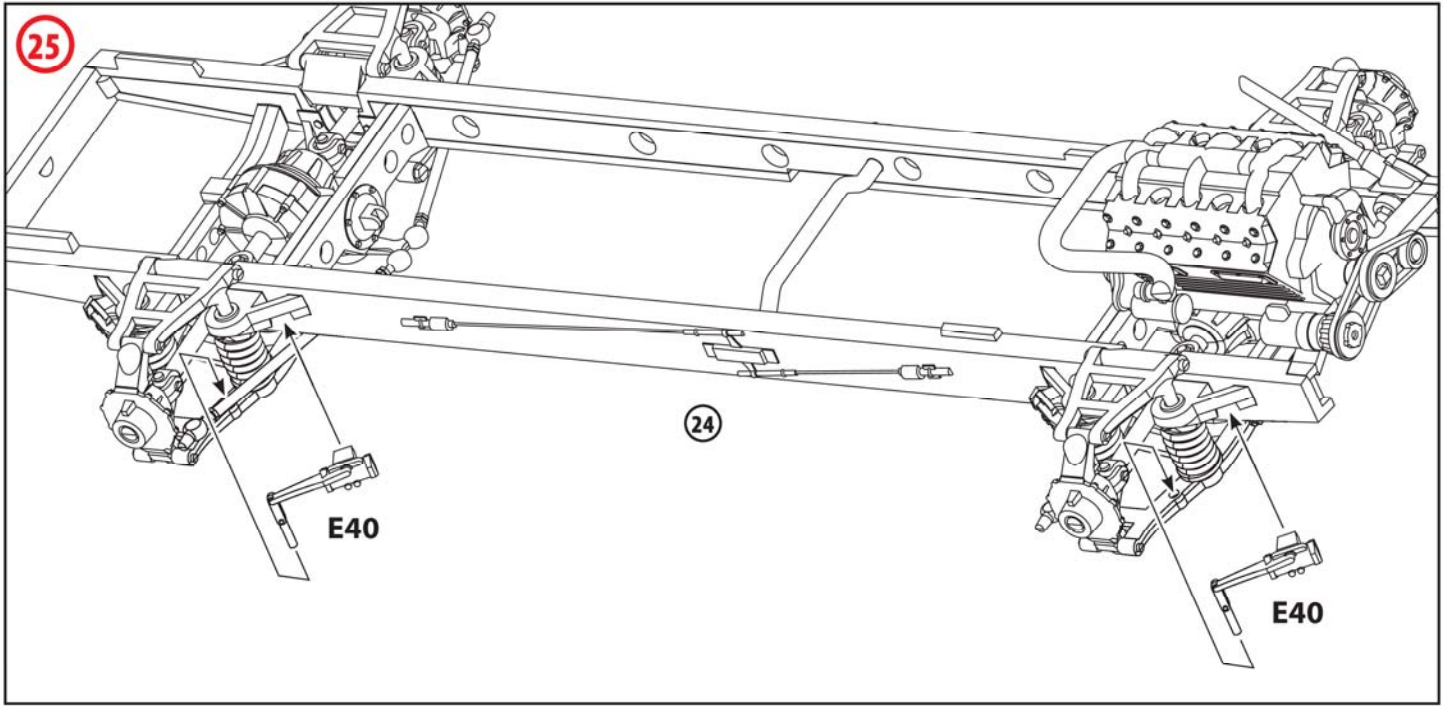

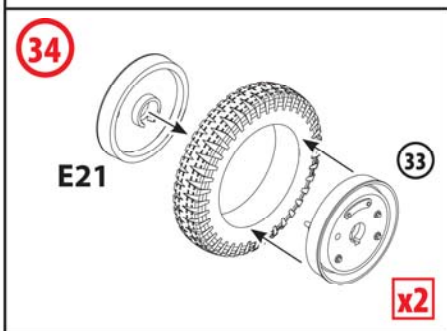
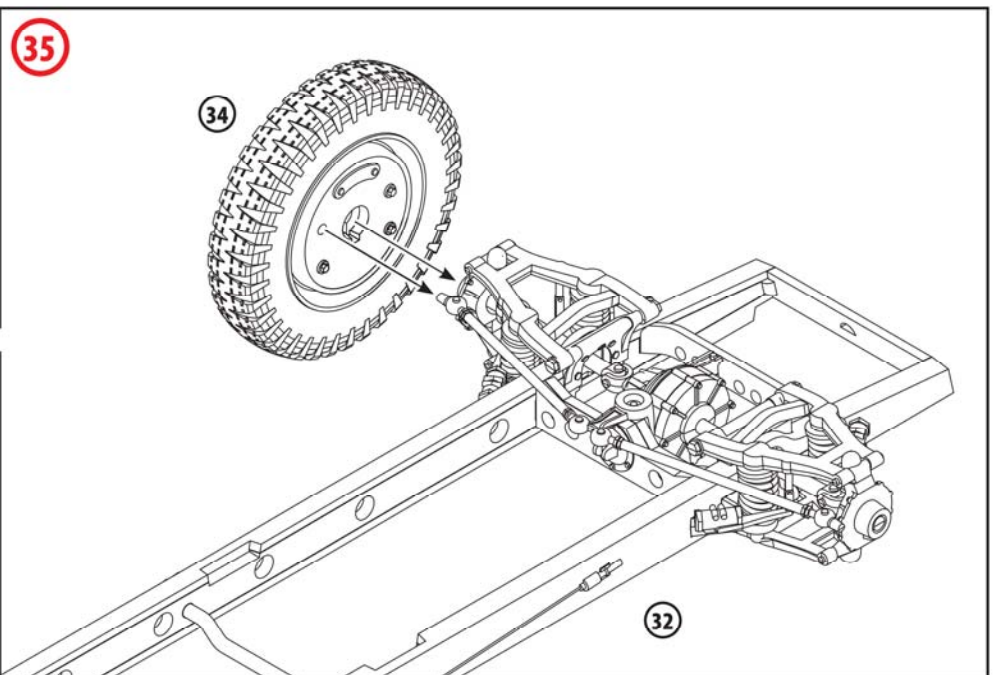
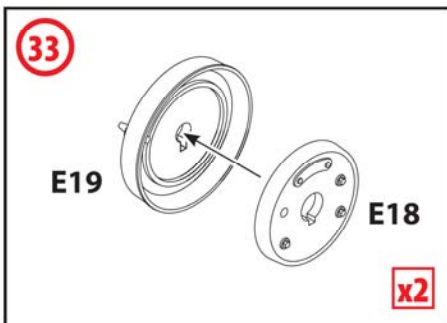
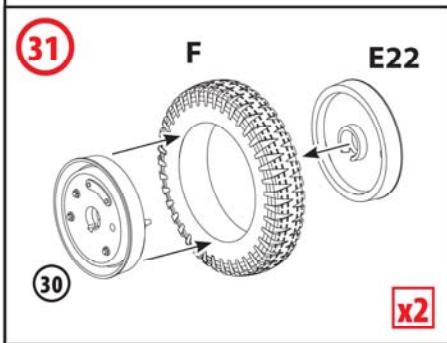
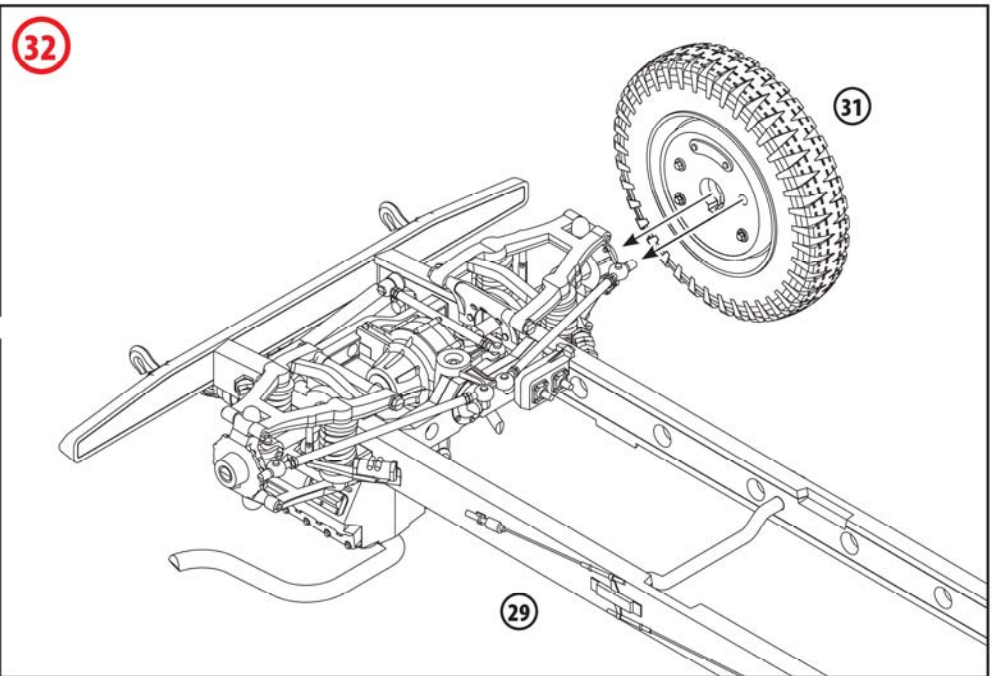
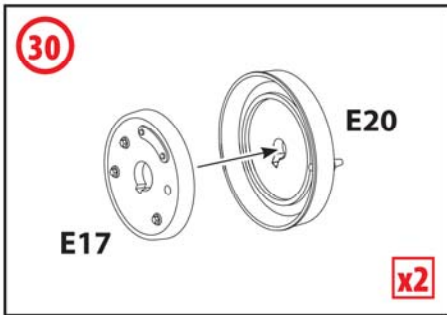
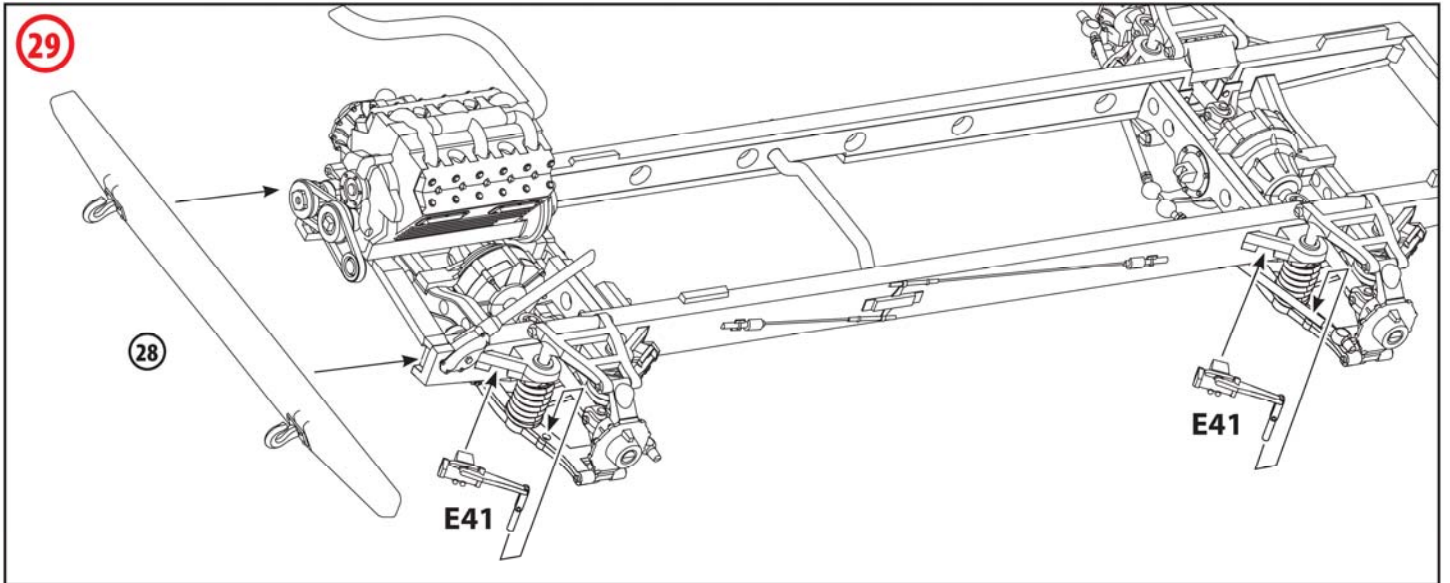

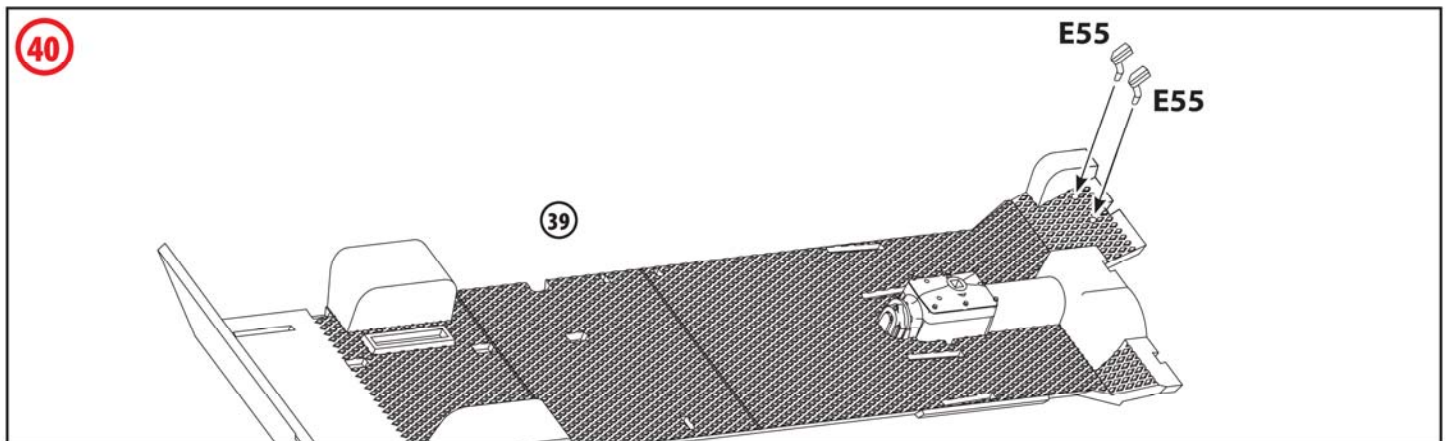
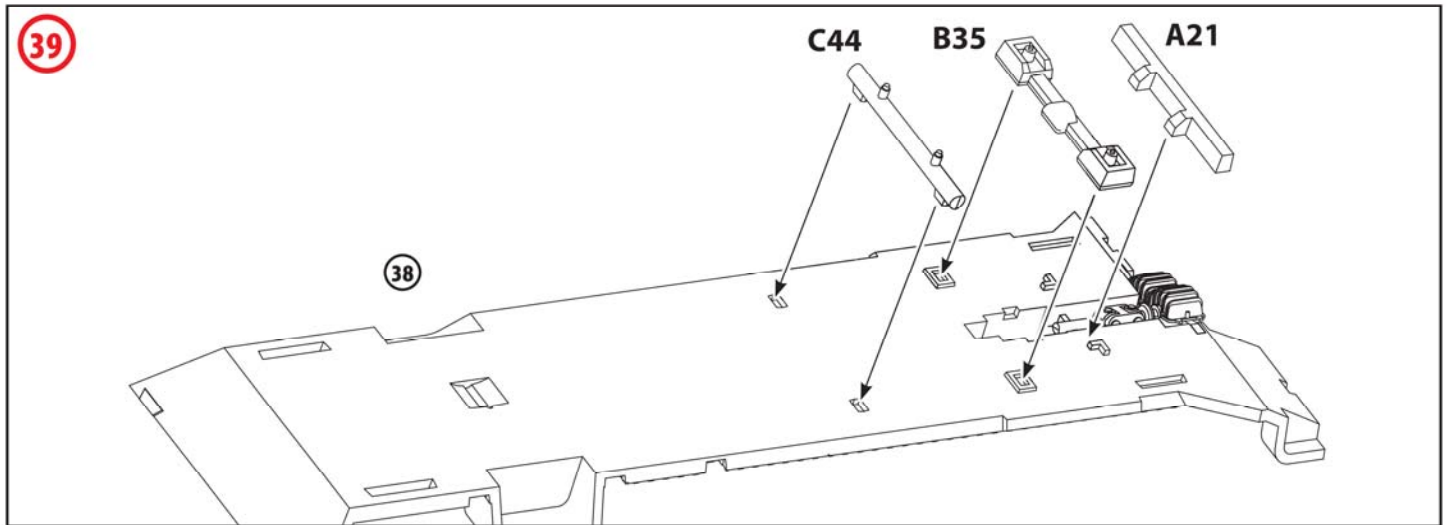
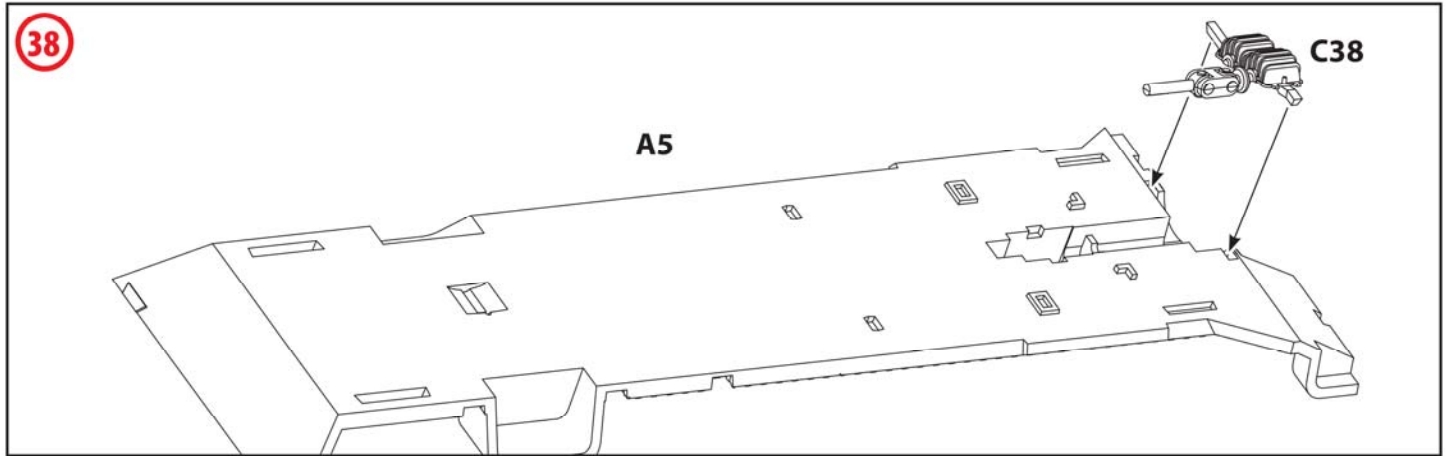
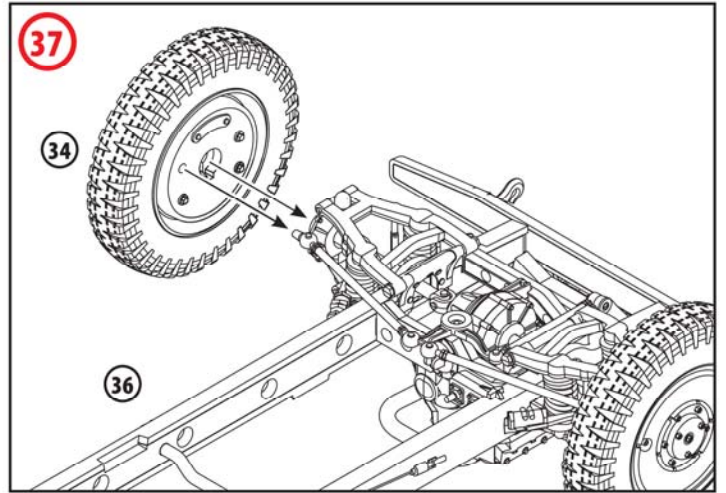
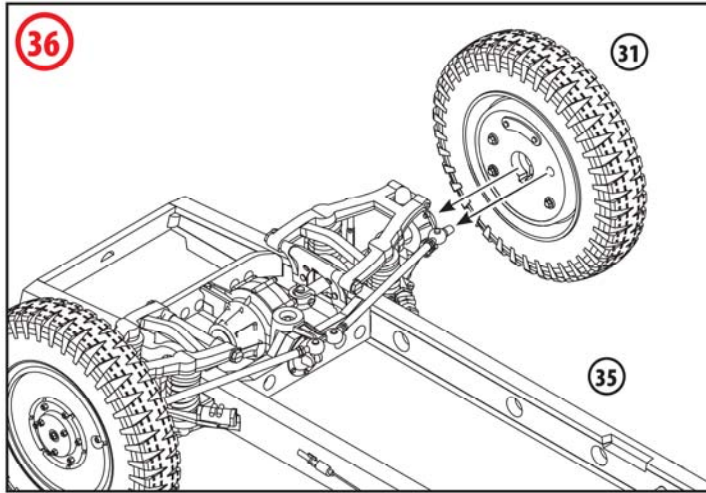

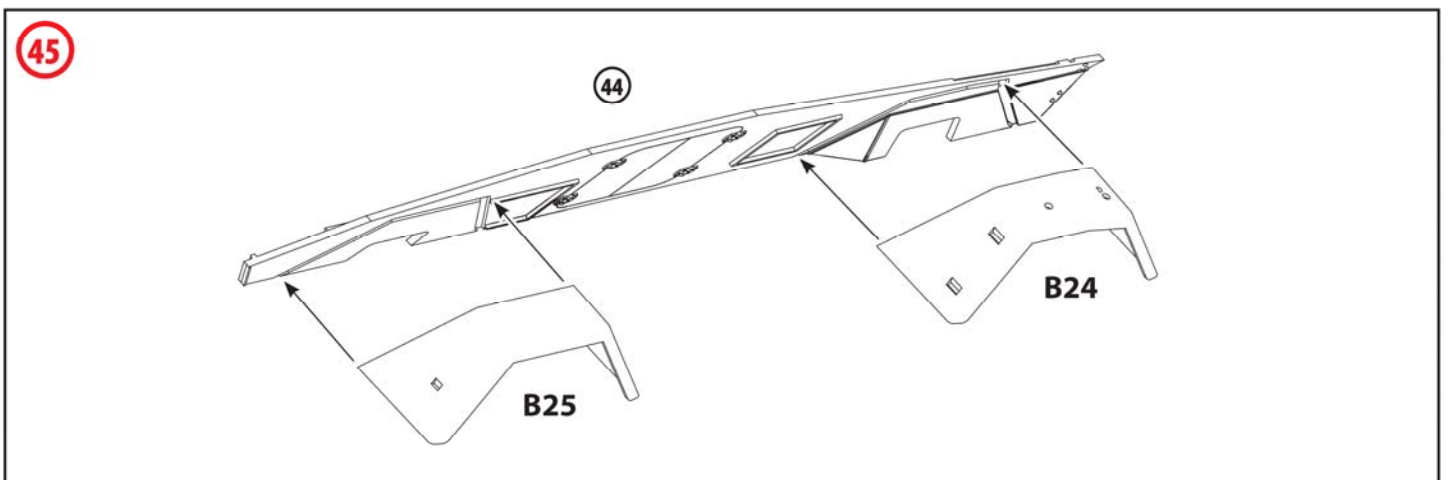
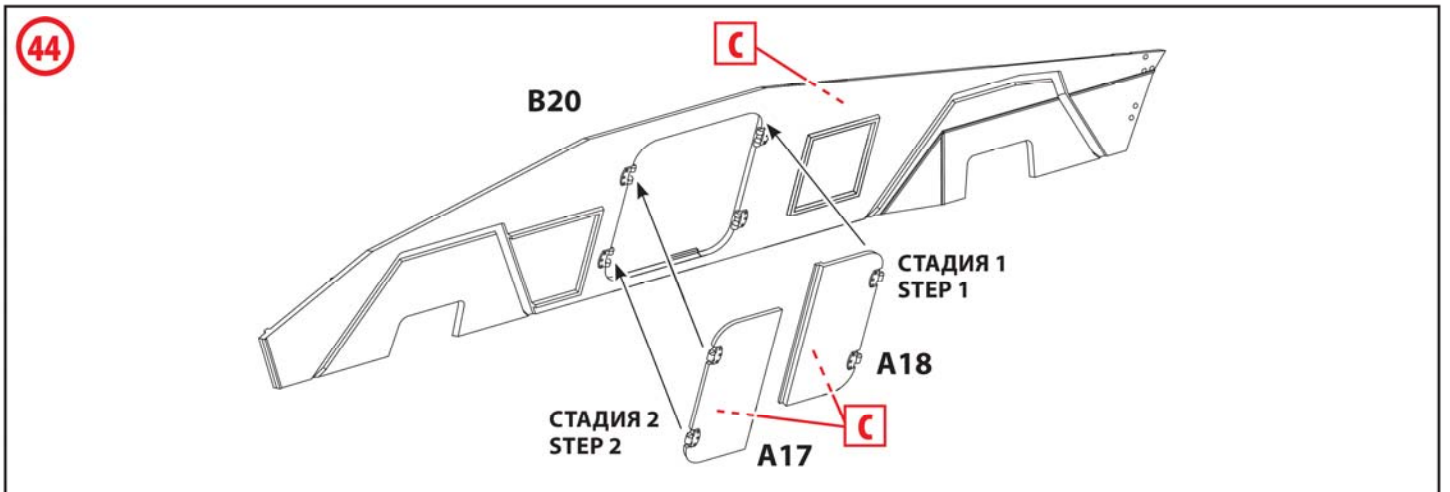
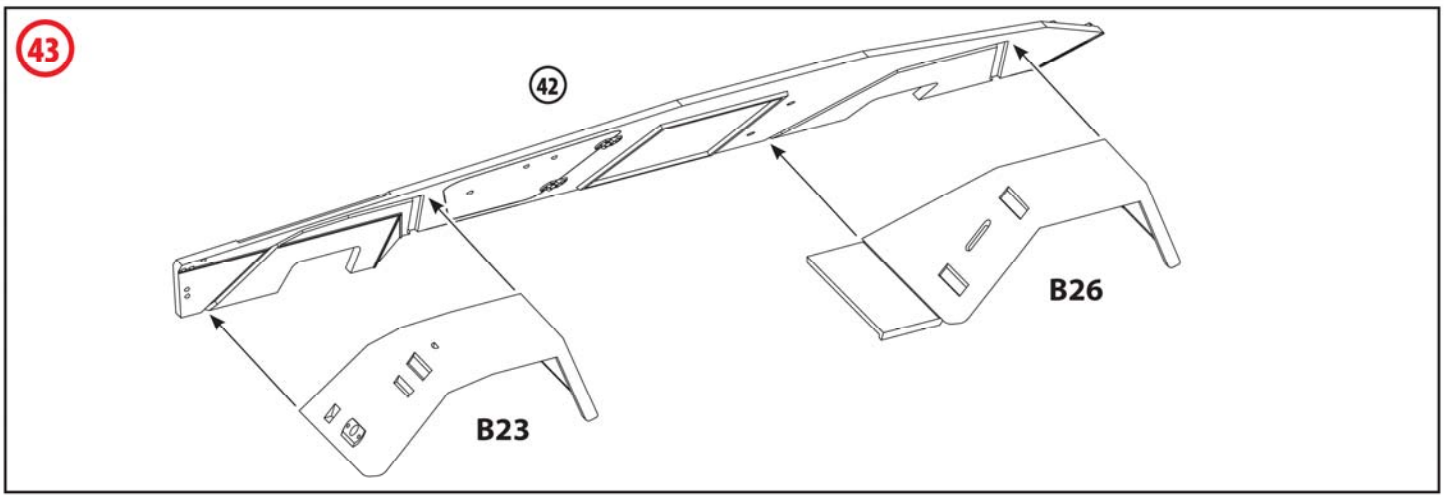
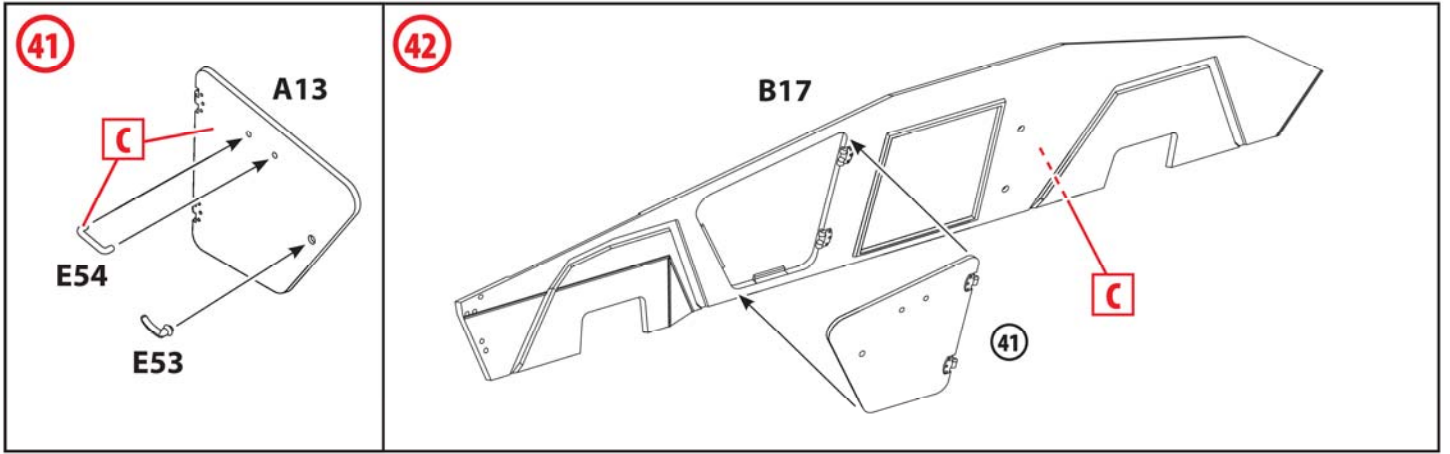

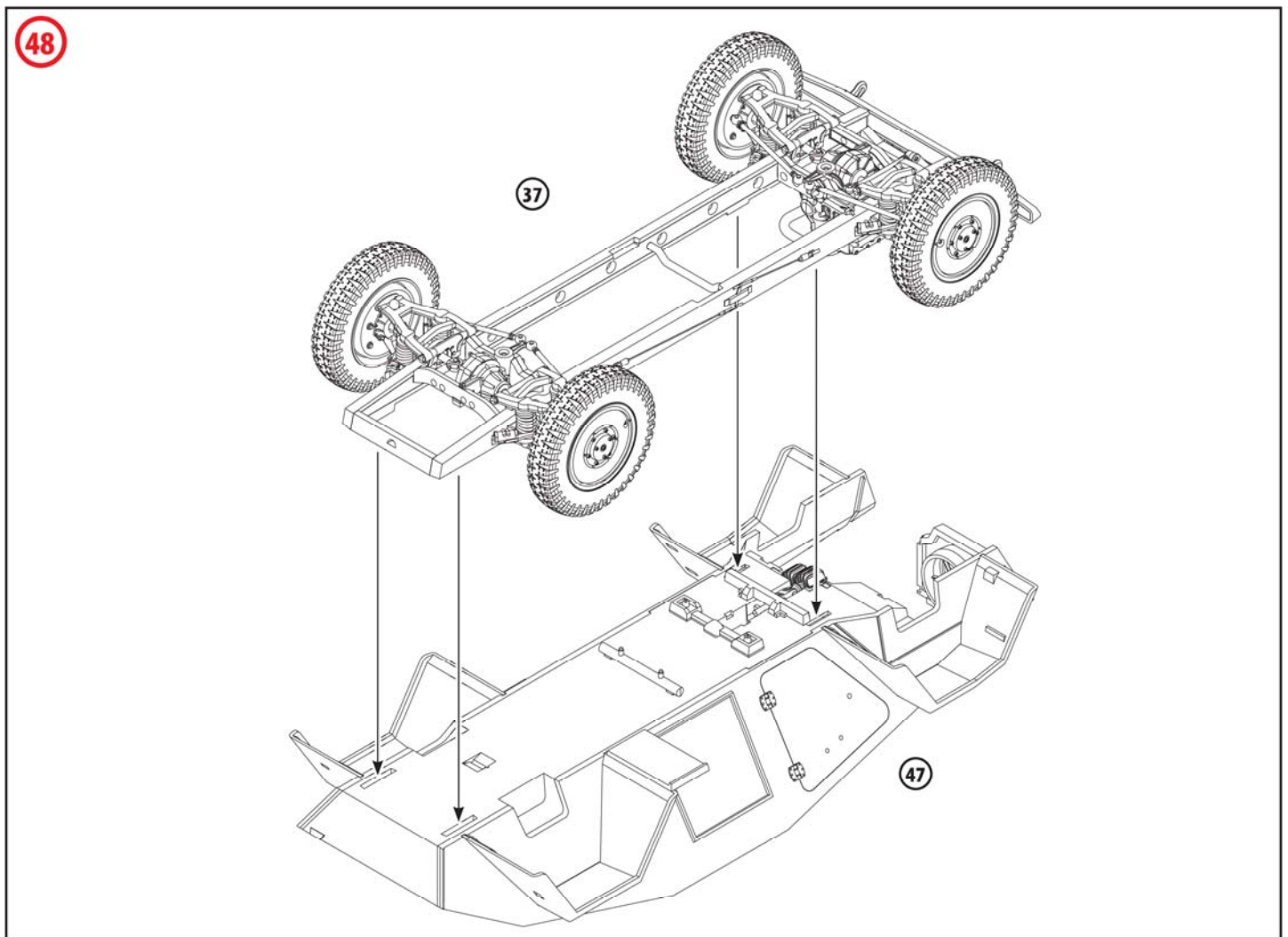
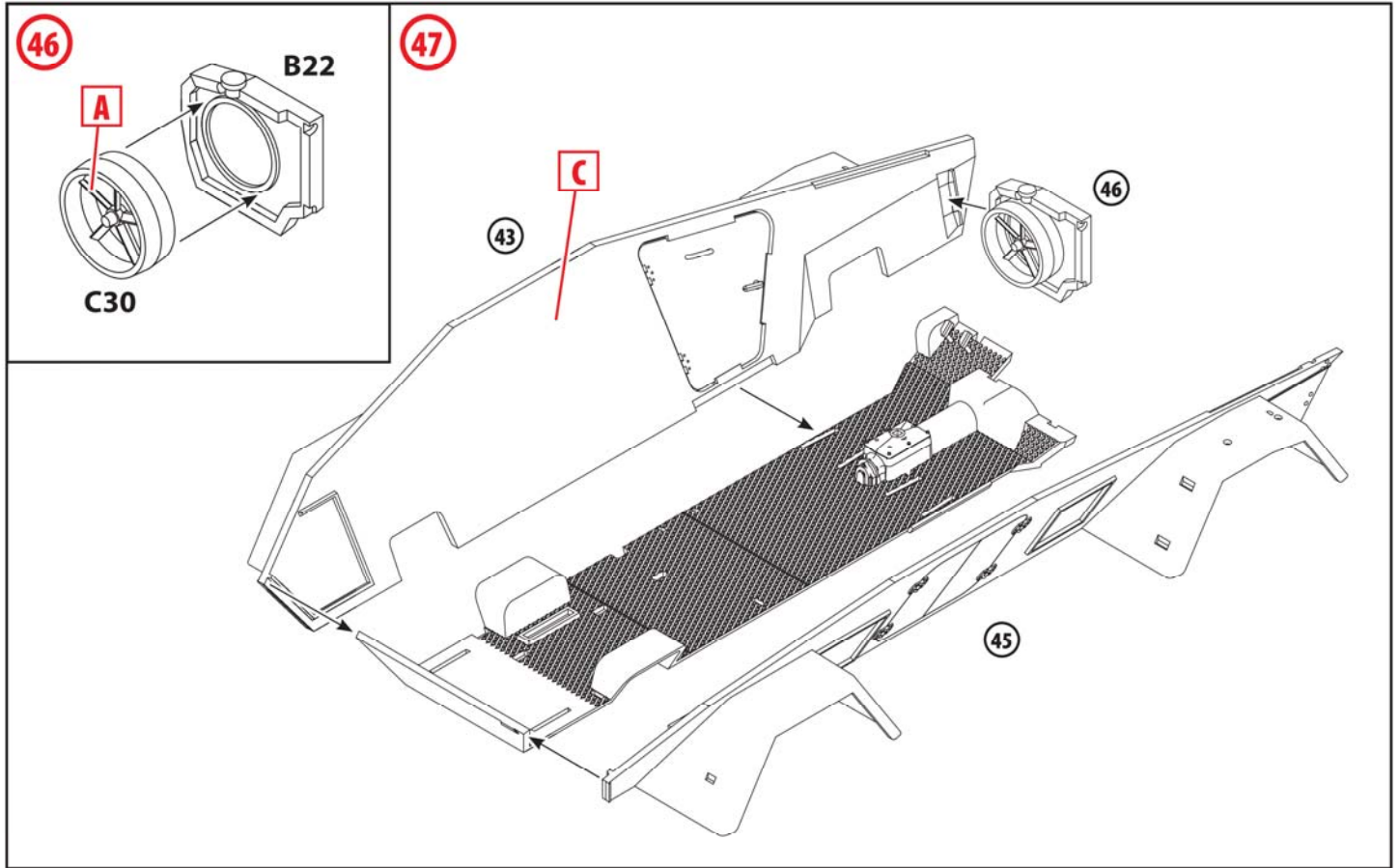

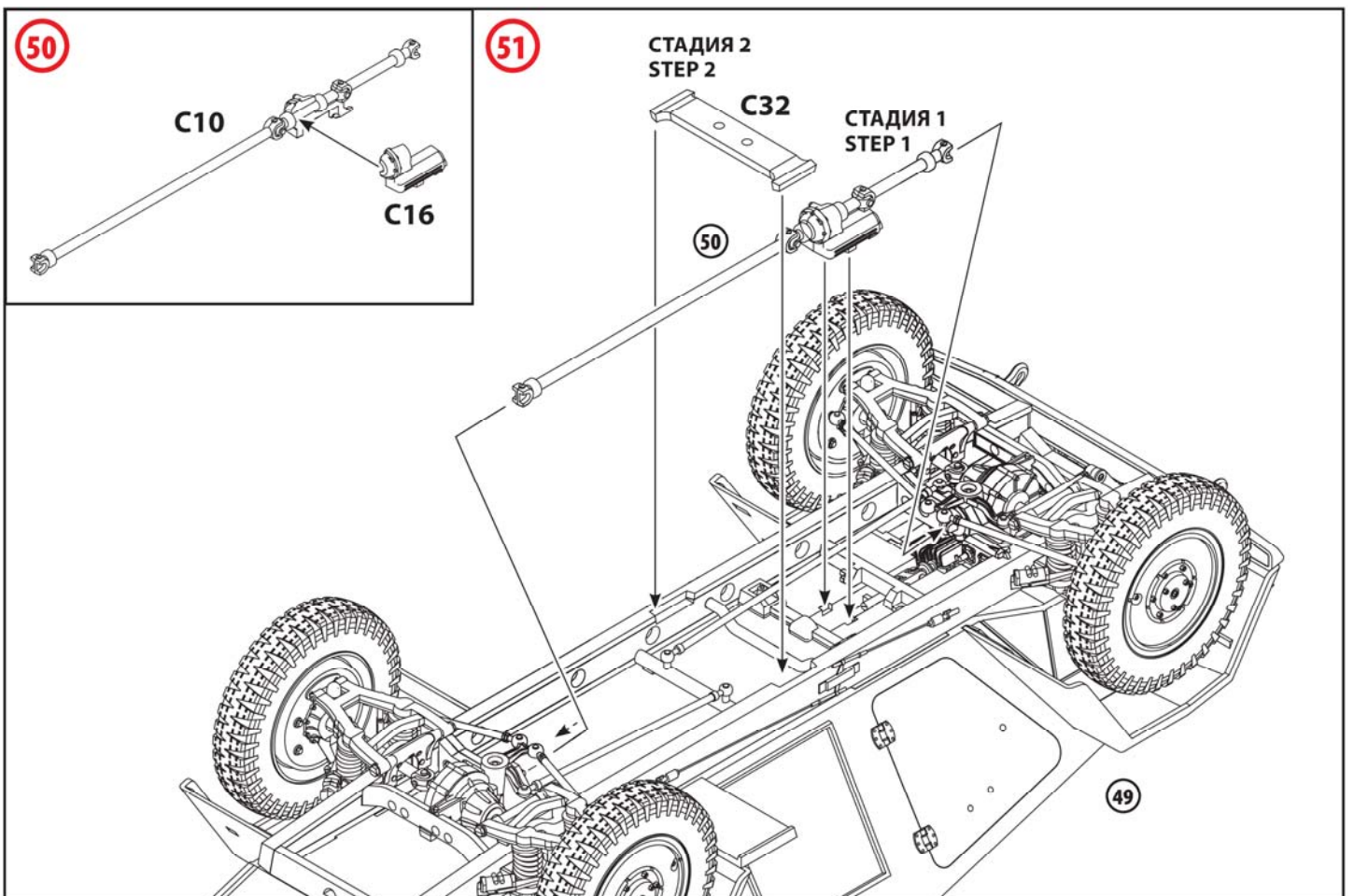
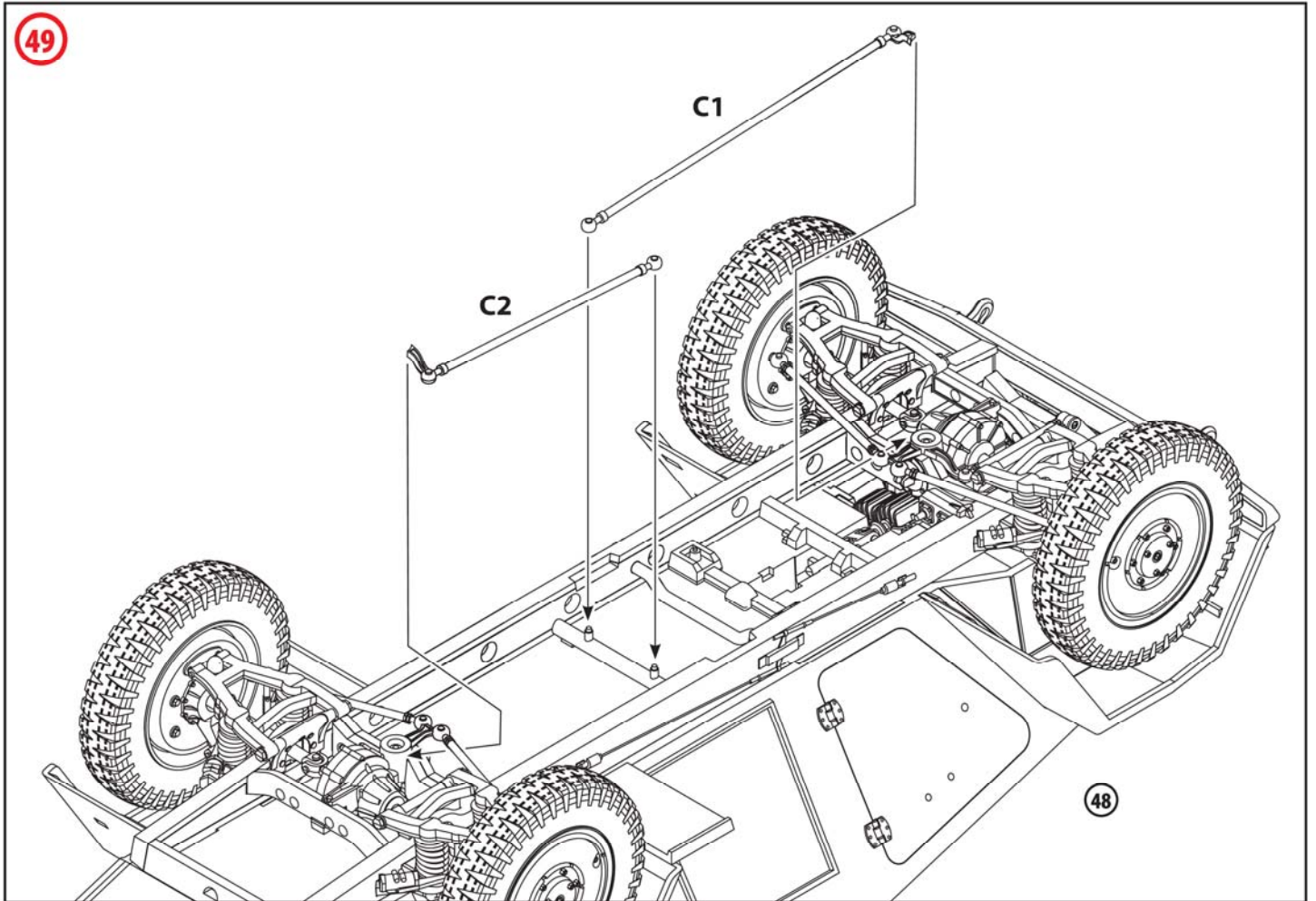

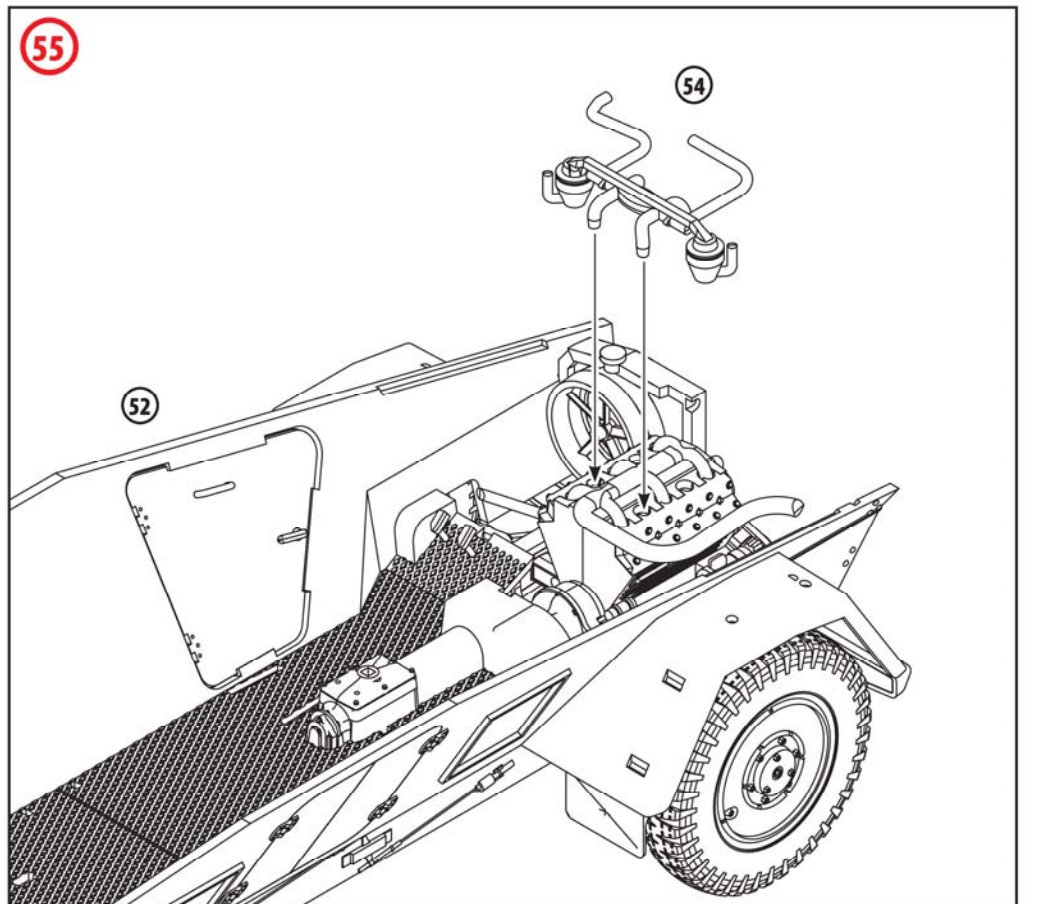
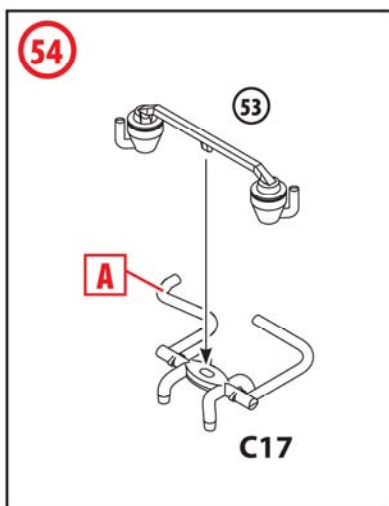
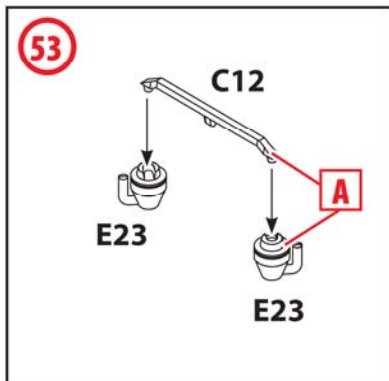
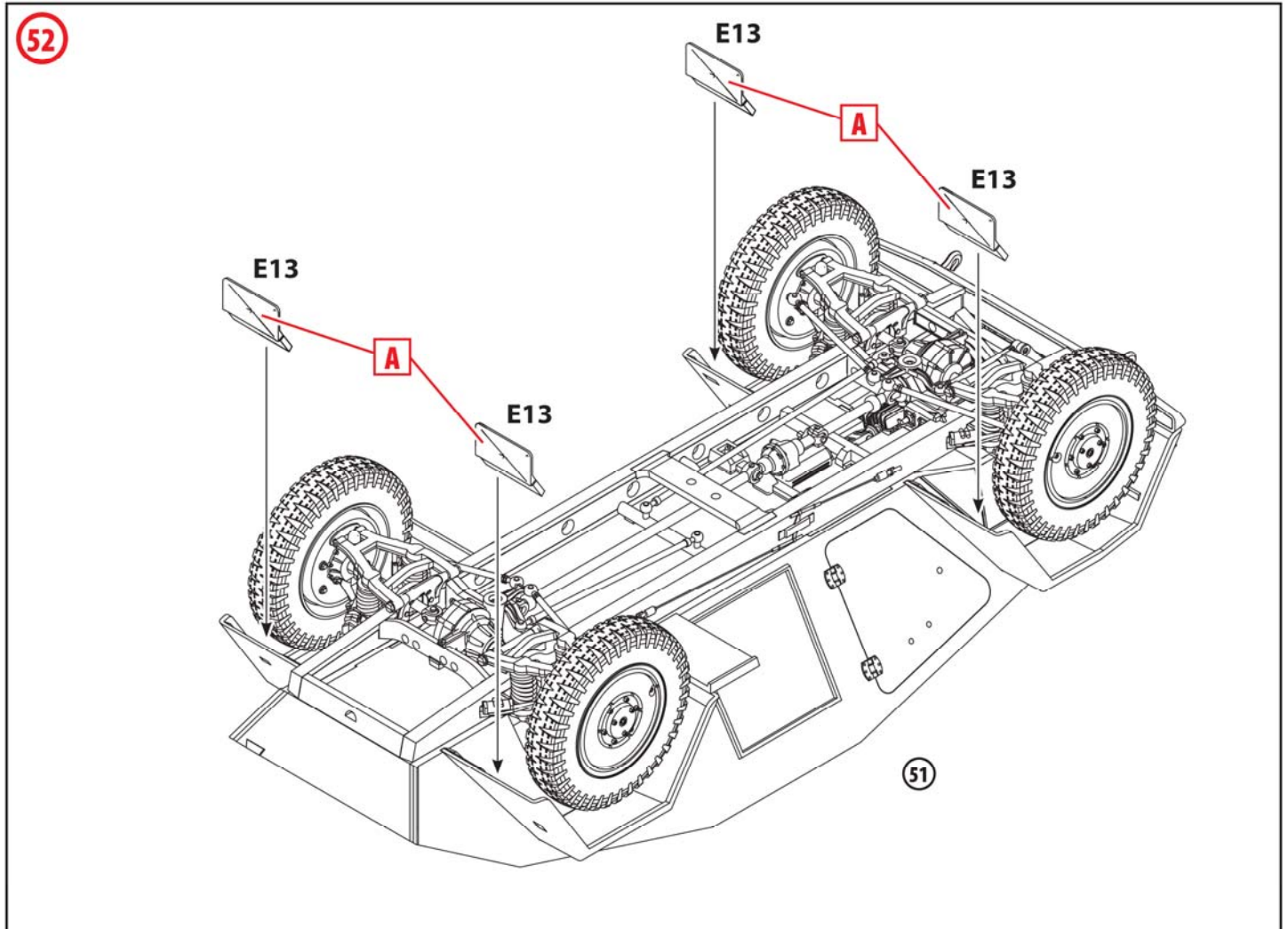

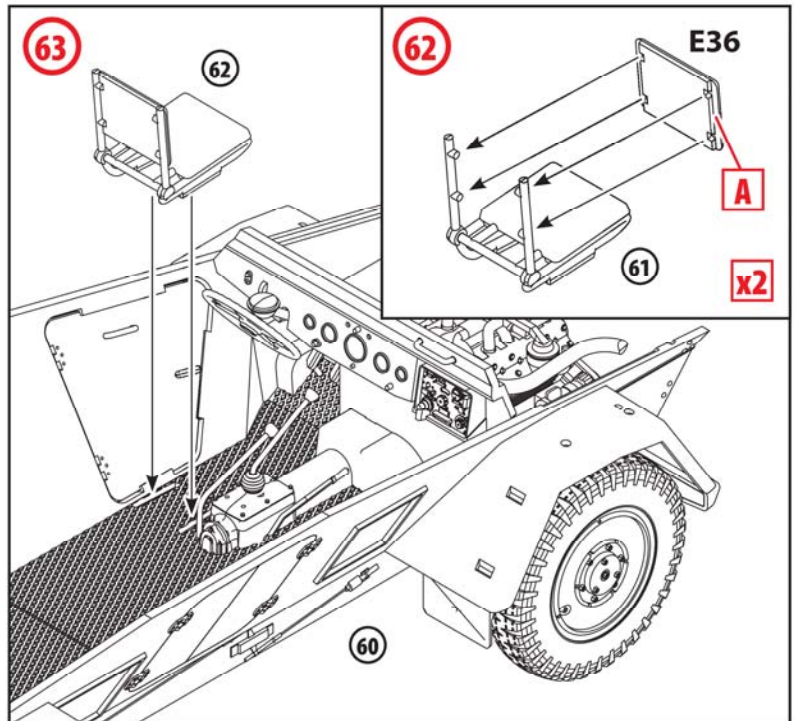
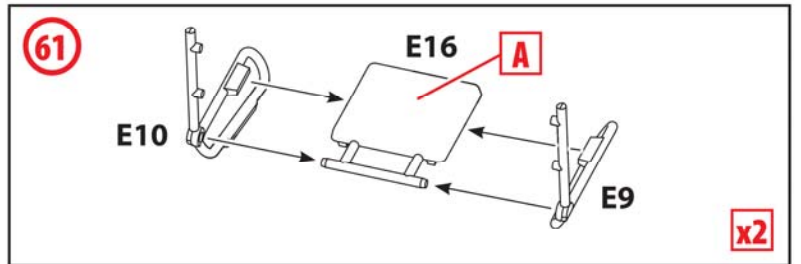
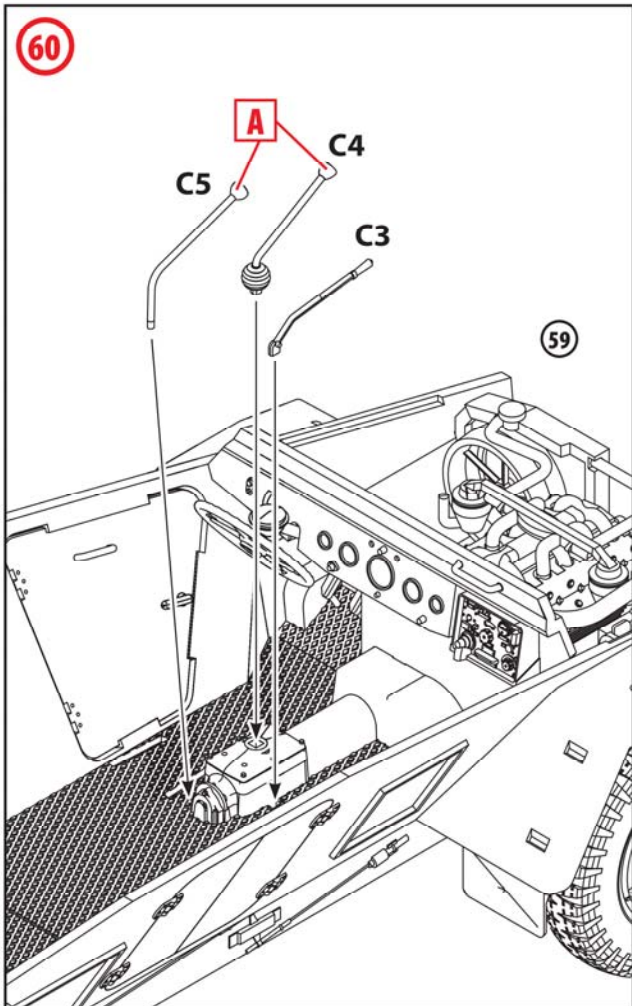
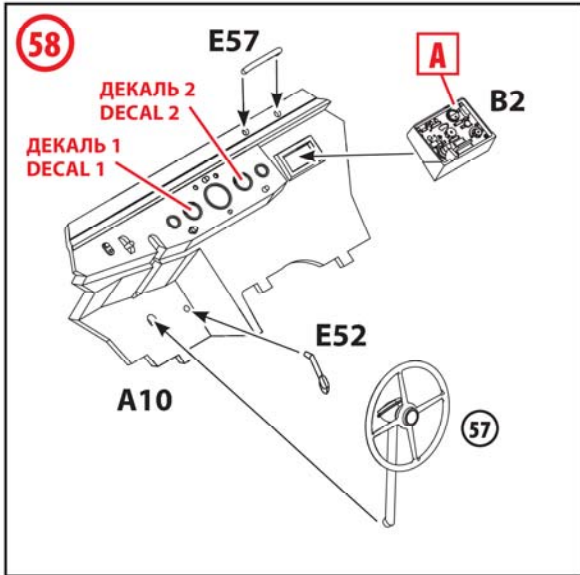
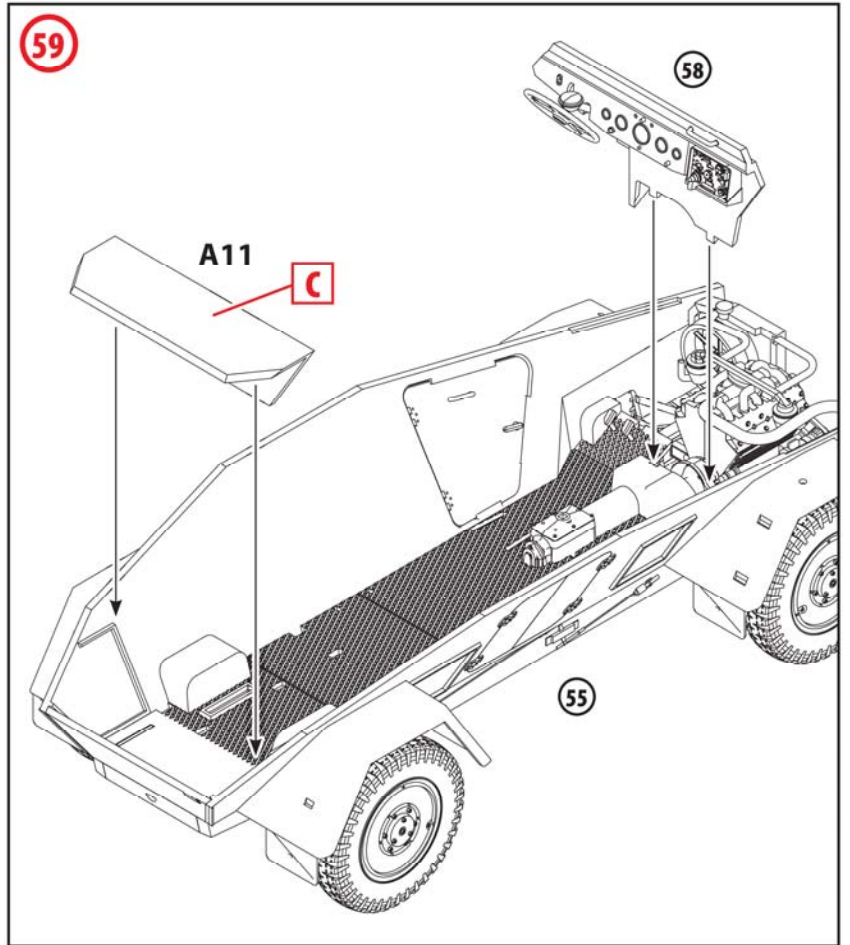
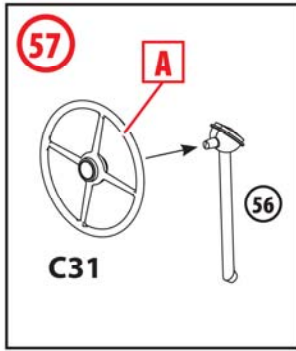
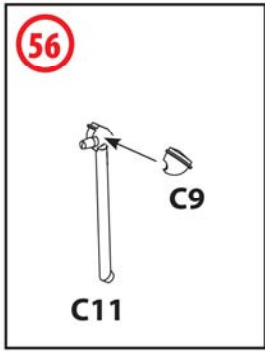



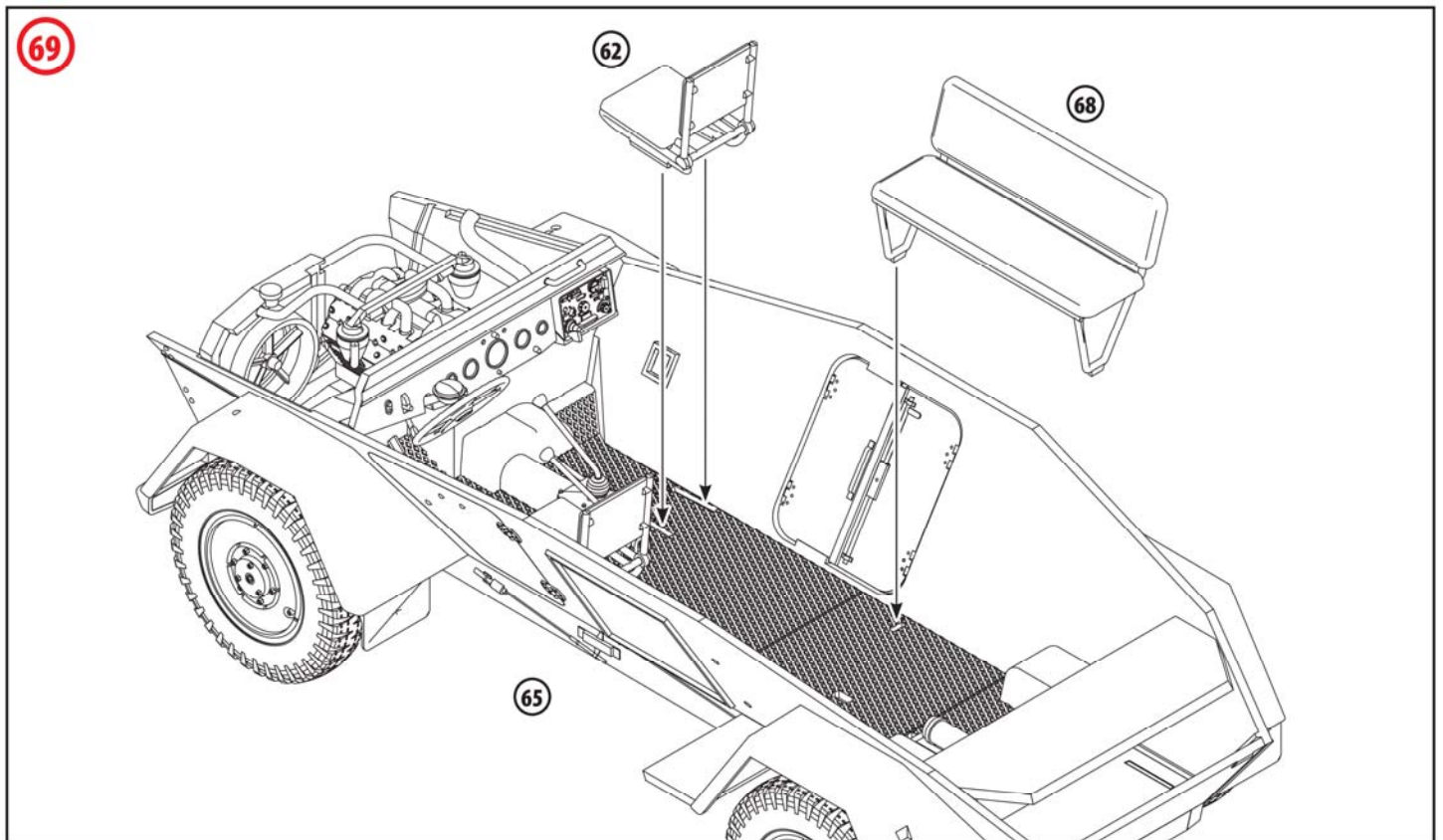
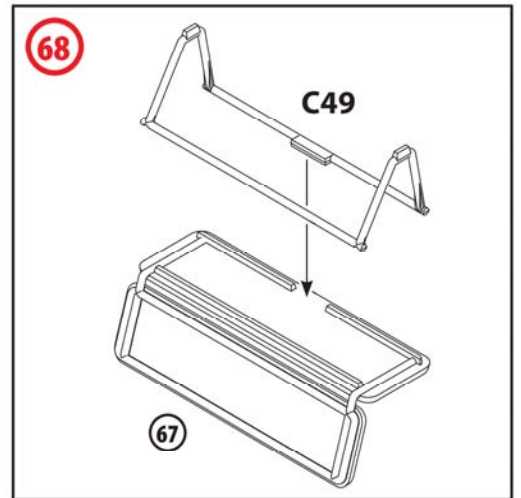
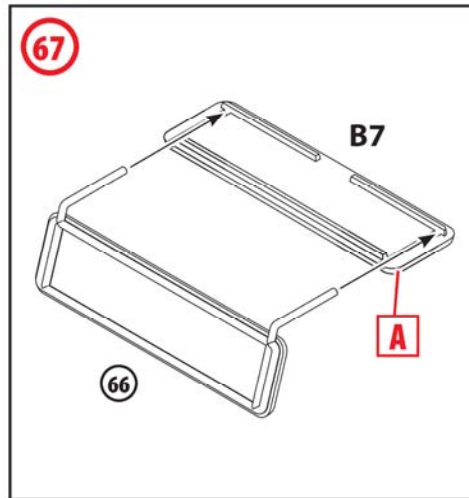
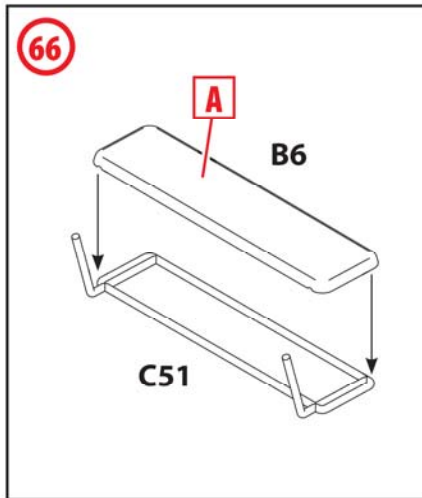
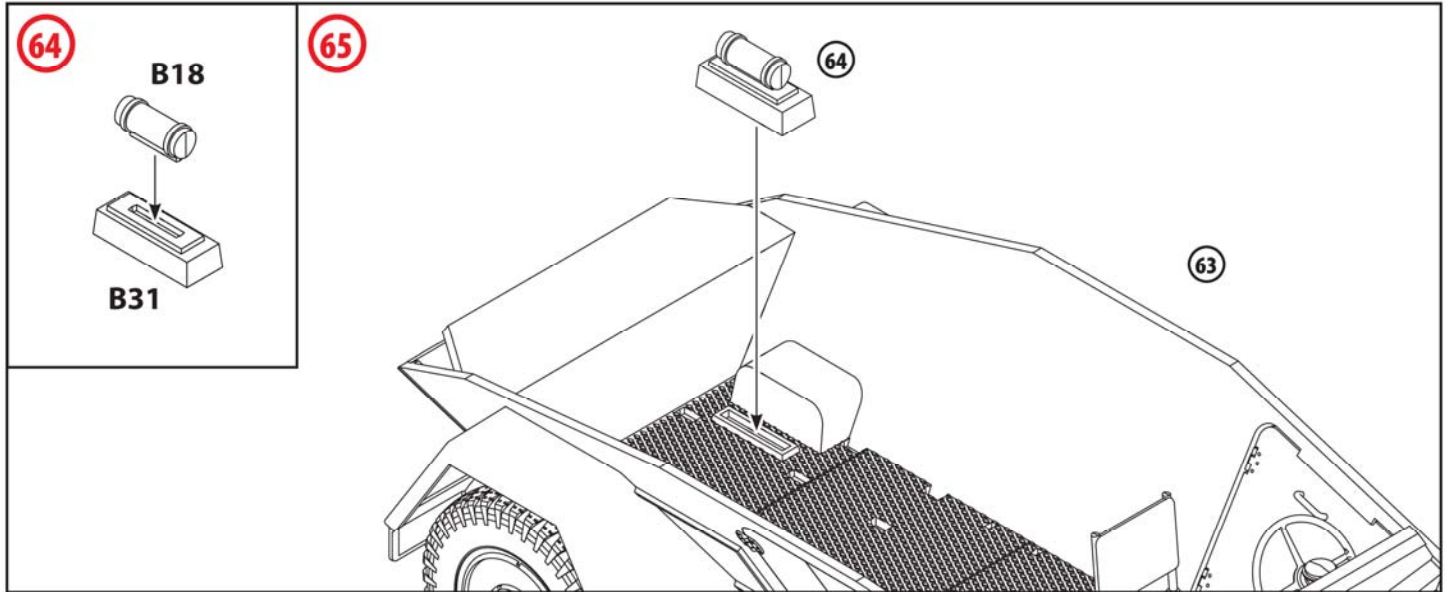

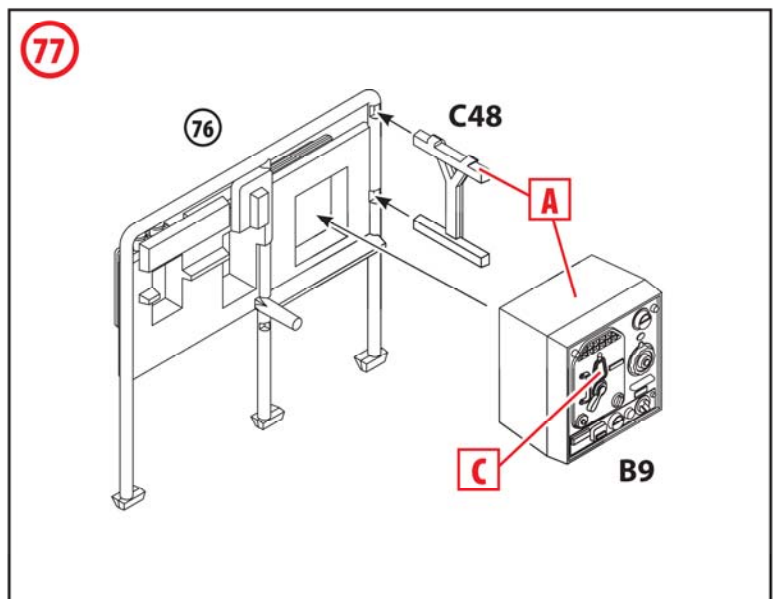
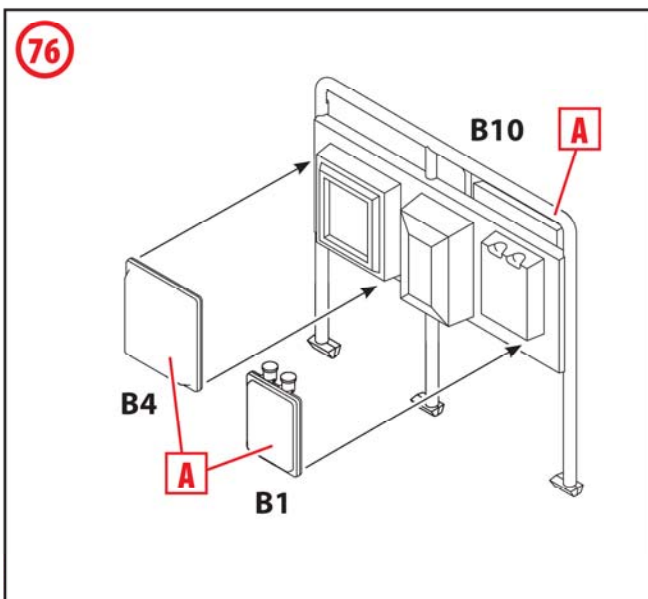
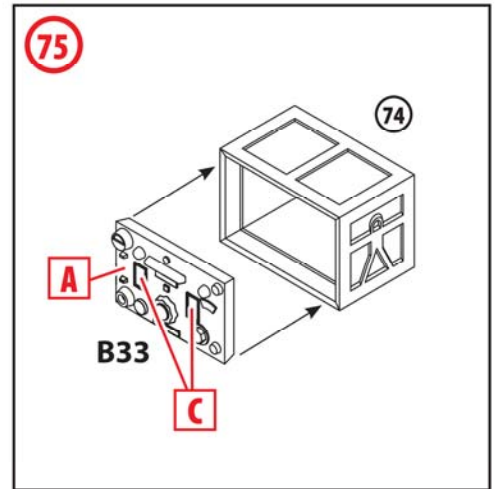
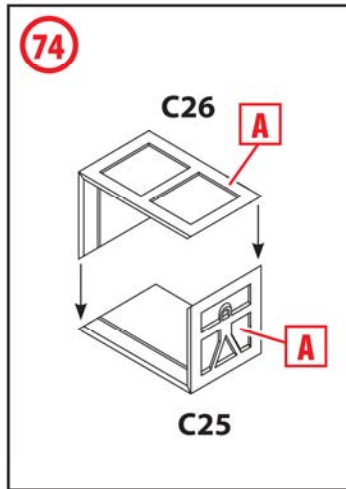
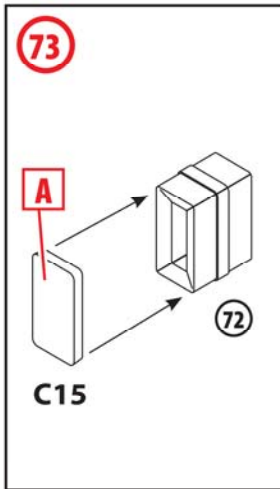
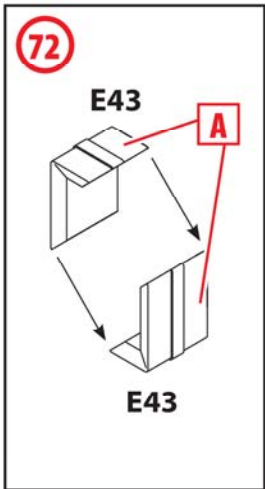
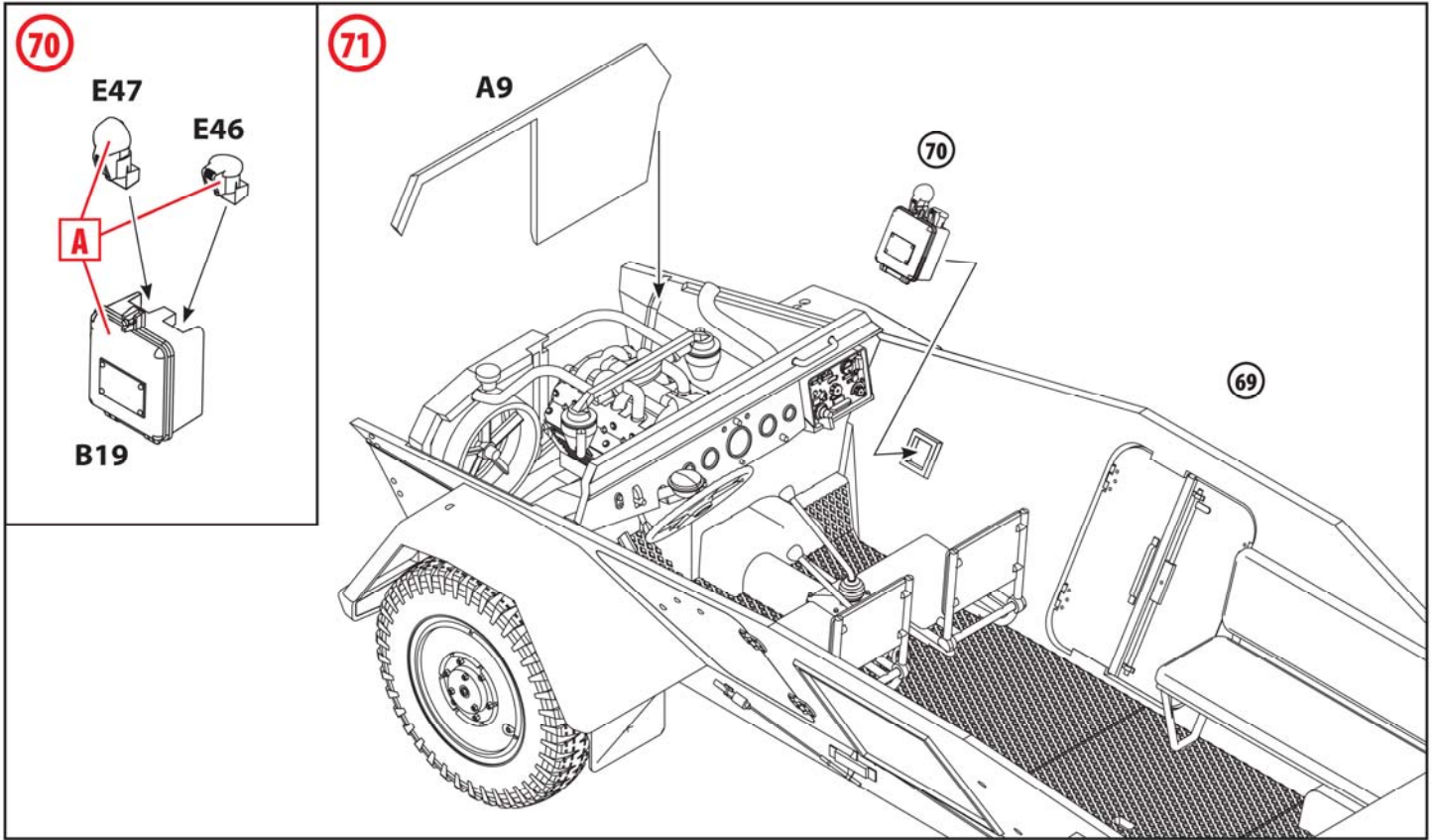

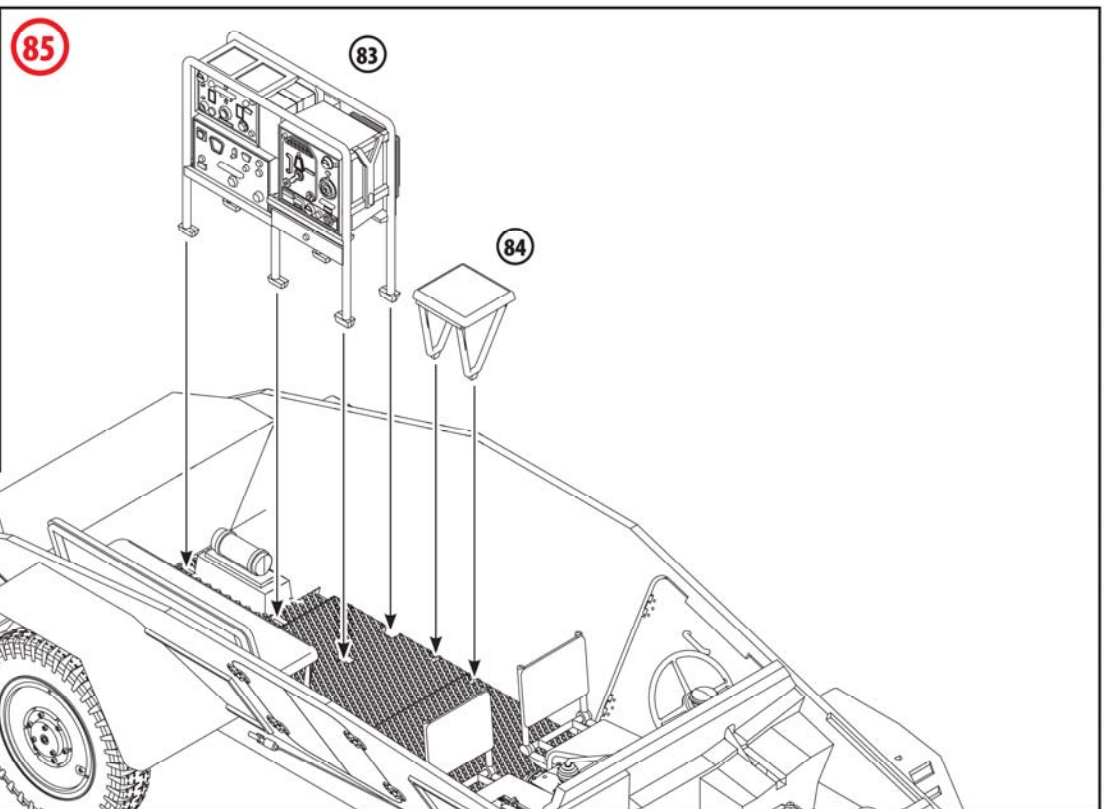
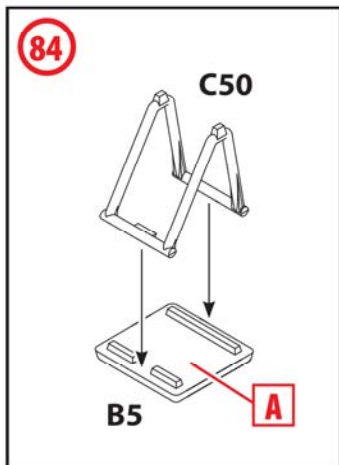
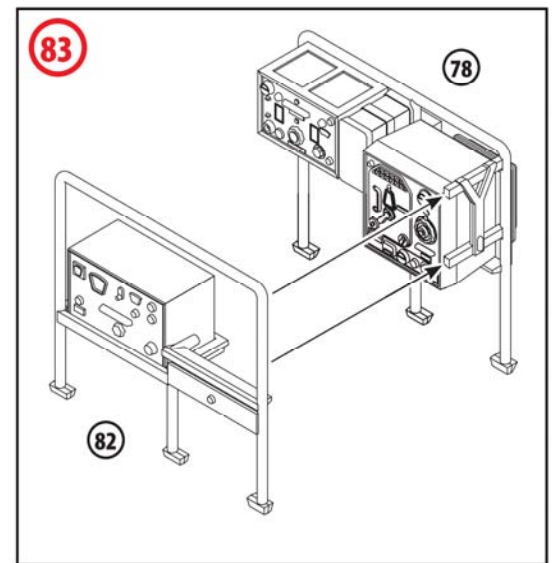
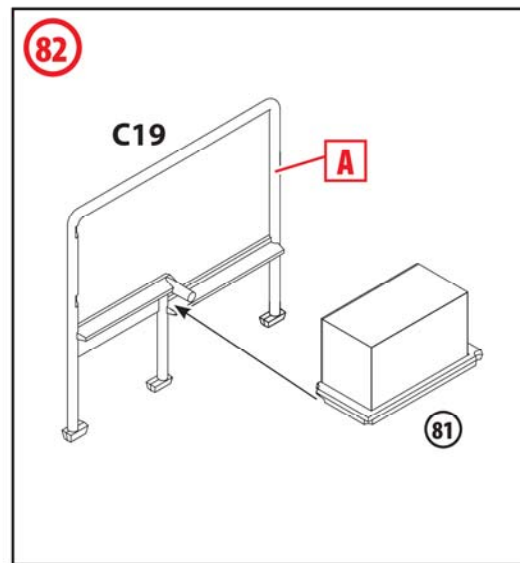
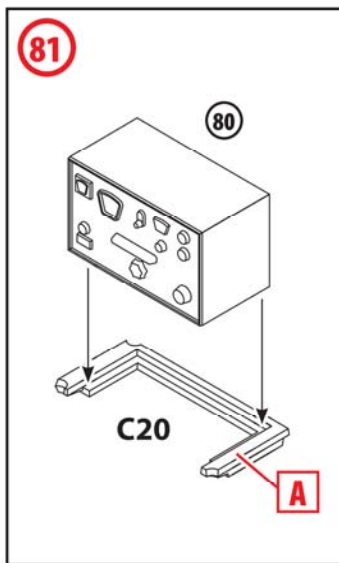
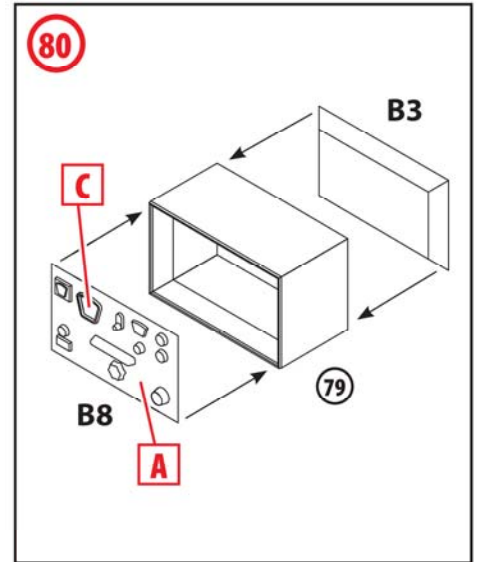
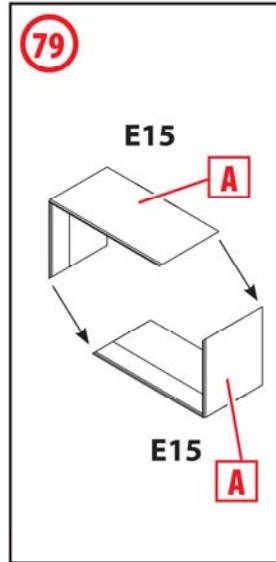
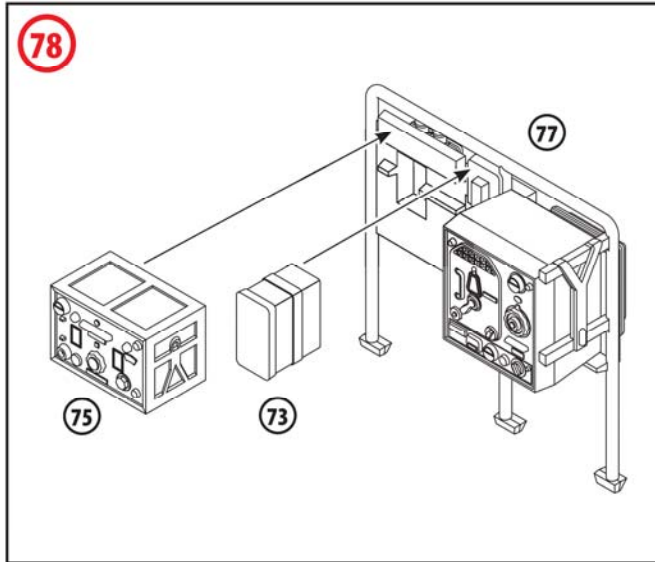

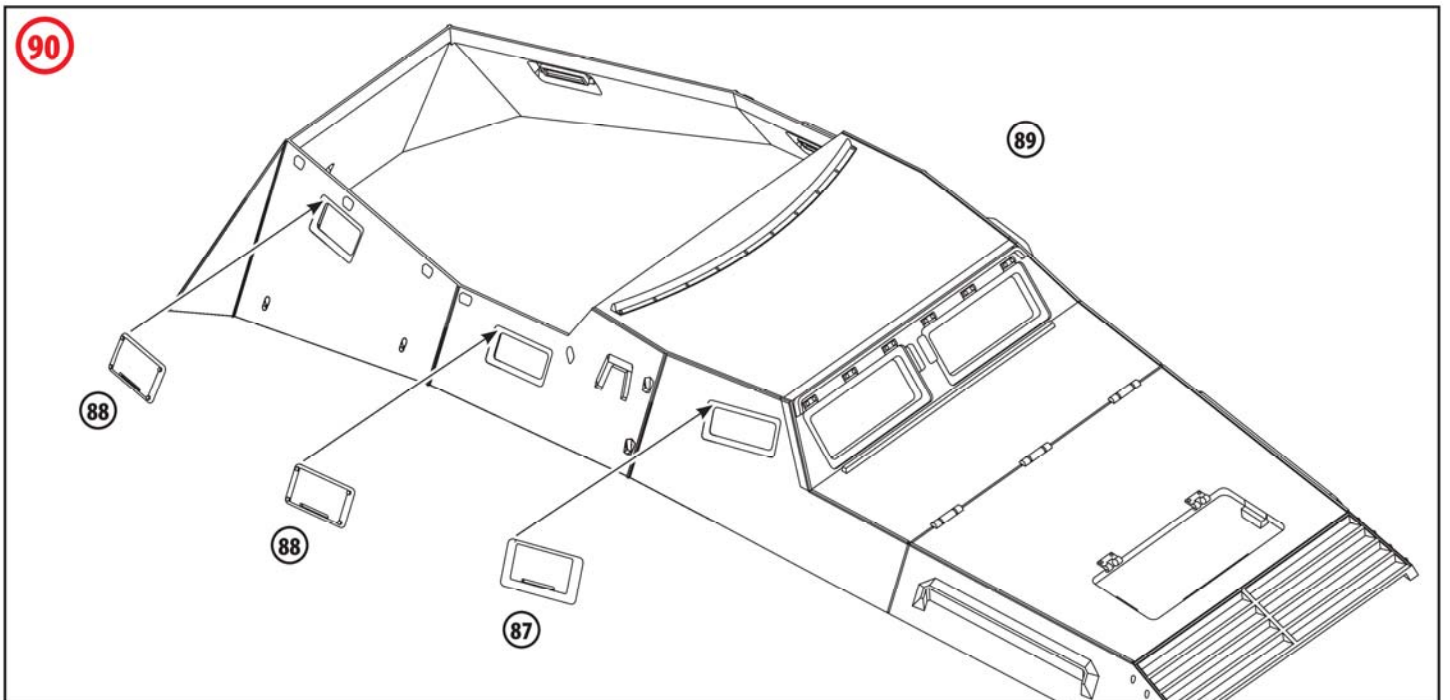
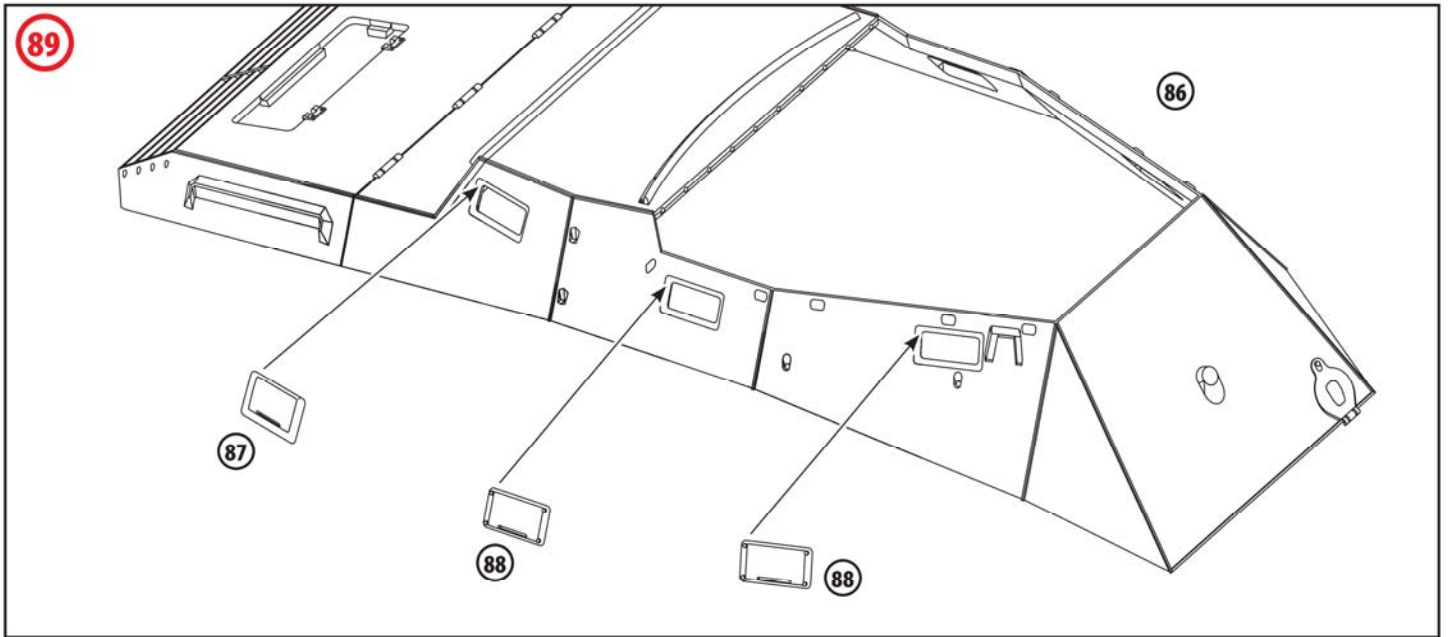
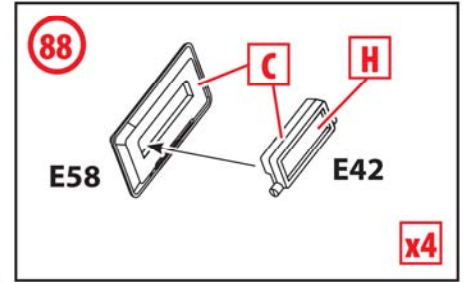
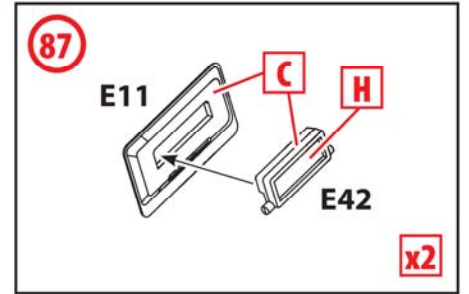
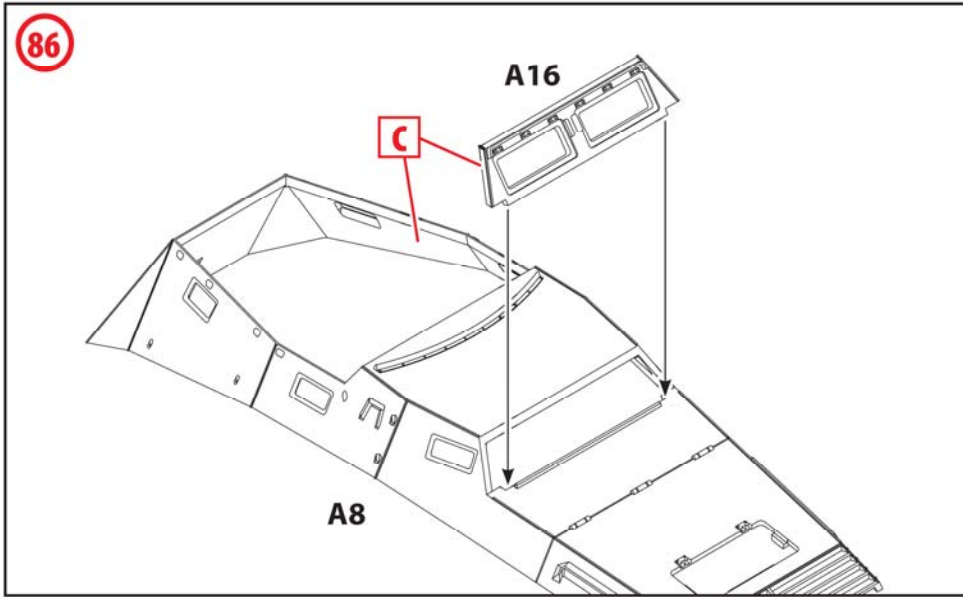

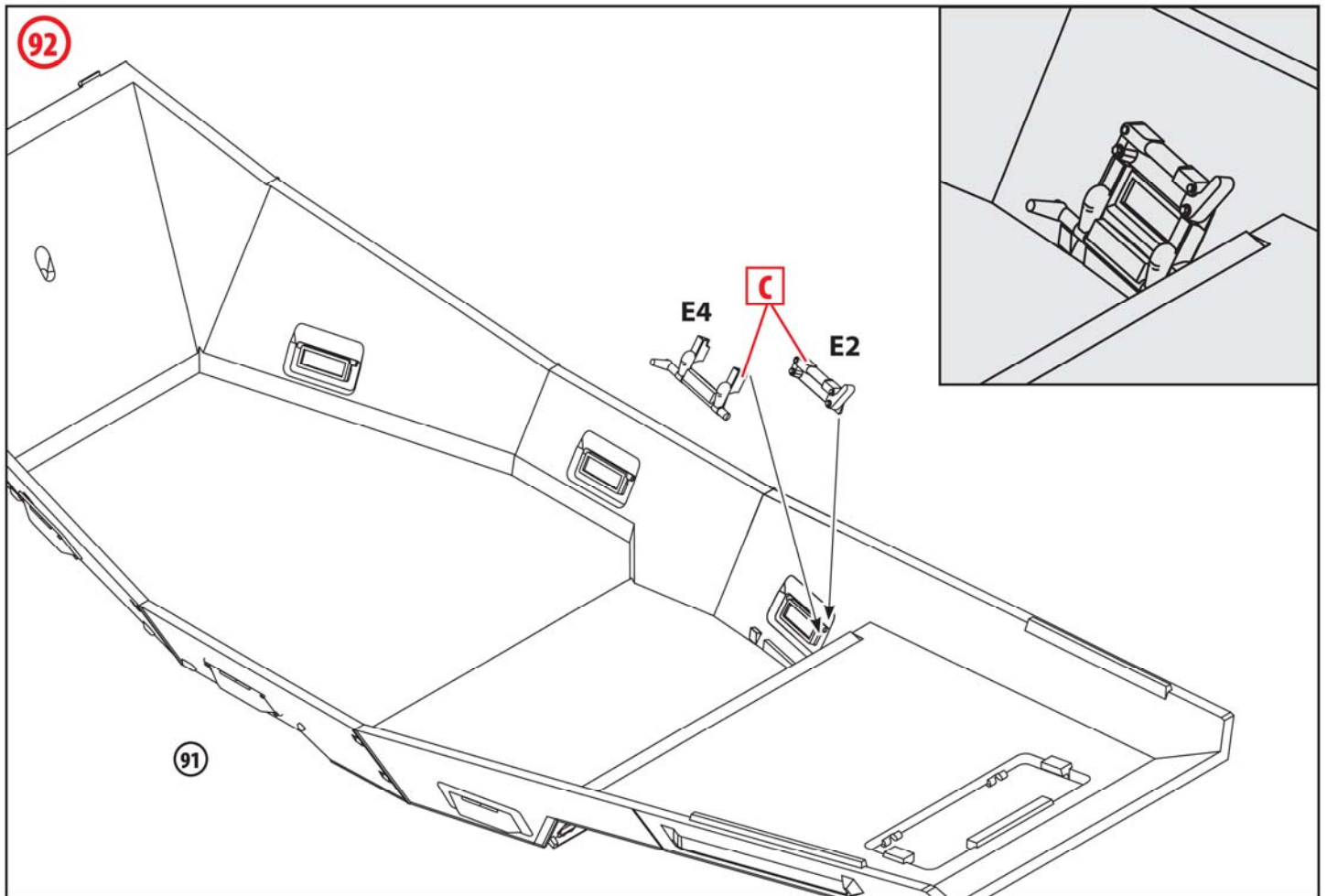
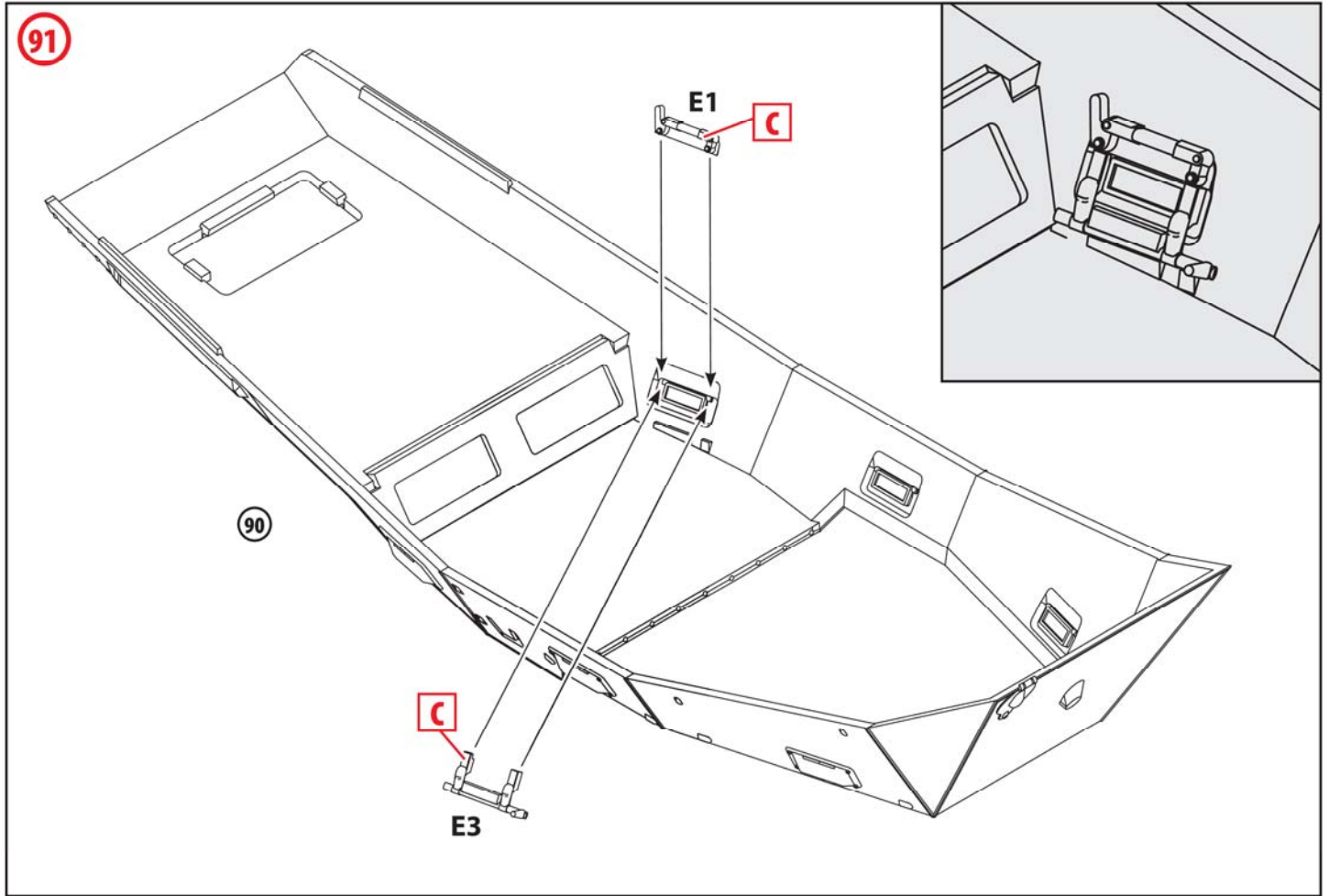

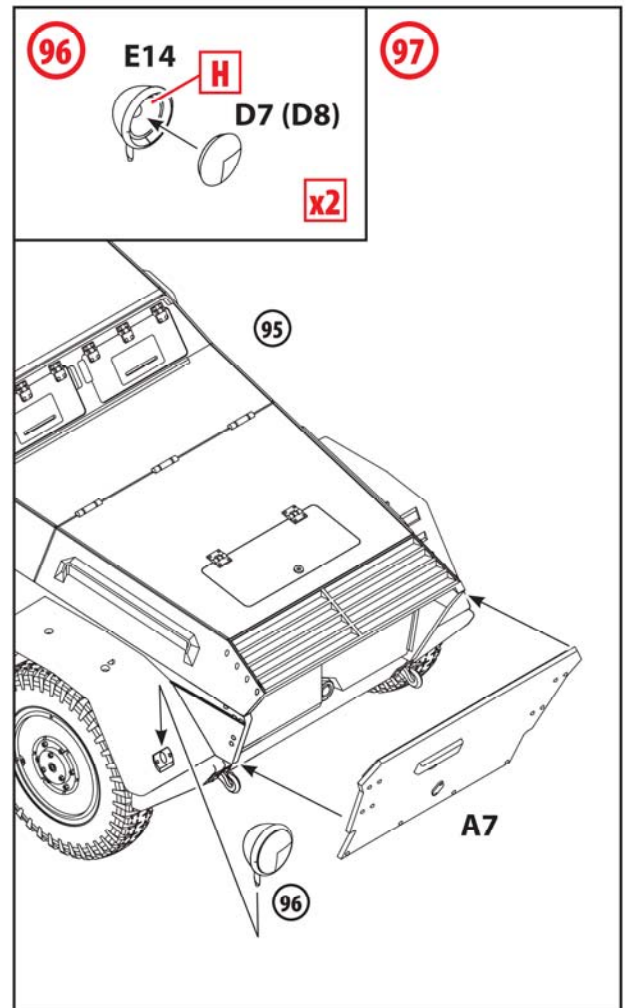
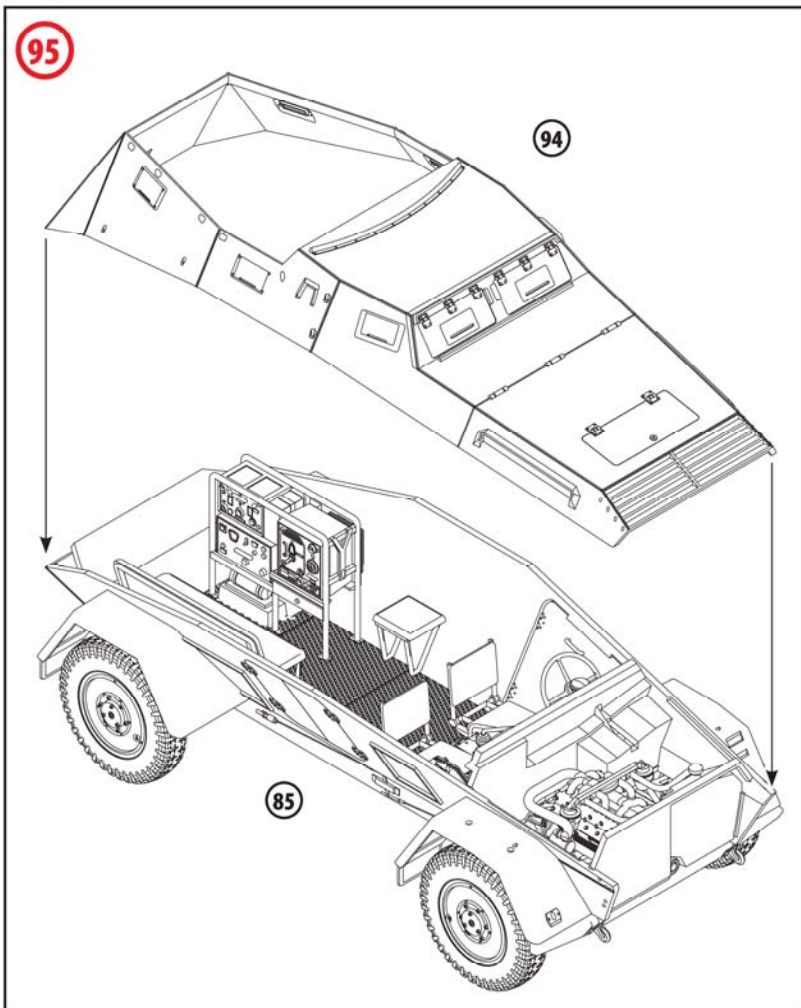
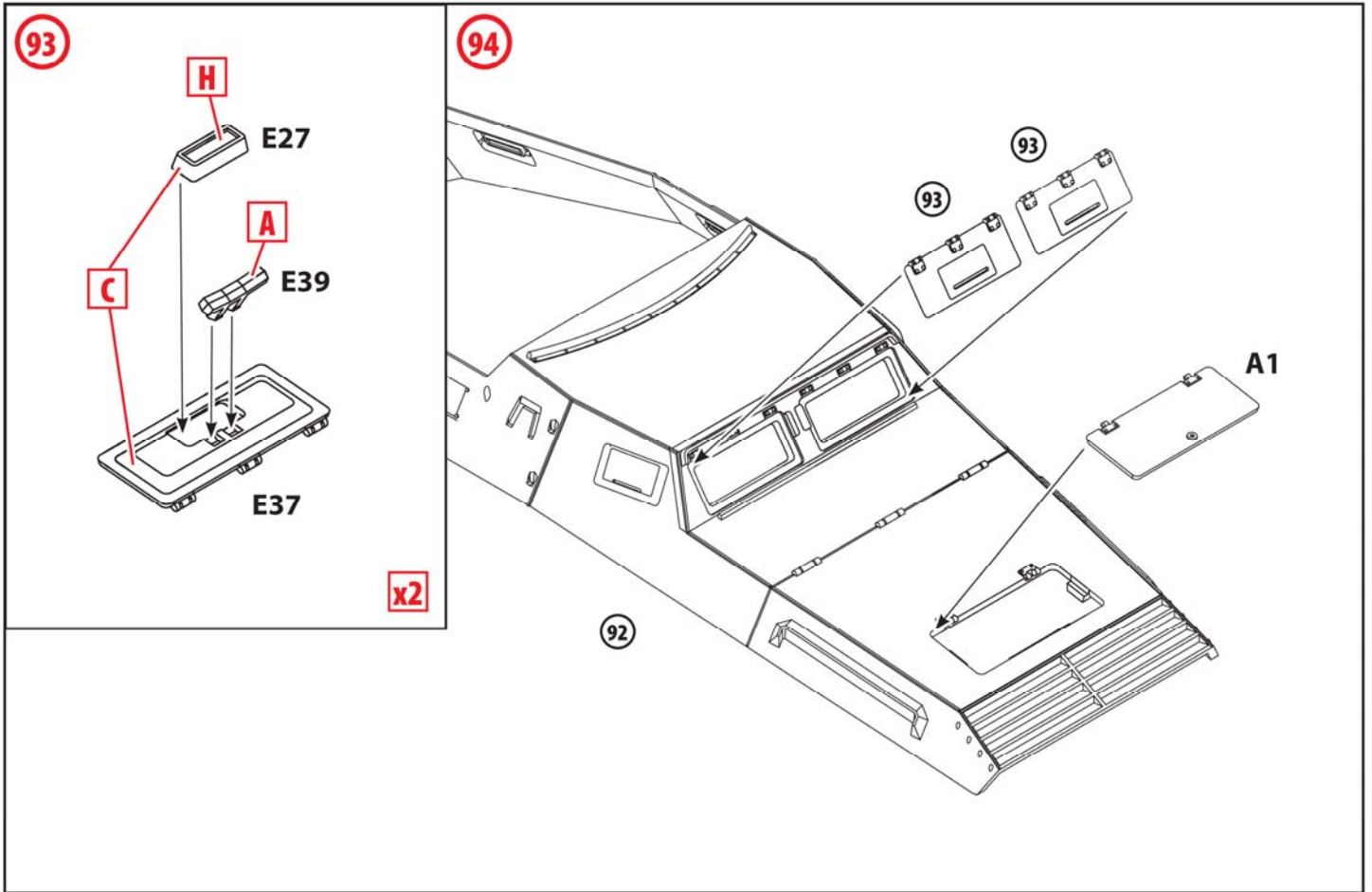

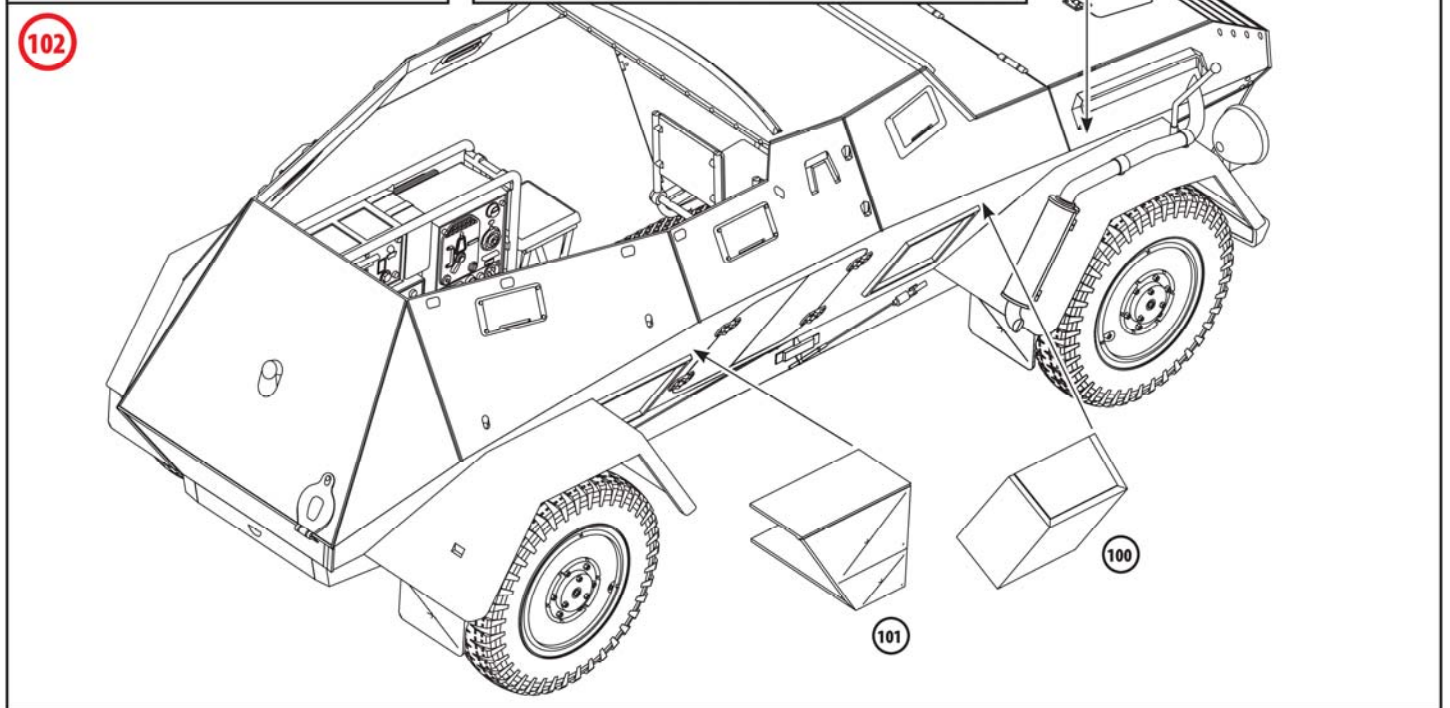
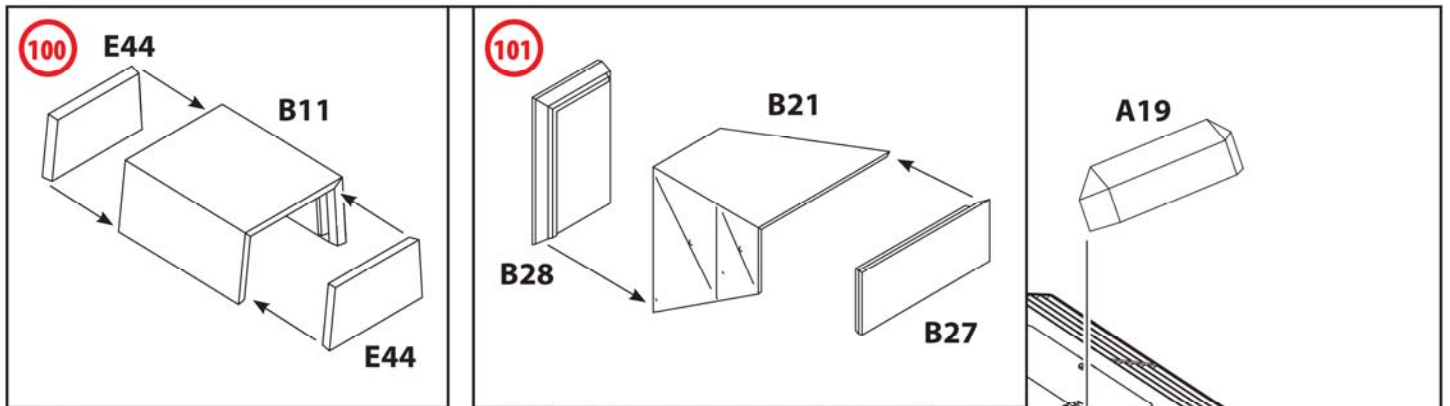
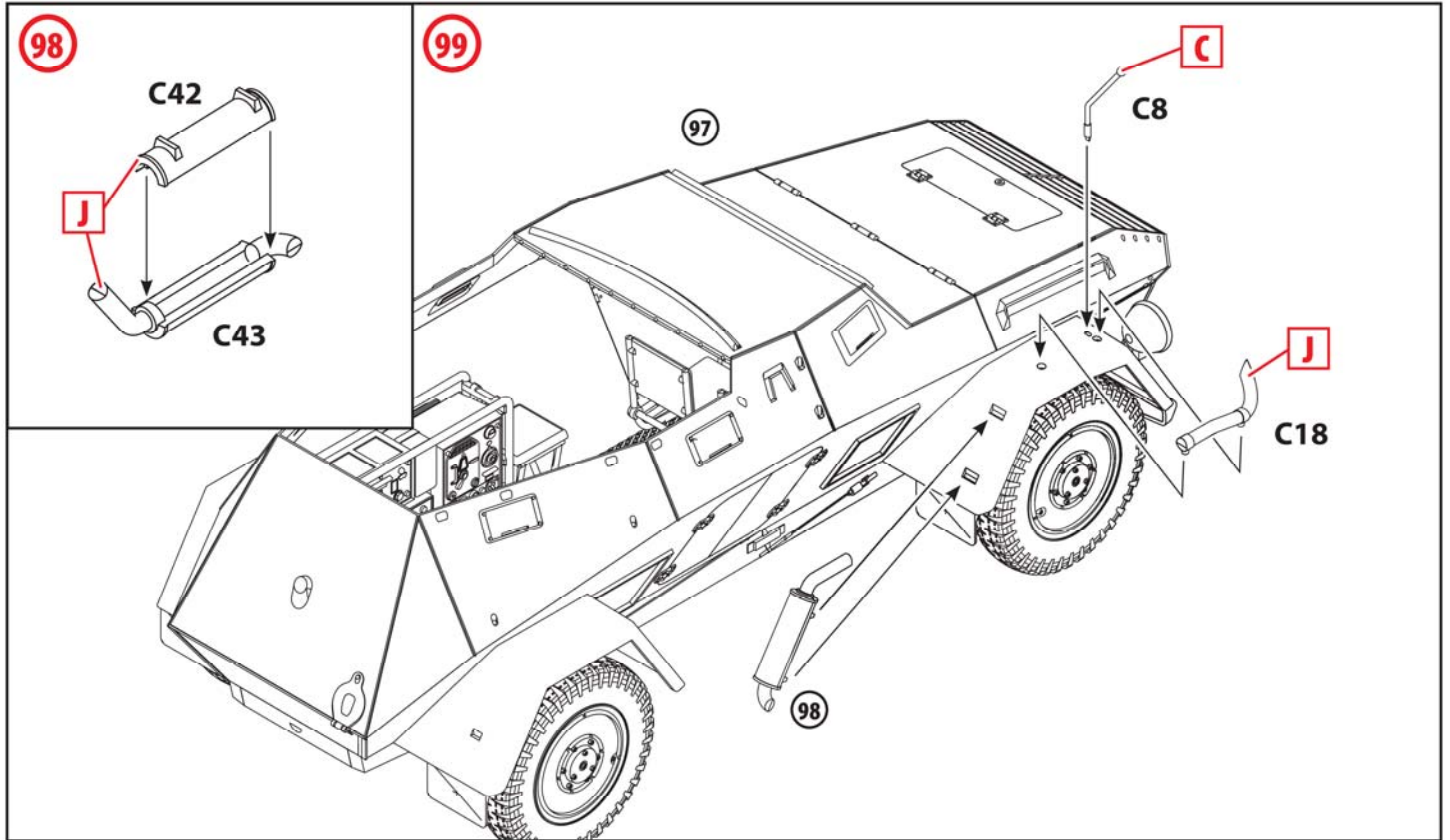

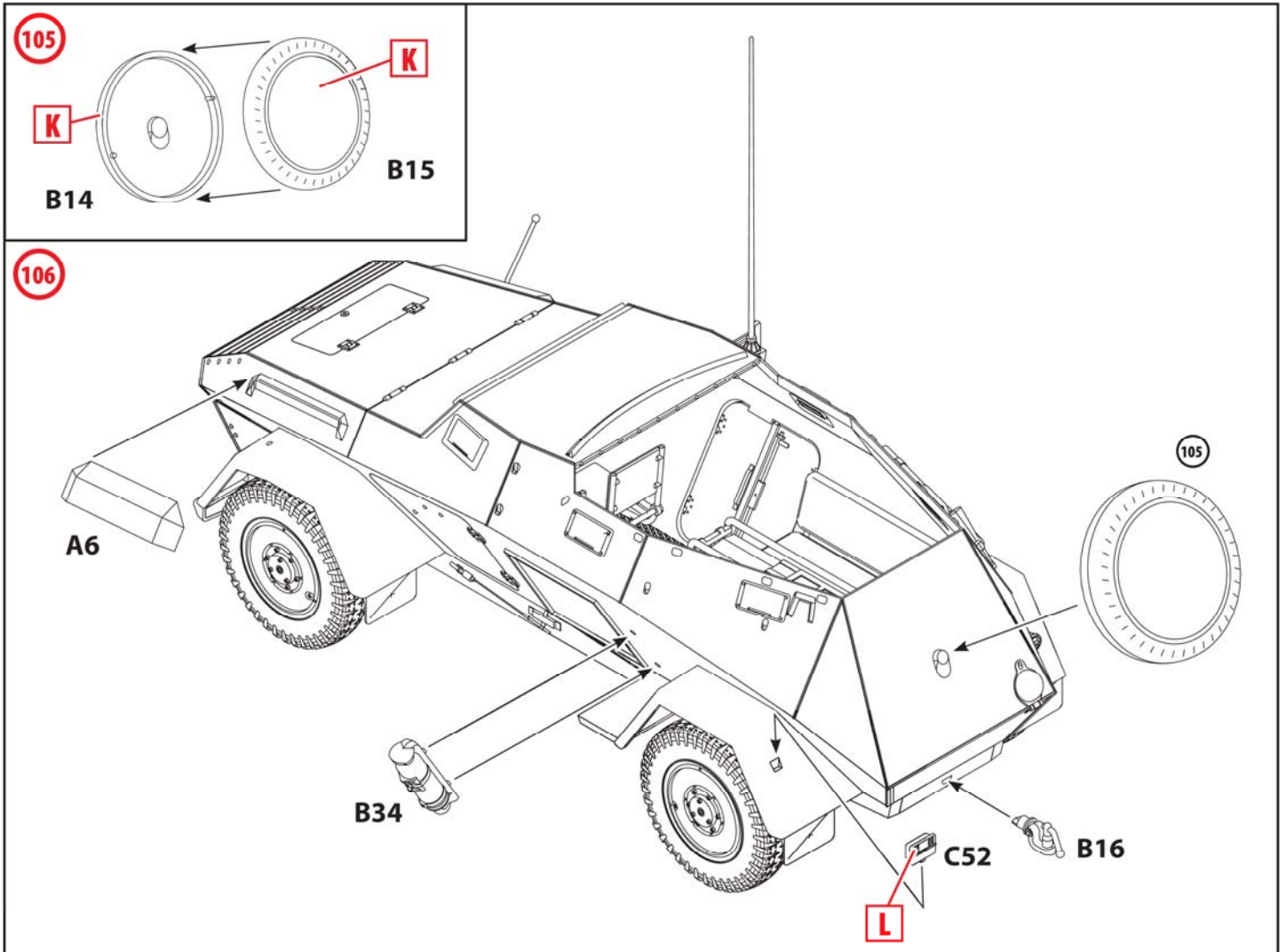
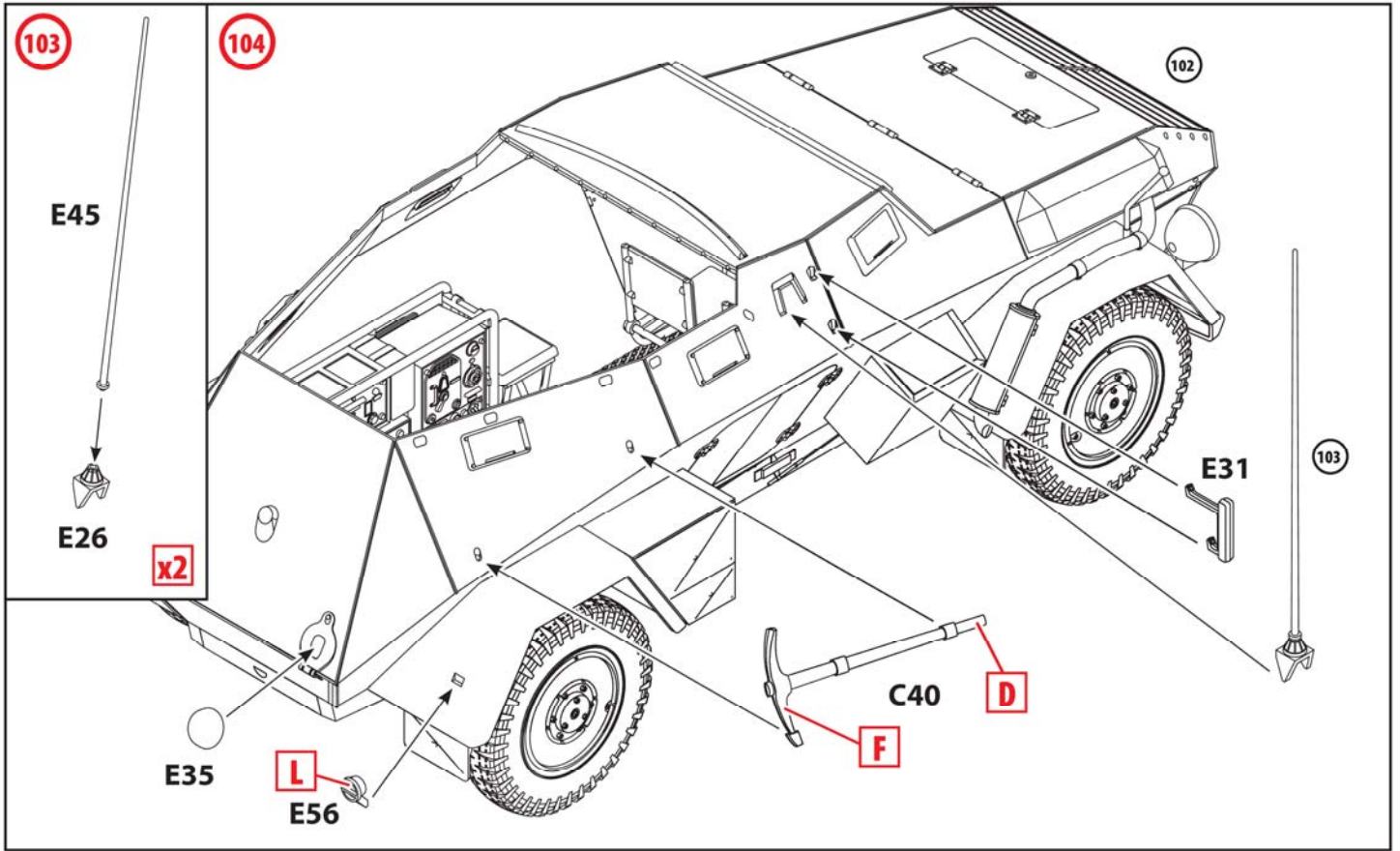



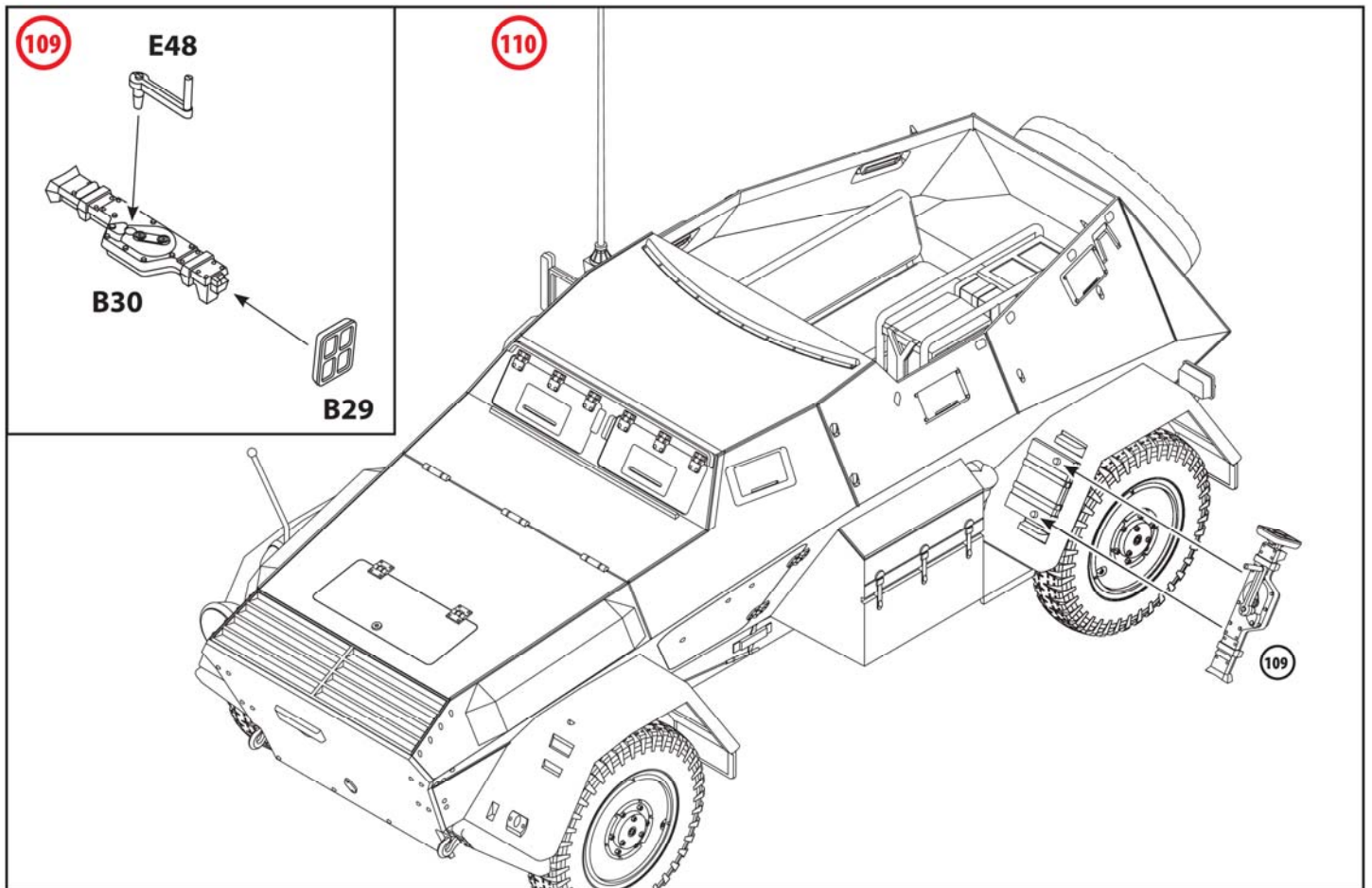
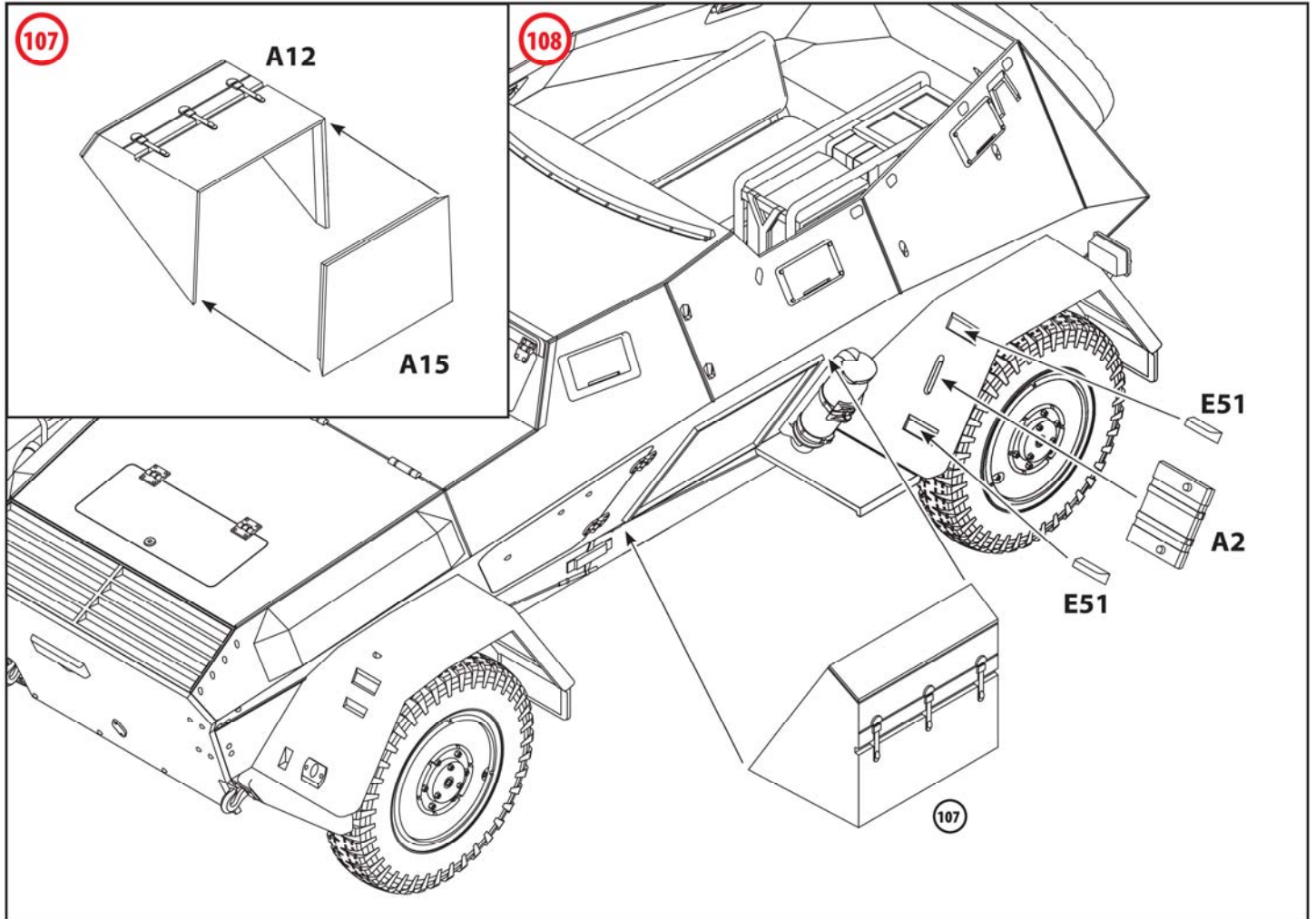

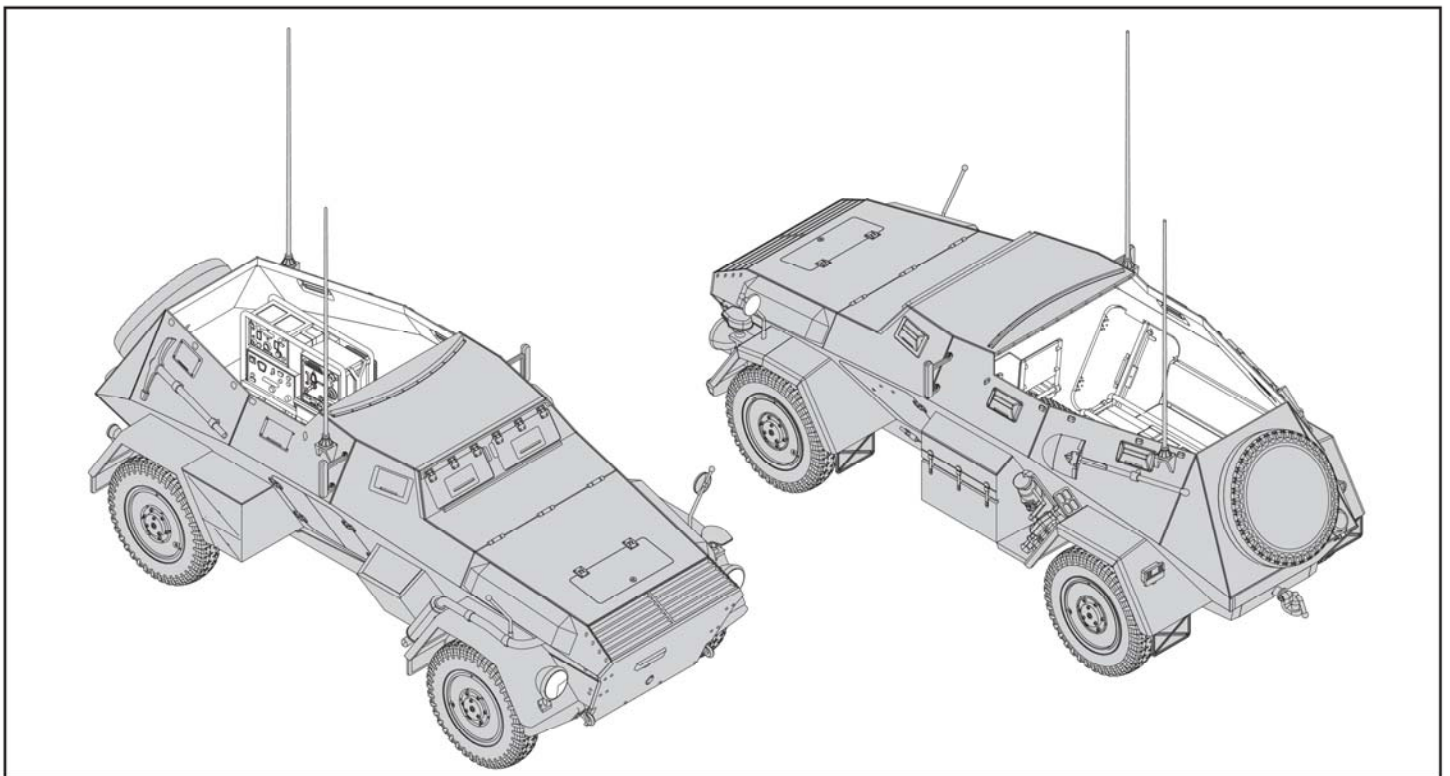
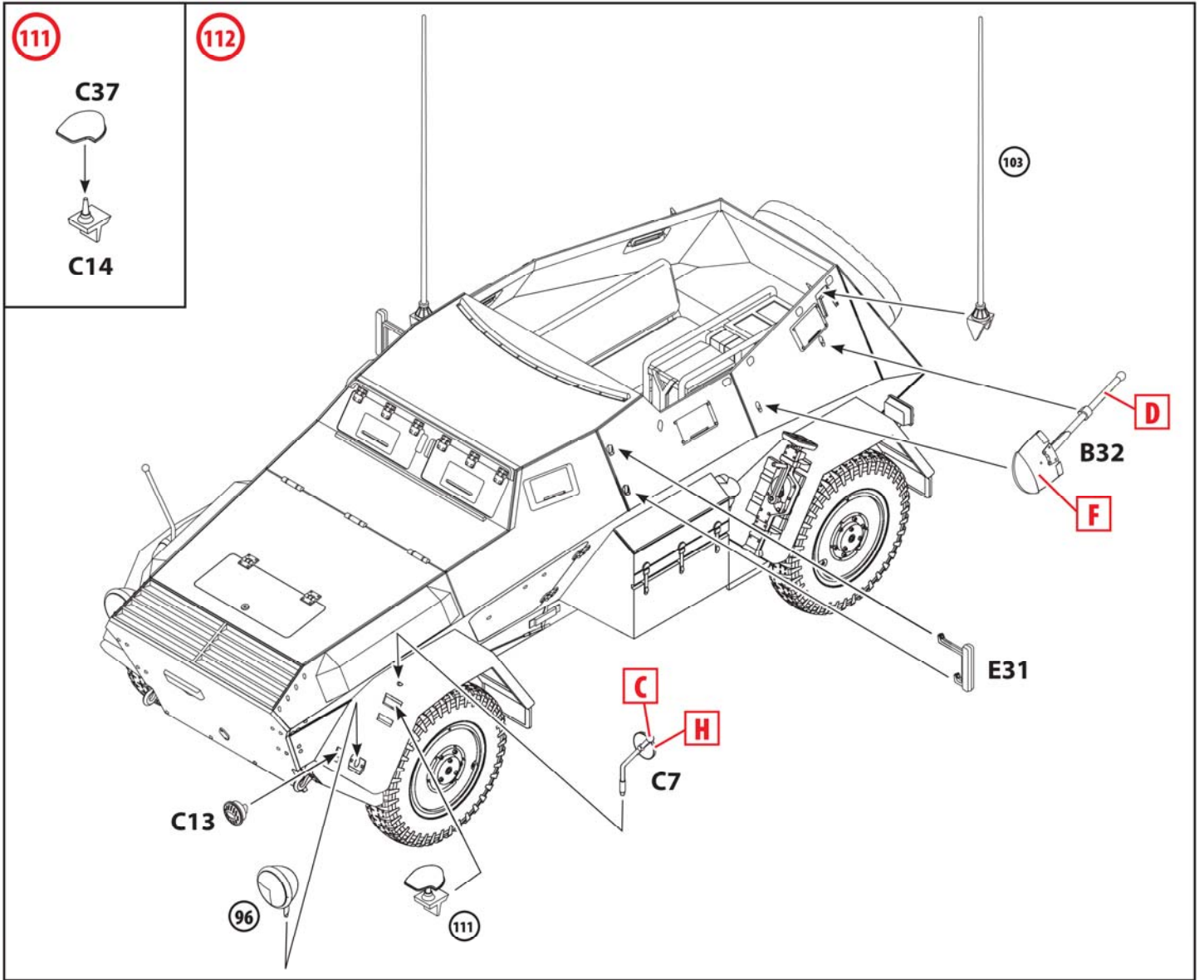

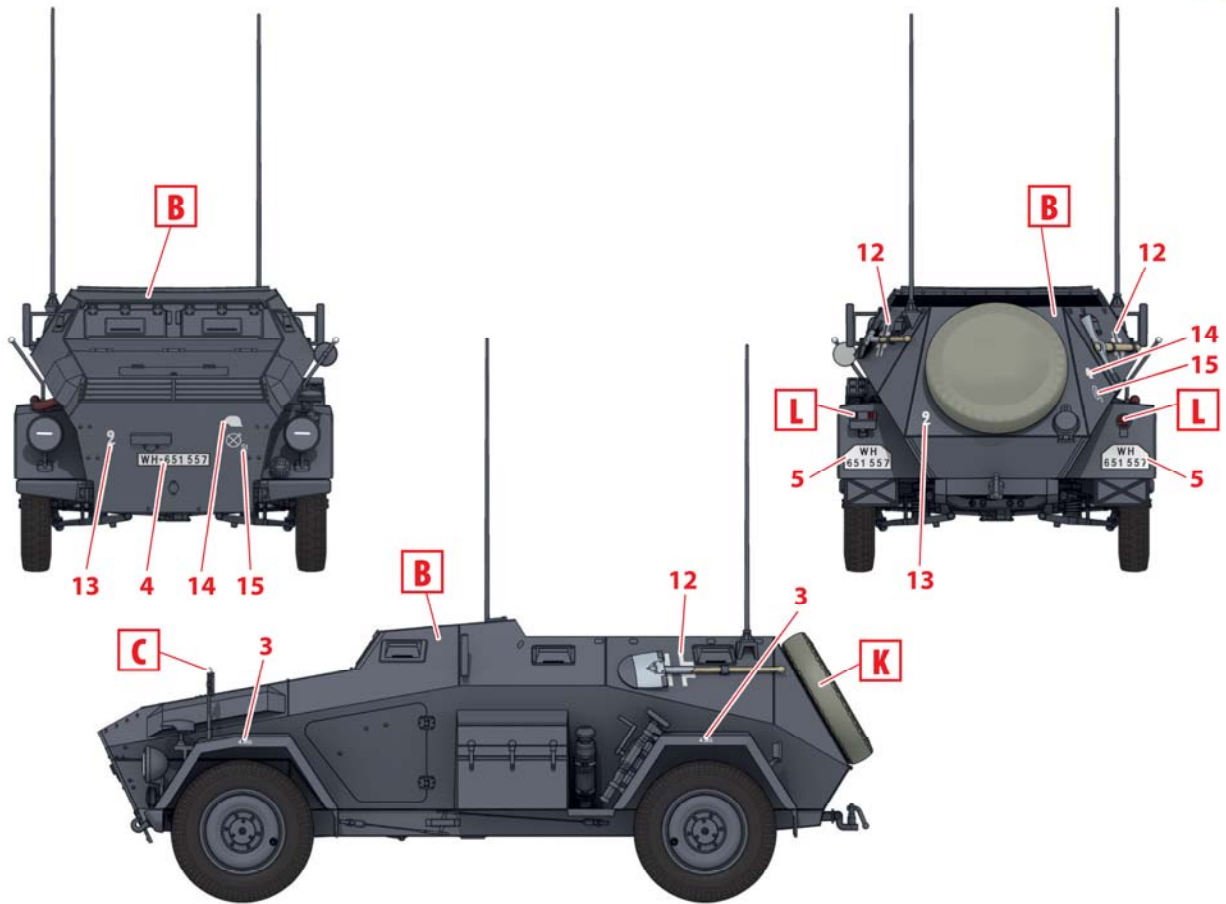

1. Sd.Kfz. 247 Ausf.B, дивизия Grossdeutschland, Украина, лето 1942 г.  
Sd.Kfz. 247 Ausf.B, Grossdeutschland division, Ukraine, Summer 1942

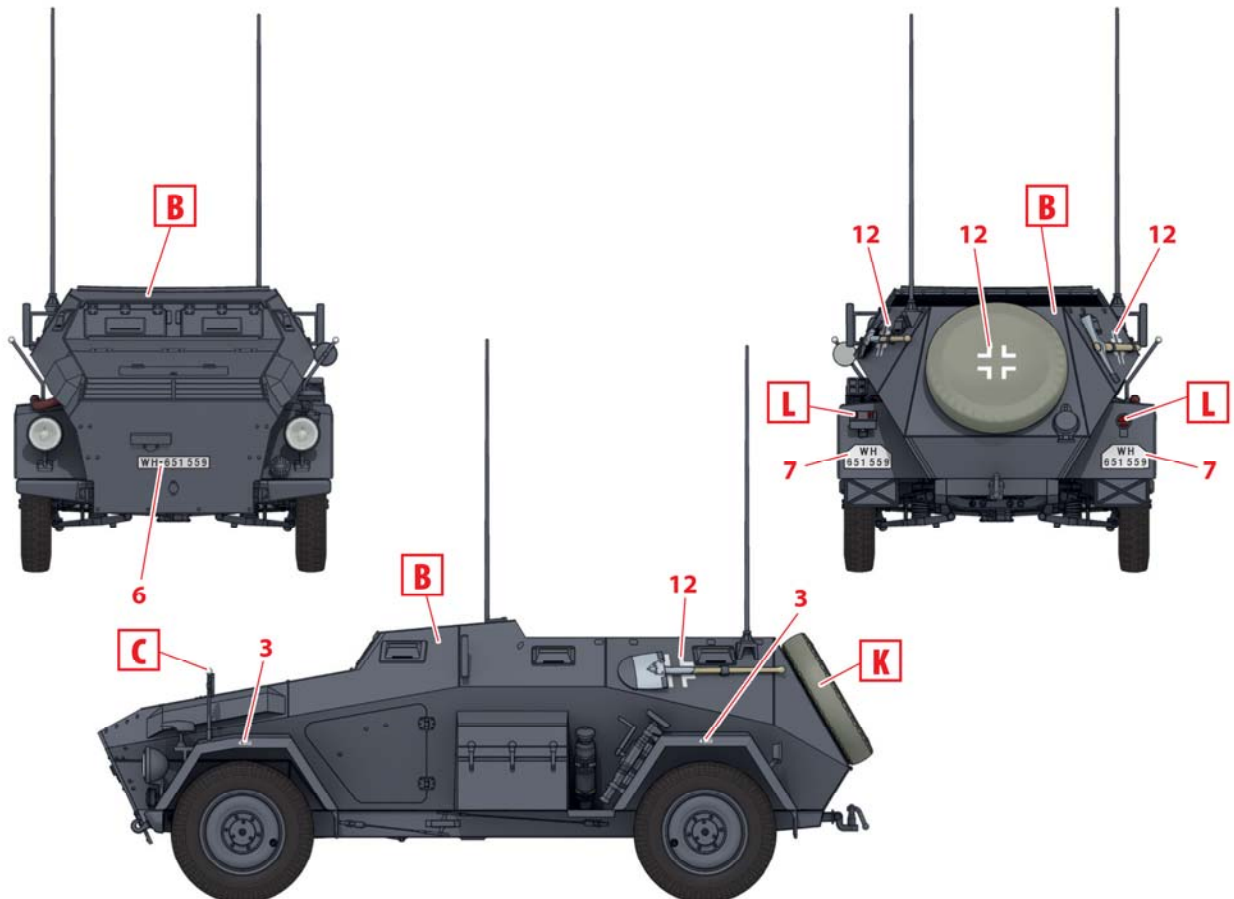

2. Sd.Kfz. 247 Ausf.B, Россия, осень 1941 г.  
Sd.Kfz. 247 Ausf.B, Russia, Autumn 1941

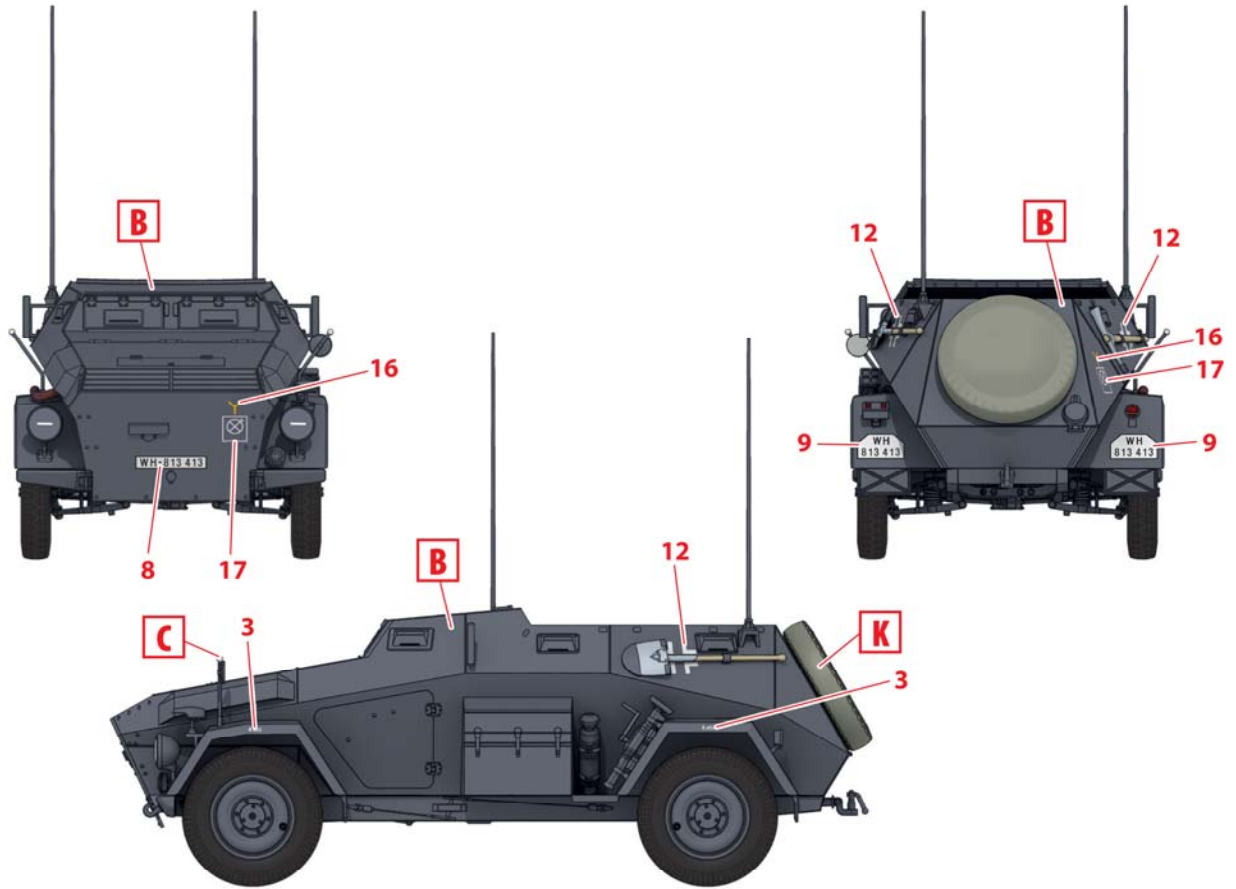

3. Sd.Kfz. 247 Ausf.B, 7-я танковая дивизия, Россия, лето 1941 г.  
Sd.Kfz. 247 Ausf.B, 7th Pz.D., Russia, Summer 1941

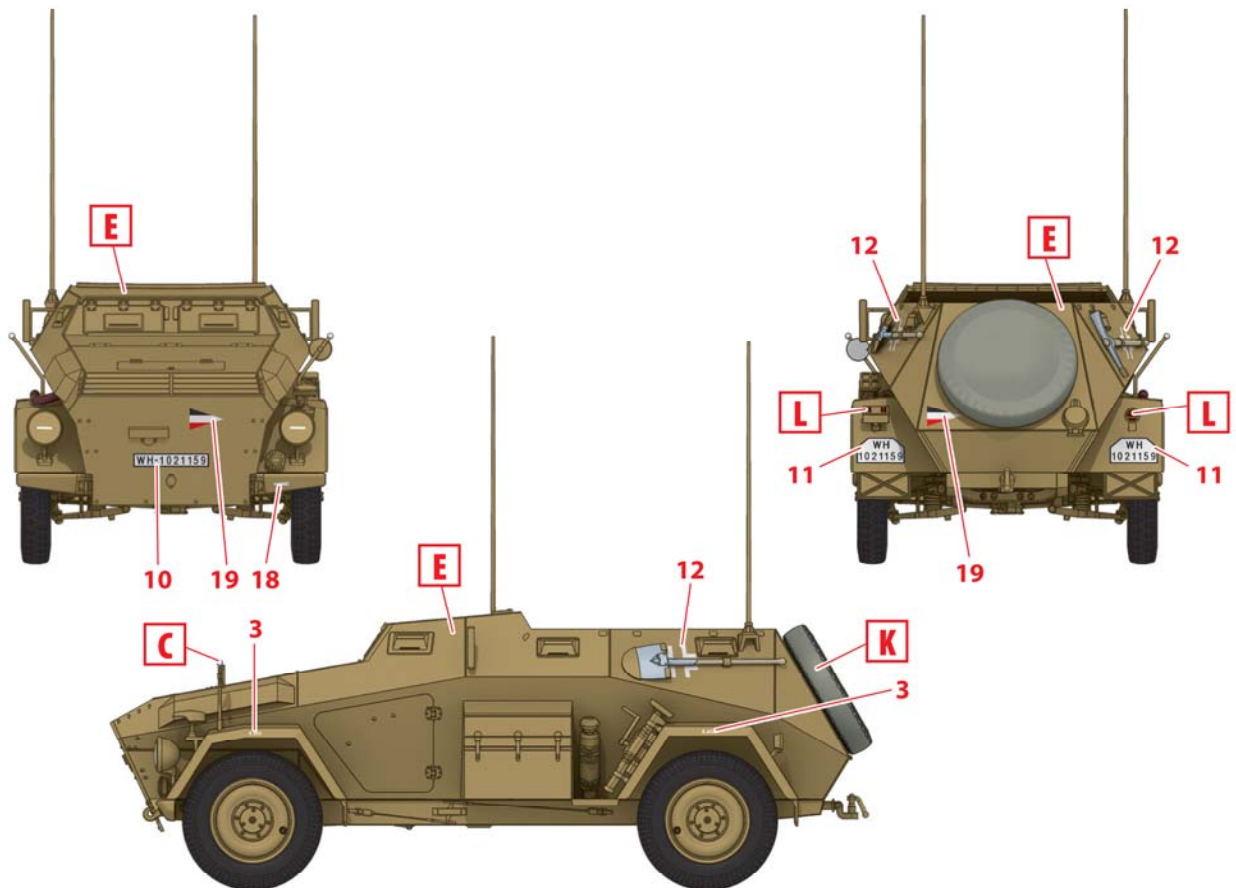

4. Sd.Kfz. 247 Ausf.B, Франция, лето 1944 г.  
Sd.Kfz. 247 Ausf.B, France, Summer 1944