

Ju 88A-4/Torp

Германский торпедоносец II MB

В начале 30-х годов в мире возникла идея создания скоростного бомбардировщика, который мог бы обогнать современные ему истребители-бипланы. Одним из воплощений этой концепции стал двухмоторный бомбардировщик Ju 88, разработанный германской фирмой Юнкерс Флюгzeug – унд Моторенверке.

С весны 1941 г. началось производство самолетов Ju 88A-4 с усиленным вооружением, на которых были установлены двигатели жидкостного охлаждения Jumo 211J увеличенной мощности.

Модификация Ju 88A-4/Torp была оборудована подвеской двух торпед LT F5b. Эти самолеты применялись в качестве противокорабельных над Атлантикой и Средиземным морем в 1941 – 1944 г.г.

Тактико-технические характеристики Ju 88A-4/Torp

Длина, м.....	14,36
Размах крыла, м.....	20,08
Взлетный вес, кг.....	14000
Двигатели.....	2xJumo 211J, 1400 л.с.
Максимальная скорость, км/ч.....	467
Потолок, м.....	8500
Дальность, км.....	2500
Вооружение ..	4-5x7,92-мм пулеметов MG 81, две 450-мм торпеды LT F5b

ВНИМАНИЕ!

Перед сборкой внимательно прочитайте руководство по монтажу. Каждая деталь пронумерована. Соблюдать последовательность монтажа. Необходимые рабочие инструменты: нож и напильник для зачистки деталей; резиновая лента, клейкая лента и зажимы для сушки белья для прижимания склеиваемых деталей. Детали из пластика очистить в растворе мягкого моющего средства и высушить на воздухе для того, чтобы краска и переводные картинки лучше прилипали. Перед приклеиванием проверить, подходят ли детали; клей наносить экономно. Хром и краску удалить с поверхностей склеивания. Небольшие детали покрасить перед тем, как они будут удалены из рамок. Краску необходимо хорошо просушить, только после этого продолжать сборку. Каждую соответствующую переводную картинку отдельно вырезать и примерно на 20 секунд окунуть в теплую воду. На обозначенном месте картинку отделить от бумаги и прижать промокающей бумагой.

Ju 88A-4/Torp

WWII German Torpedo Plane

In the beginning of 30s it was appeared in the world an idea of high-speed bomber that could outstrip contemporary fighters. One of the objectifications of this conception became the twin-engine bomber Ju 88 designed by a German Junkers Flugzeug - und Motorenwerke AG company.

Since the spring of 1941 it were produced Ju 88A-4 planes with liquid-cooled Jumo 211J engines of increased power and more powerful armament.

Ju 88A-4/Torp were armed with two LT F5b torpedoes. These aircraft were used in anti-shiping role over the Atlantic and Mediterranean Sea in 1941 - 1944.

Tactical and Technical Specifications of Ju 88A-4/Torp

Length, m.....	14,36
Span, m.....	20,08
Start weight, kg.....	14000
Engines.....	2xJumo 211J, 1400 hp
Max. Speed, km/h.....	467
Service ceiling, m.....	8500
Range, km.....	2500
Armament.....	4-5x7,92 mm MG 81, two 45 cm LT F5b torpedoes

CAUTION!

Read the instructions thoroughly prior to assembly. Each component is numbered. Adhere to specified sequence of assembly. Tools required: knife and file for removal of components from frame; rubber bond, adhesive tape and clothes pegs for clamping components together after applying adhesive. Clean plastic components in a mild detergent solution and allow to air-dry so that paint and transfers adhere better. Prior to applying adhesive, check to see whether the components fit together; apply adhesive sparingly. Remove chrome and paint from the contact surfaces. Paint small components before removing them from the frame. Allow paint to dry well, and only then continue to assemble. Cut out each transfer individually and immerse in warm water for approx. 20 seconds. Slide transfer off paper and into designated position, then press on with blotting paper.

ИСПОЛЬЗУЕМЫЕ КРАСКИ / USED COLORS:

	Revell	Tamiya		
A	108	XF1	Черный, матовый	Flat Black
B	105	XF2	Белый, матовый	Flat White
C	115	XF3	Желтый, матовый	Flat Yellow
D	140	XF27	Черно-зеленый RLM 70	Schwarzgrun RLM70
E	139	XF61	Темно-зеленый RLM71	Dunkelgrun RLM71
F	149	XF23	Голубой RLM65	Hellblau RLM65
G	177	XF84	Черно-серый, матовый	Schwarzgrau RLM66

	Revell	Tamiya		
H	145	XF22	Серо-зеленый RLM02	Grau RLM02
J	199	XF16	Алюминий, полуматовый	Aluminium
K	191	X11	Сталь	Steel
L	109	X10	Темный металл	Gun Metal
M	183	XF64	Ржавчина	Rust
N	330	XF7	Красный, матовый	Flat Red
P	364	XF26	Зеленый, матовый	Flat Green

01 СТАДИЯ СБОРКИ
ASSEMBLY STEP

03 СБОРОЧНАЯ ЕДИНИЦА
ASSEMBLY UNIT

A ИСПОЛЬЗУЕМАЯ КРАСКА
USED COLOR

NE НЕ КЛЕИТЬ
DO NOT CEMENT

x2 СДЕЛАТЬ ДВЕ ДЕТАЛИ
MAKE 2 PCS

□ ПРИ СБОРКЕ НЕ ИСПОЛЬЗУЕТСЯ
PARTS NOT FOR USE

✂ ОТРЕЗАТЬ
CUT OFF

***** СДЕЛАТЬ САМОМУ
SCRATCH BUILD

? ПРОИЗВОЛЬНЫЙ ВЫБОР
OPTIONAL

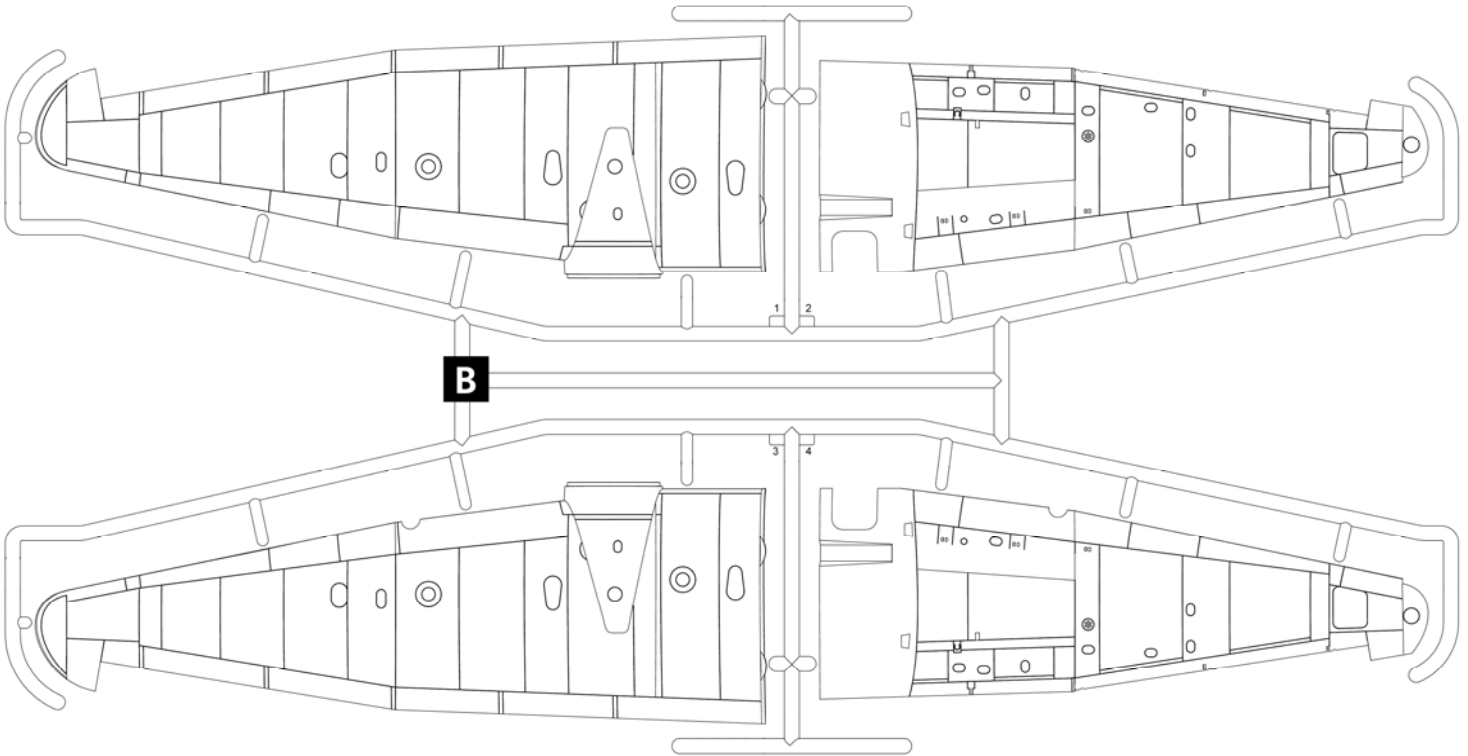
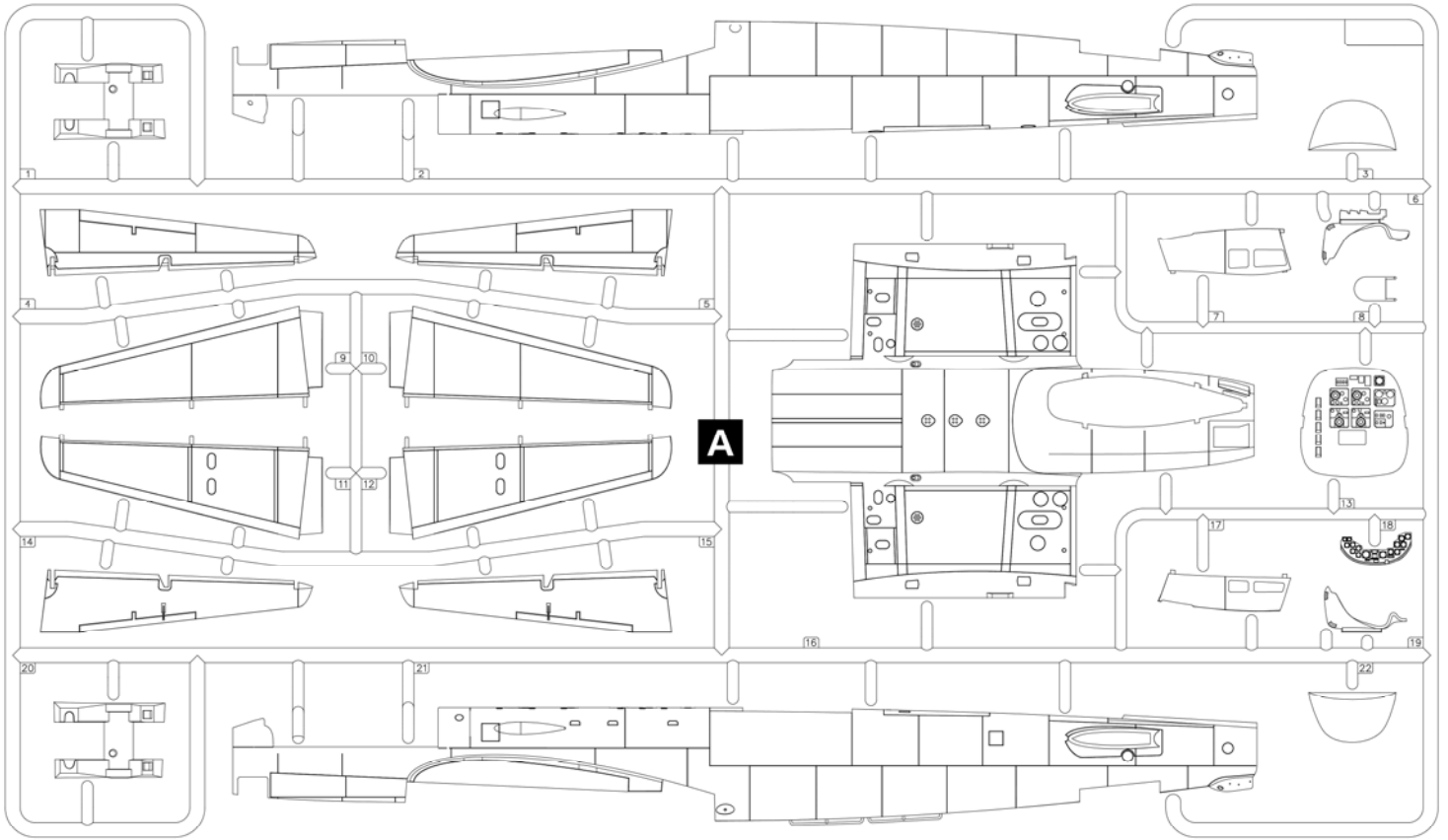

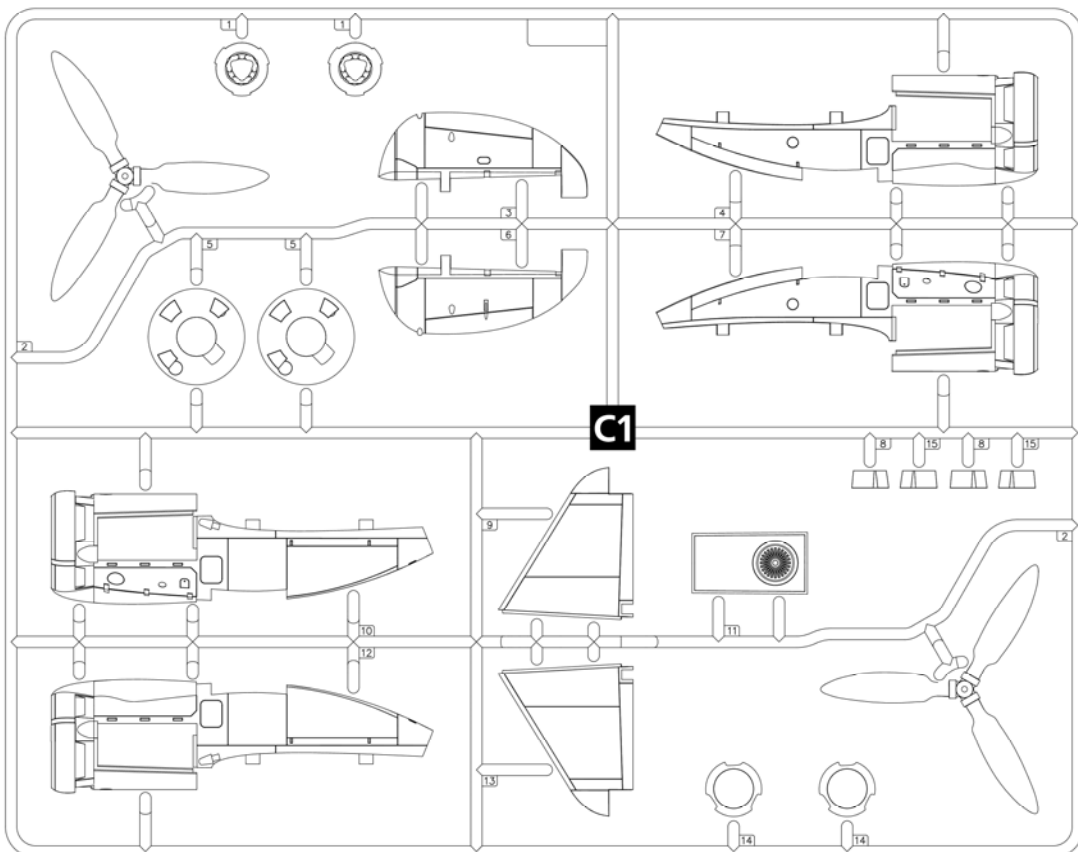
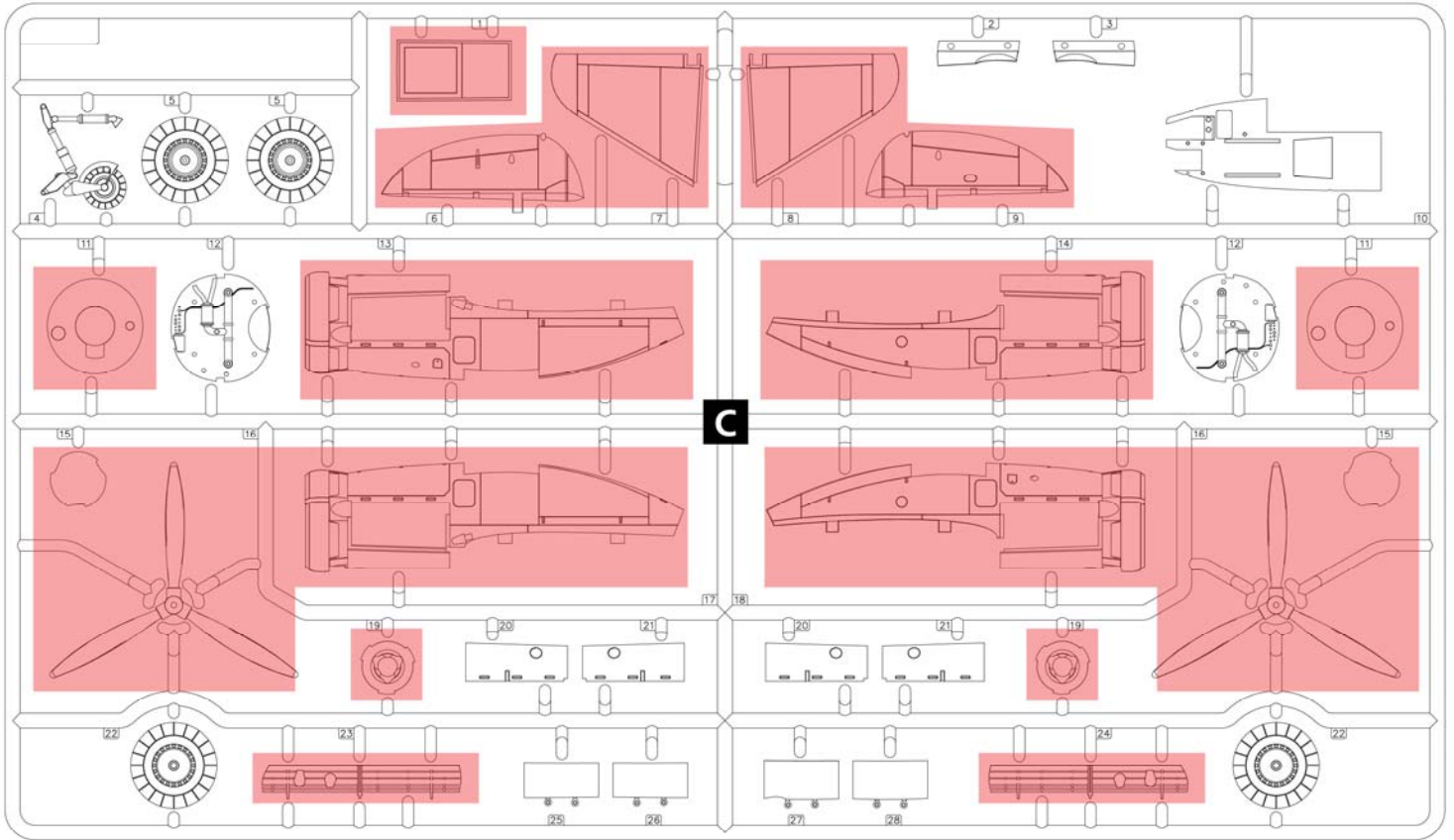

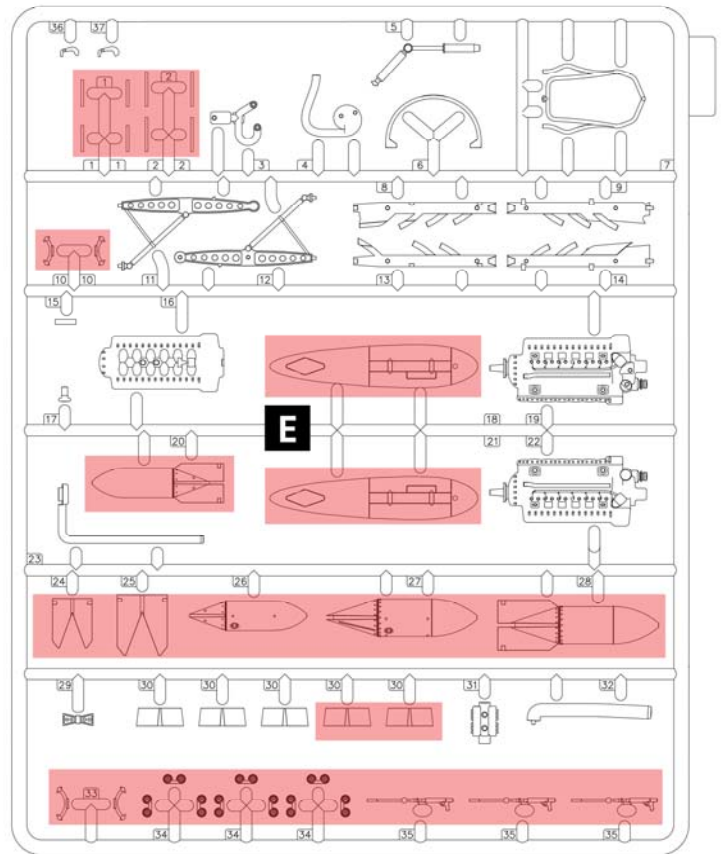
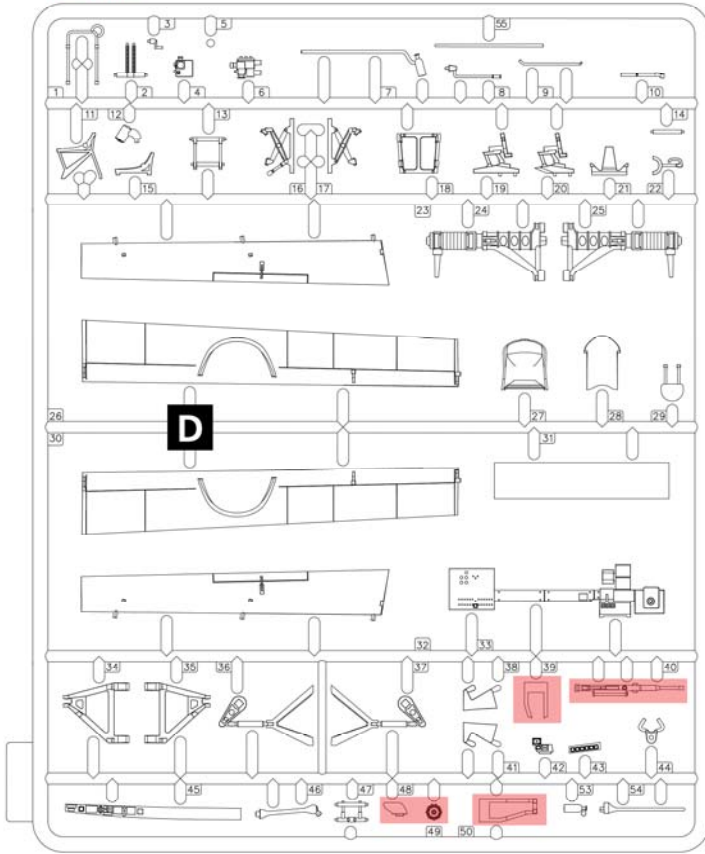

x2

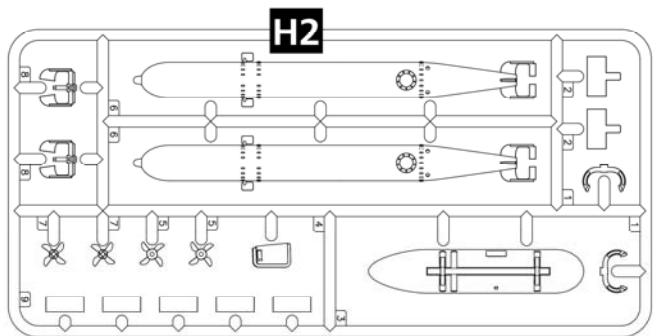
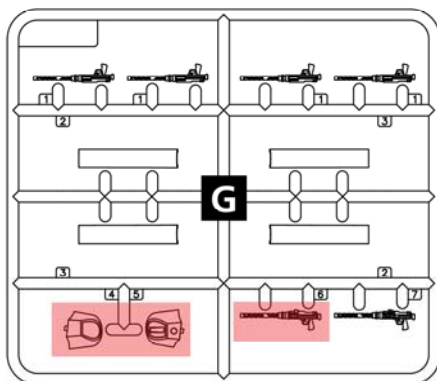
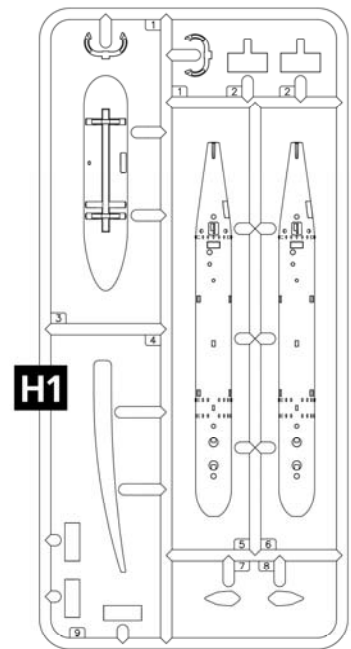
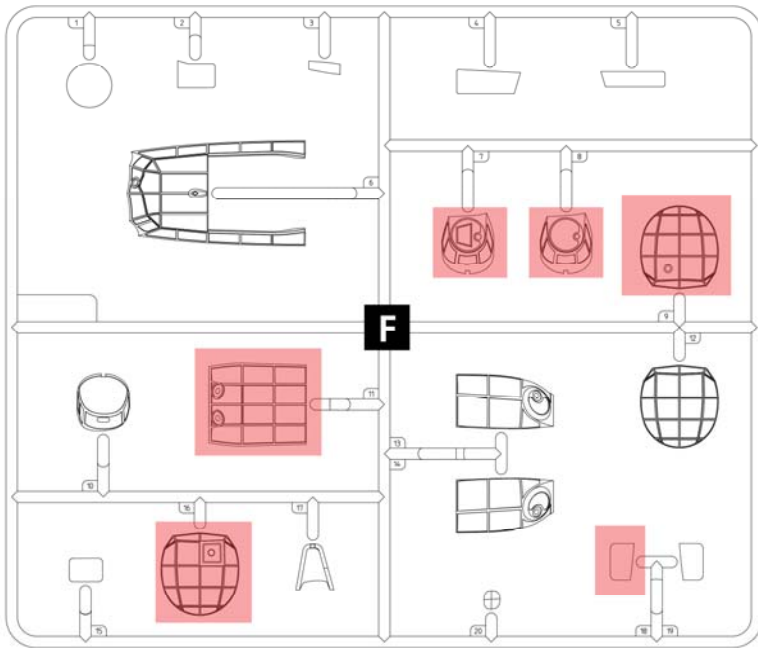

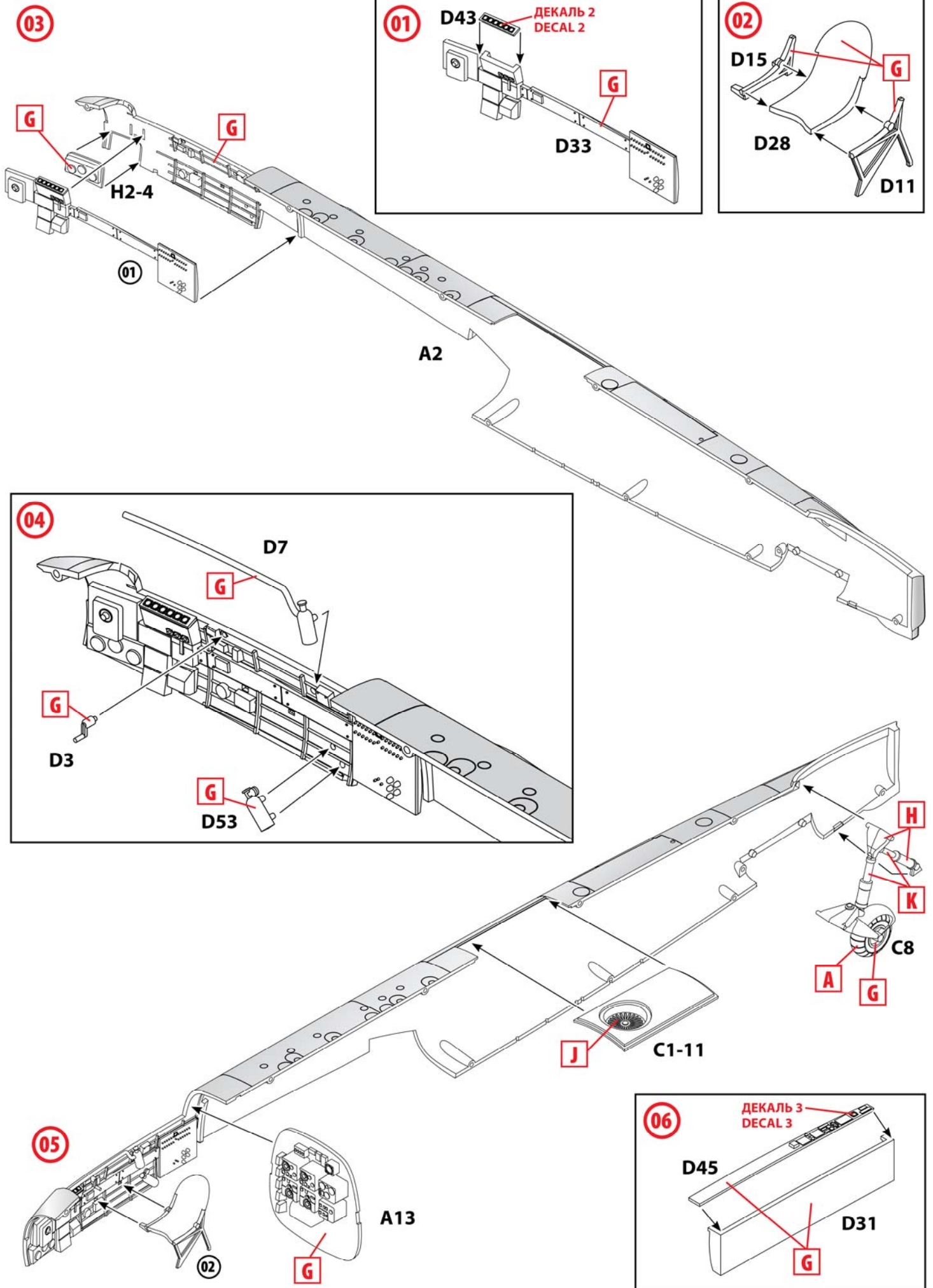

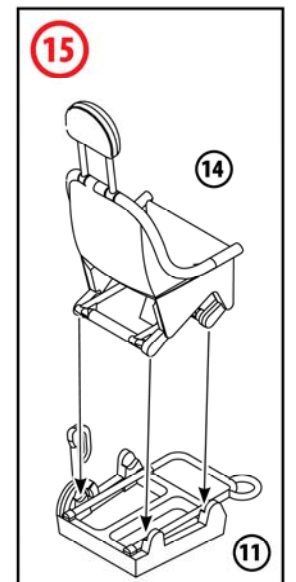
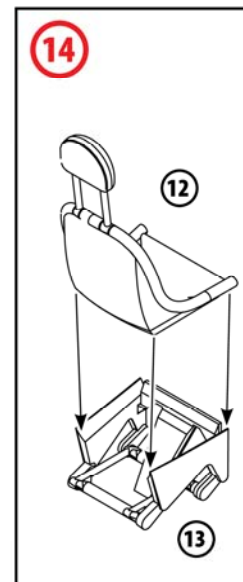
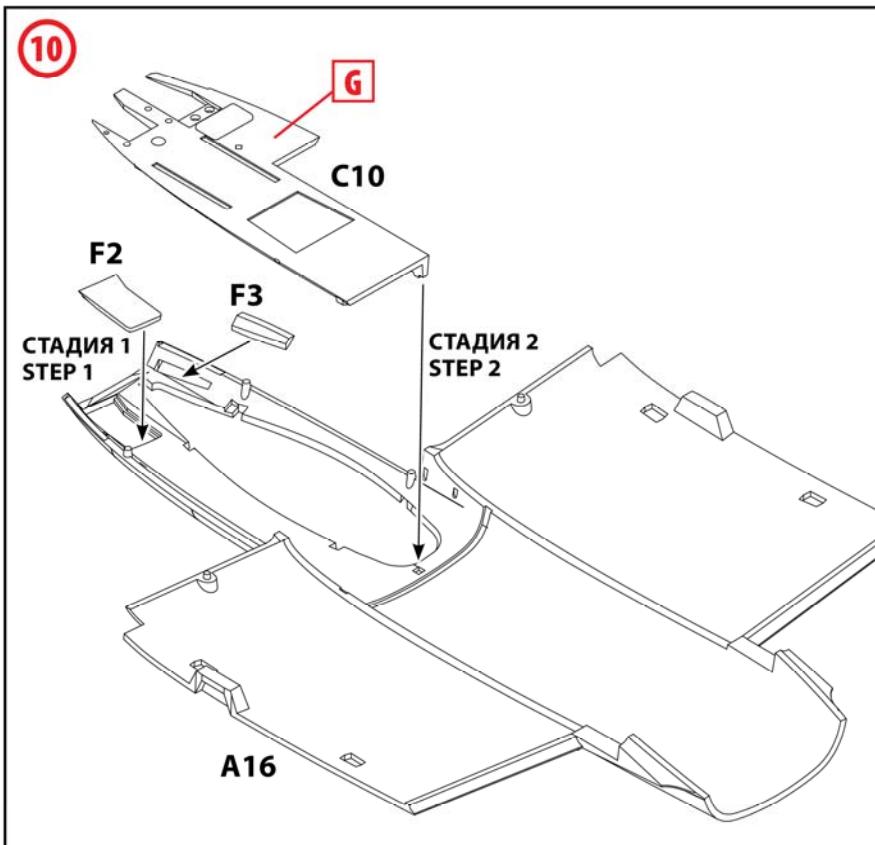
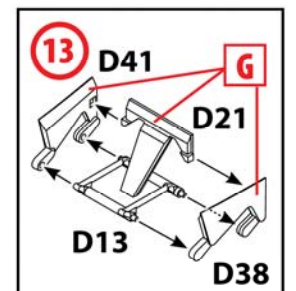
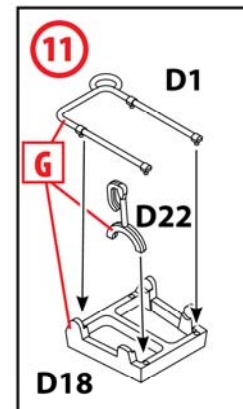
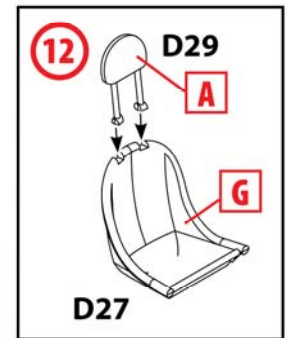
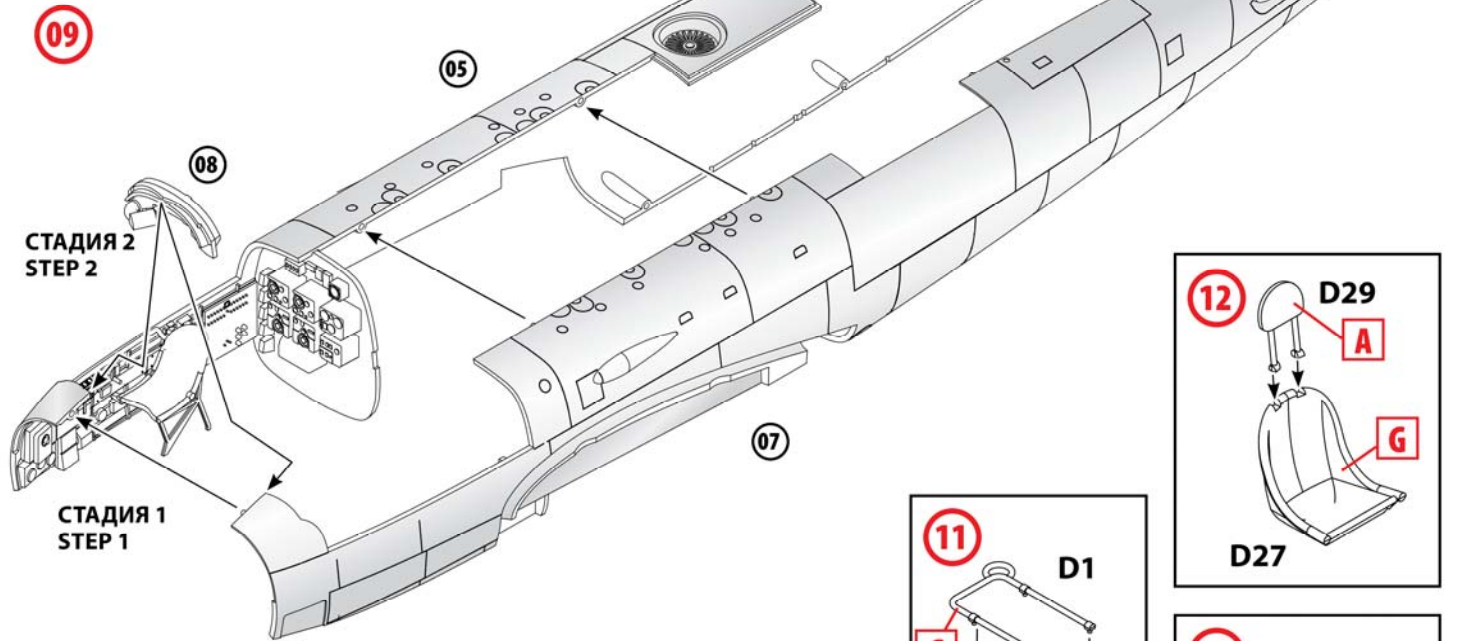
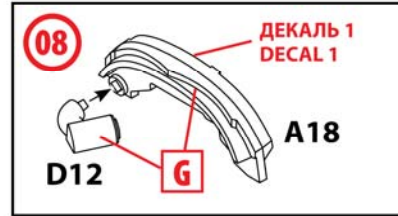
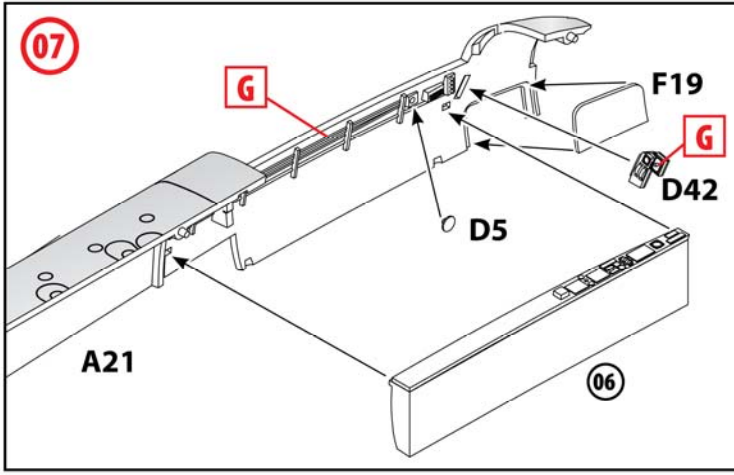

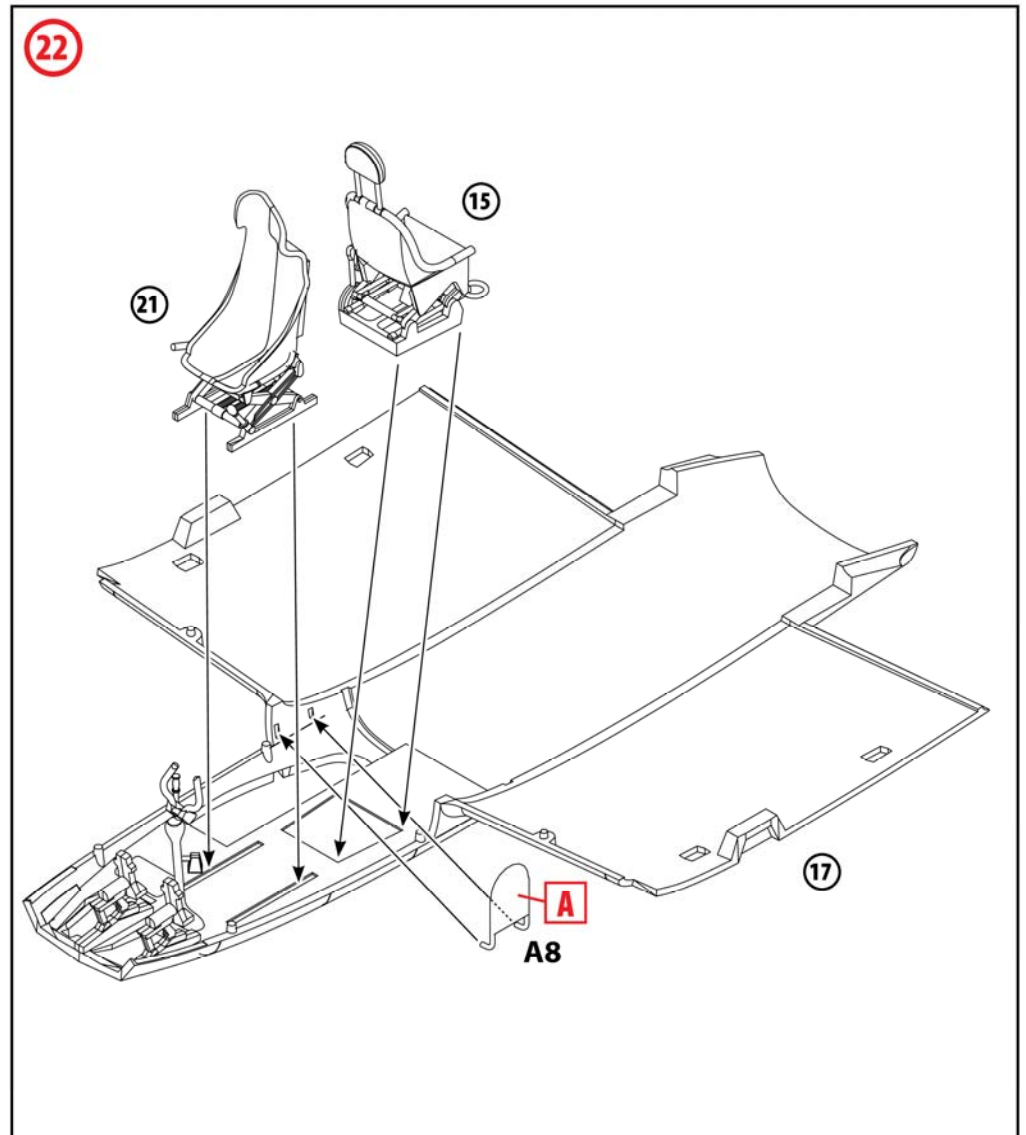
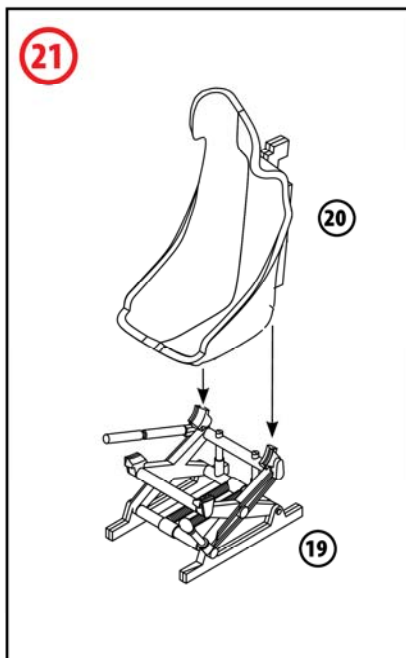
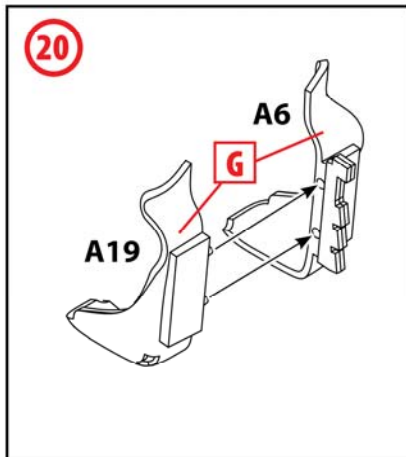
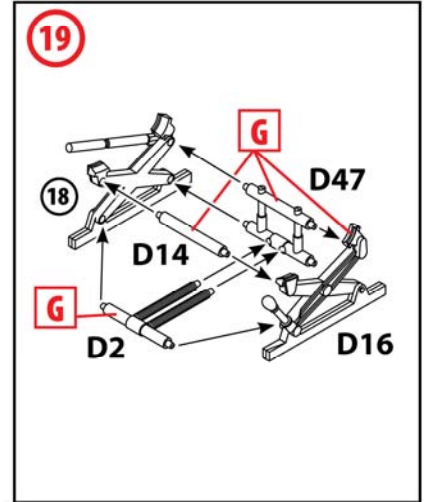
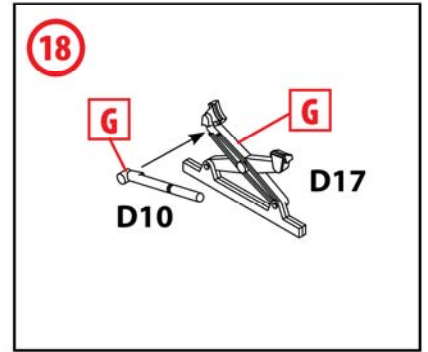
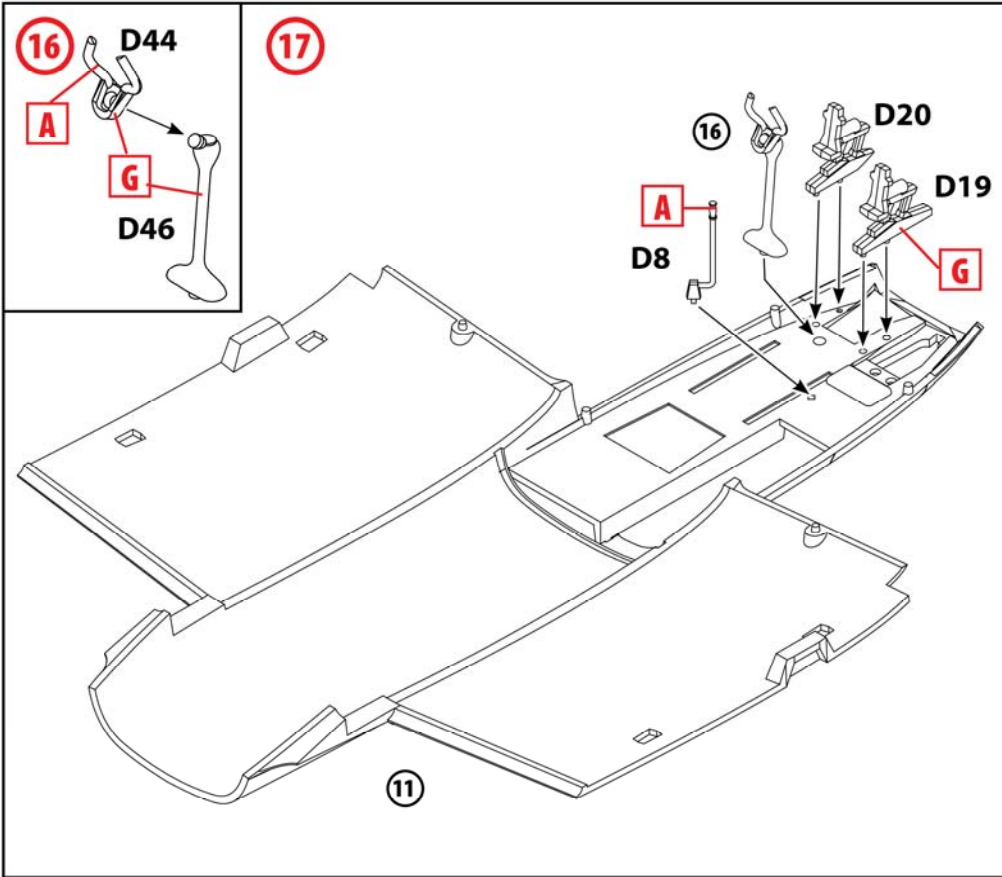

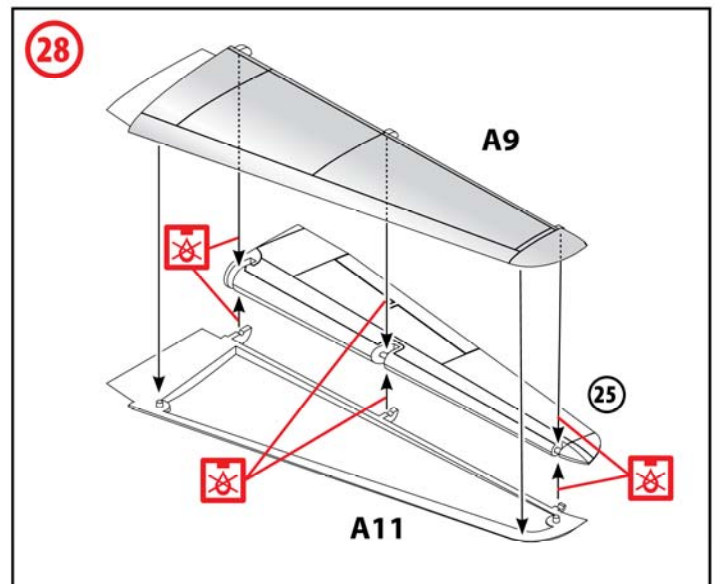
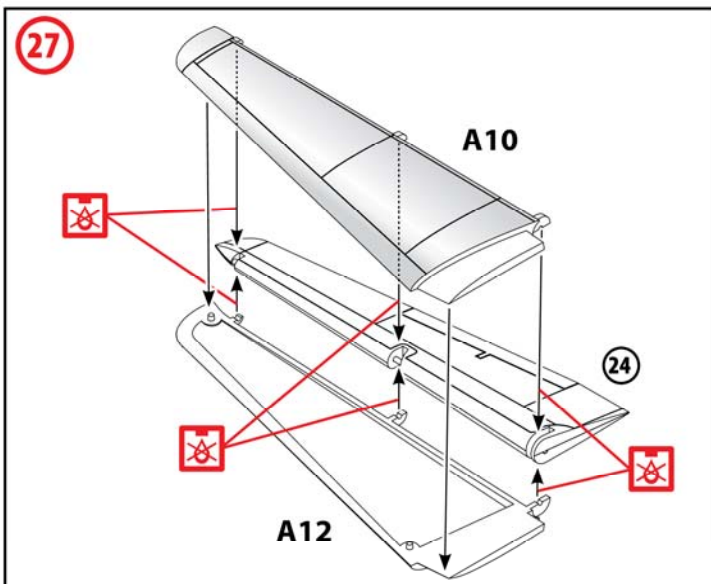
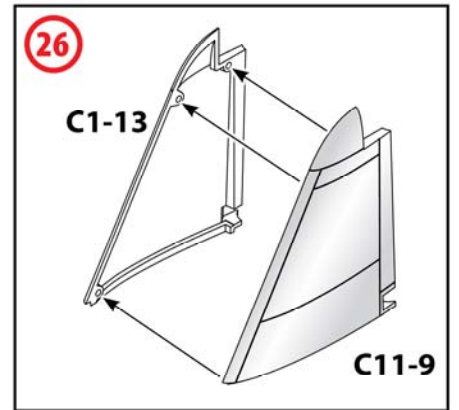
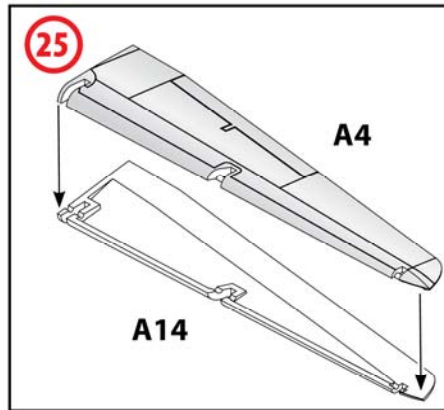
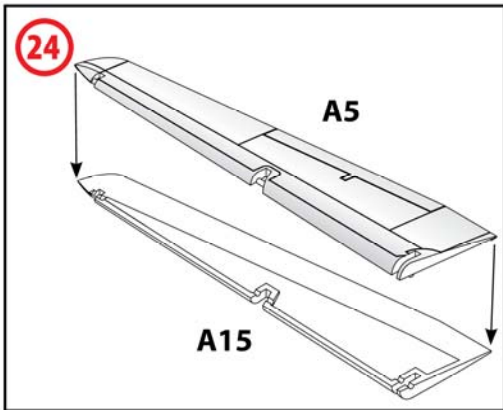
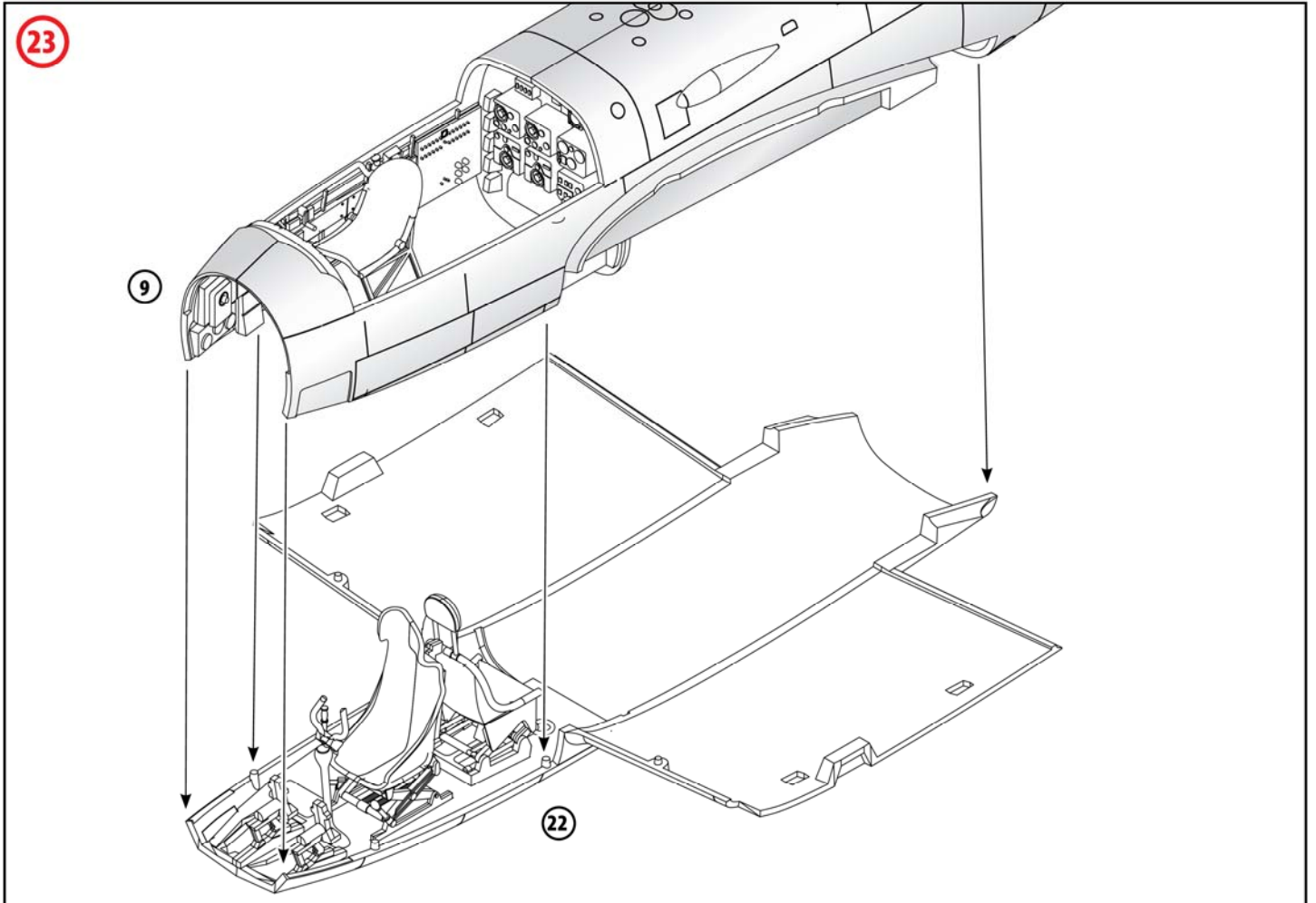

29

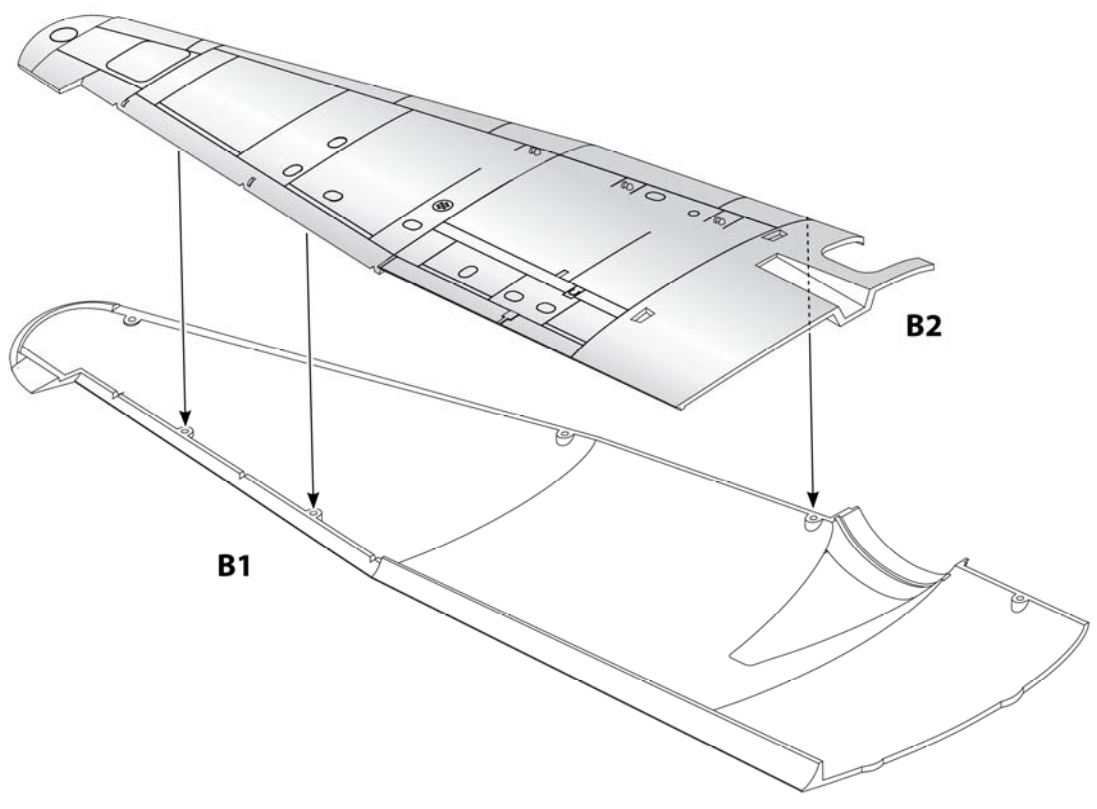

30

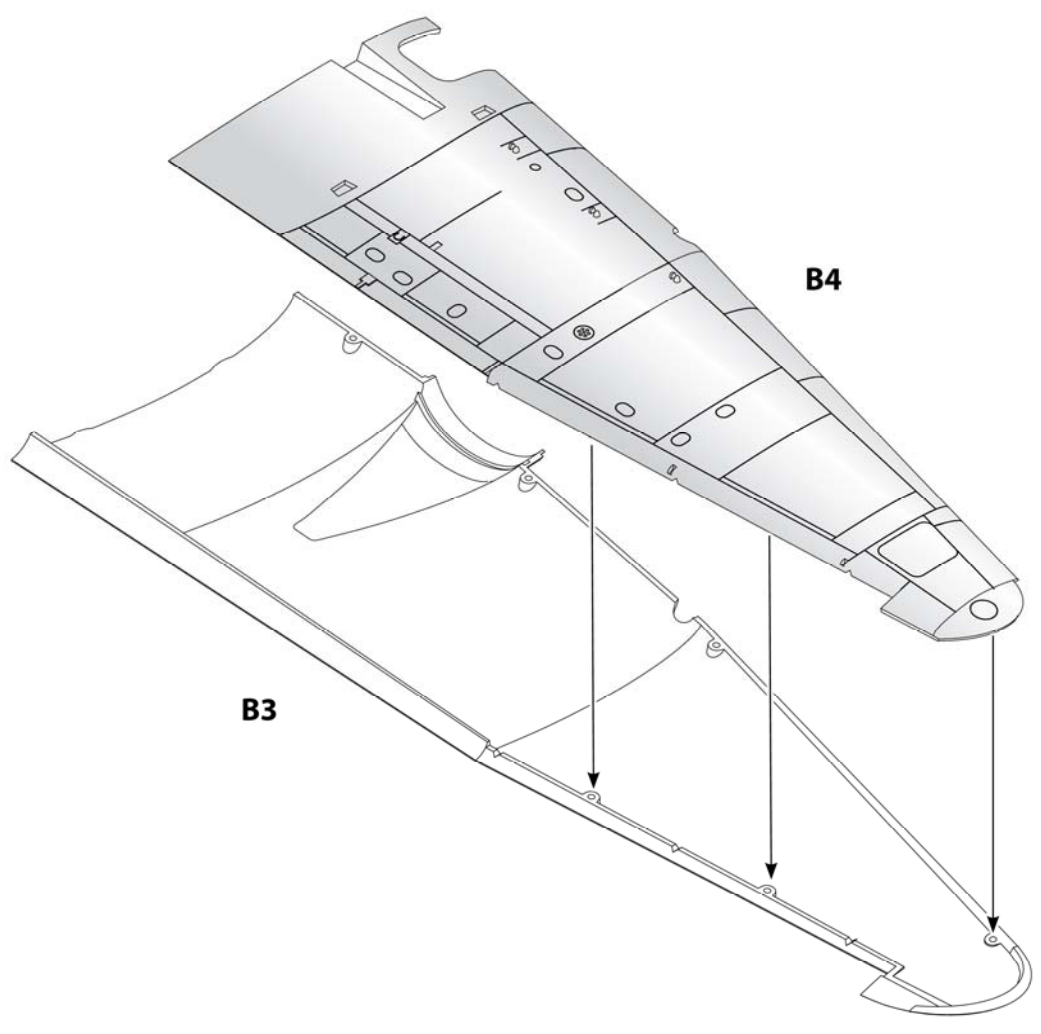

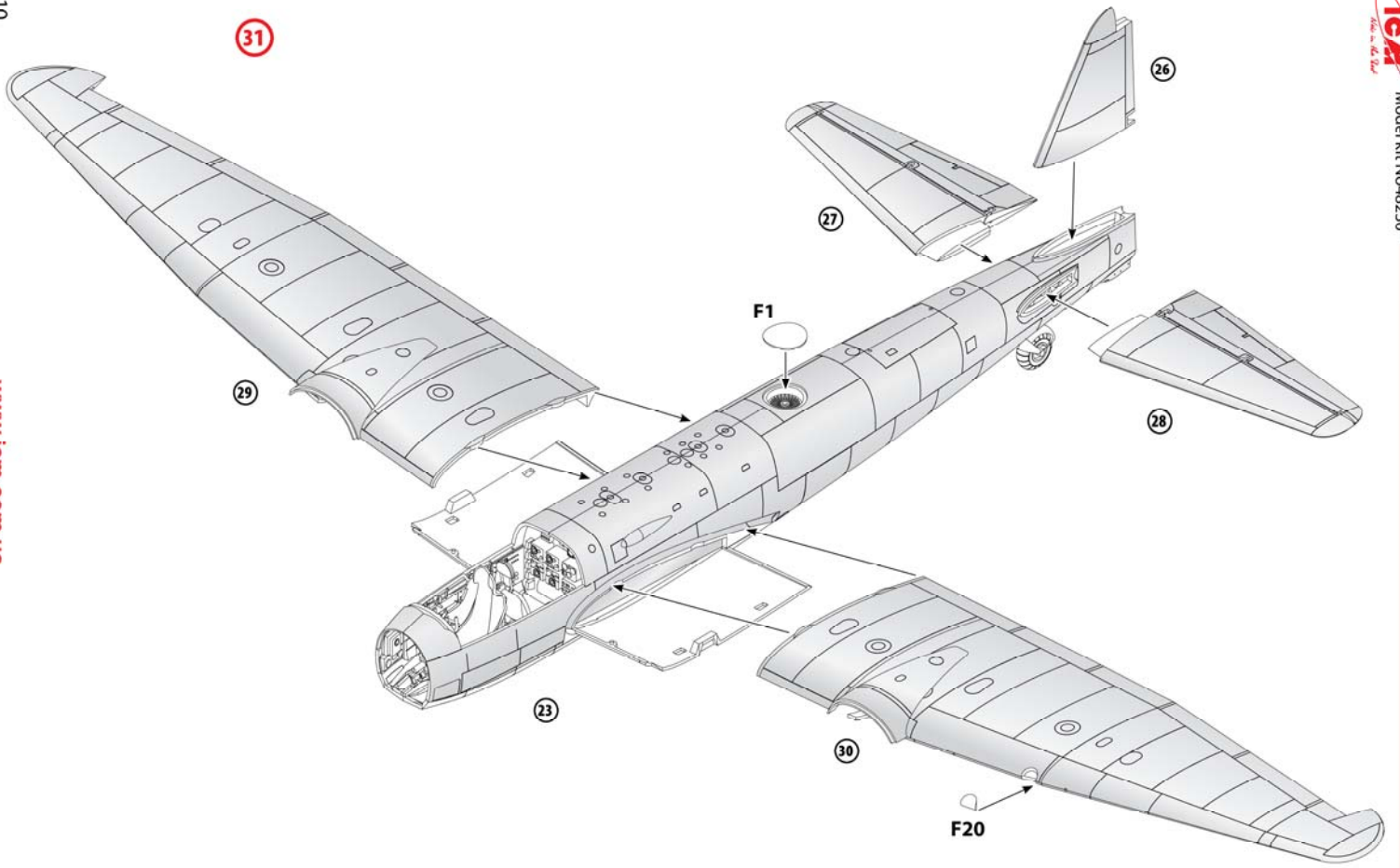

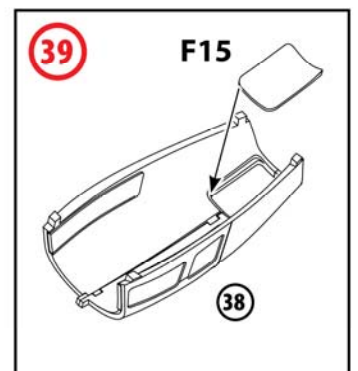
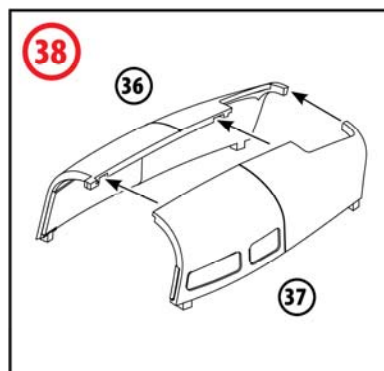
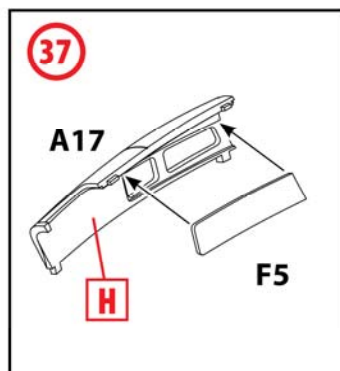
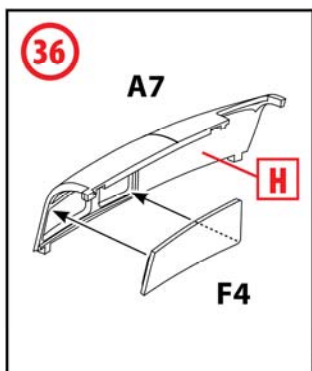
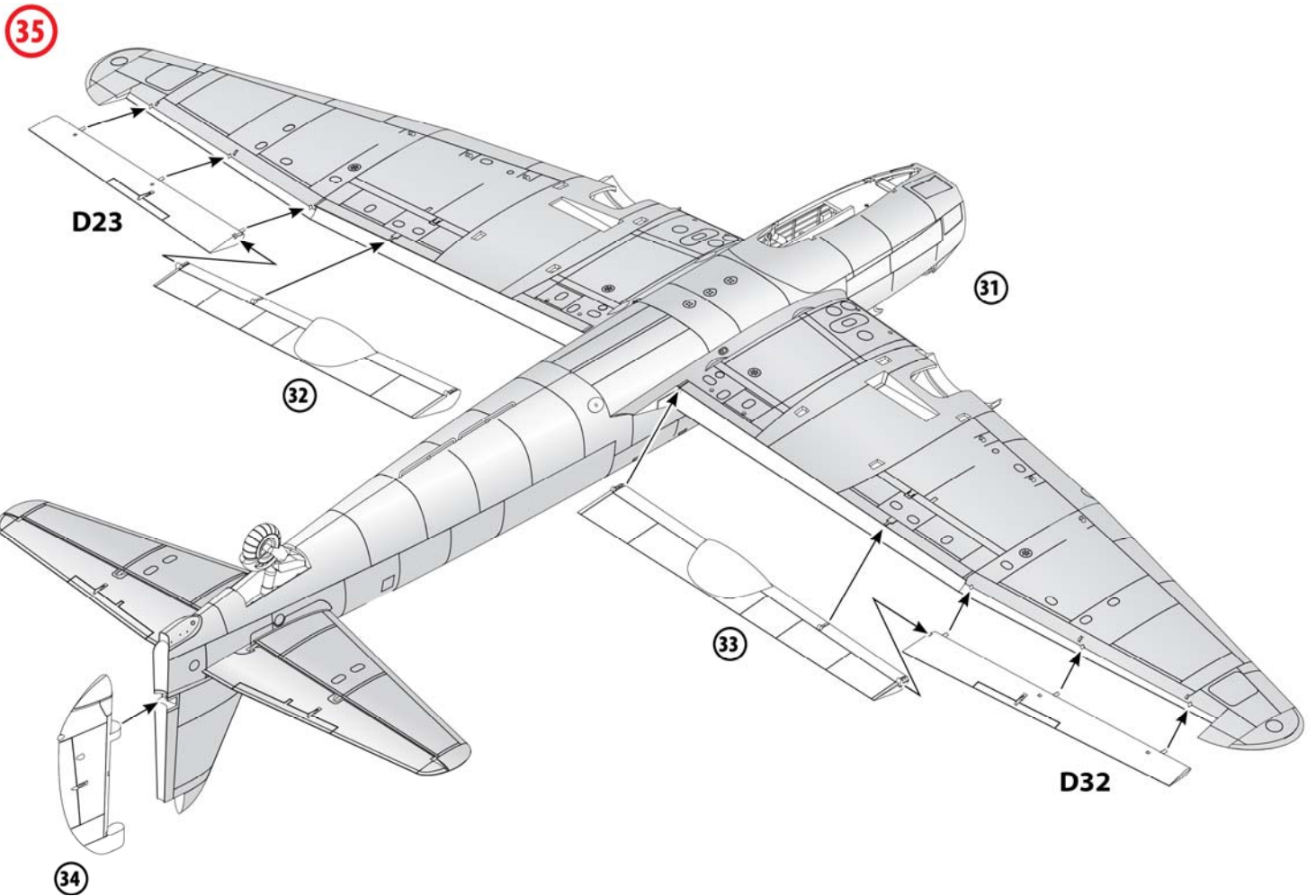
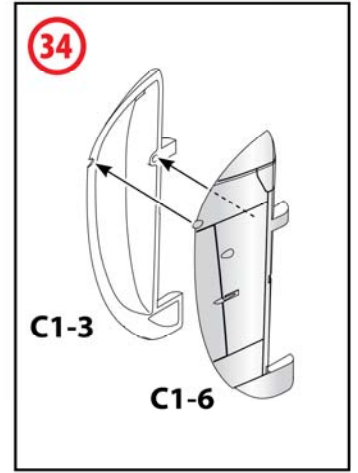
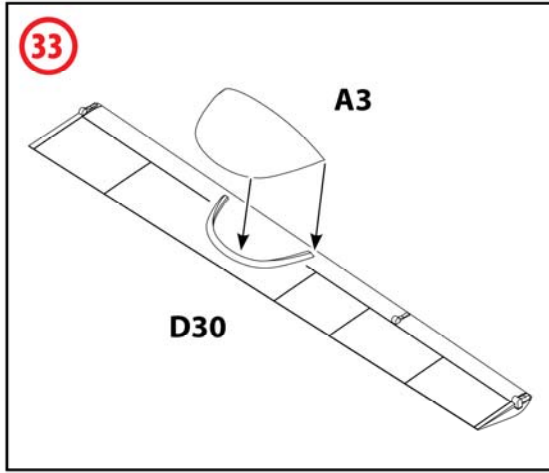
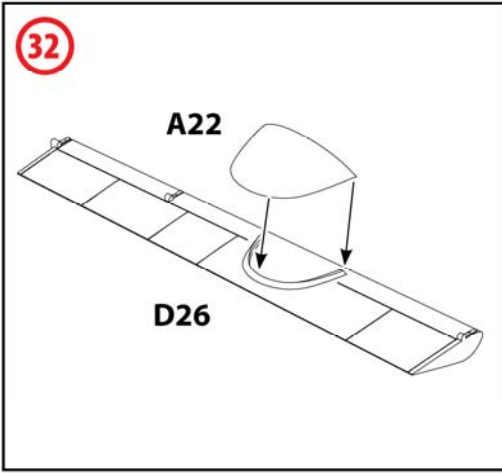

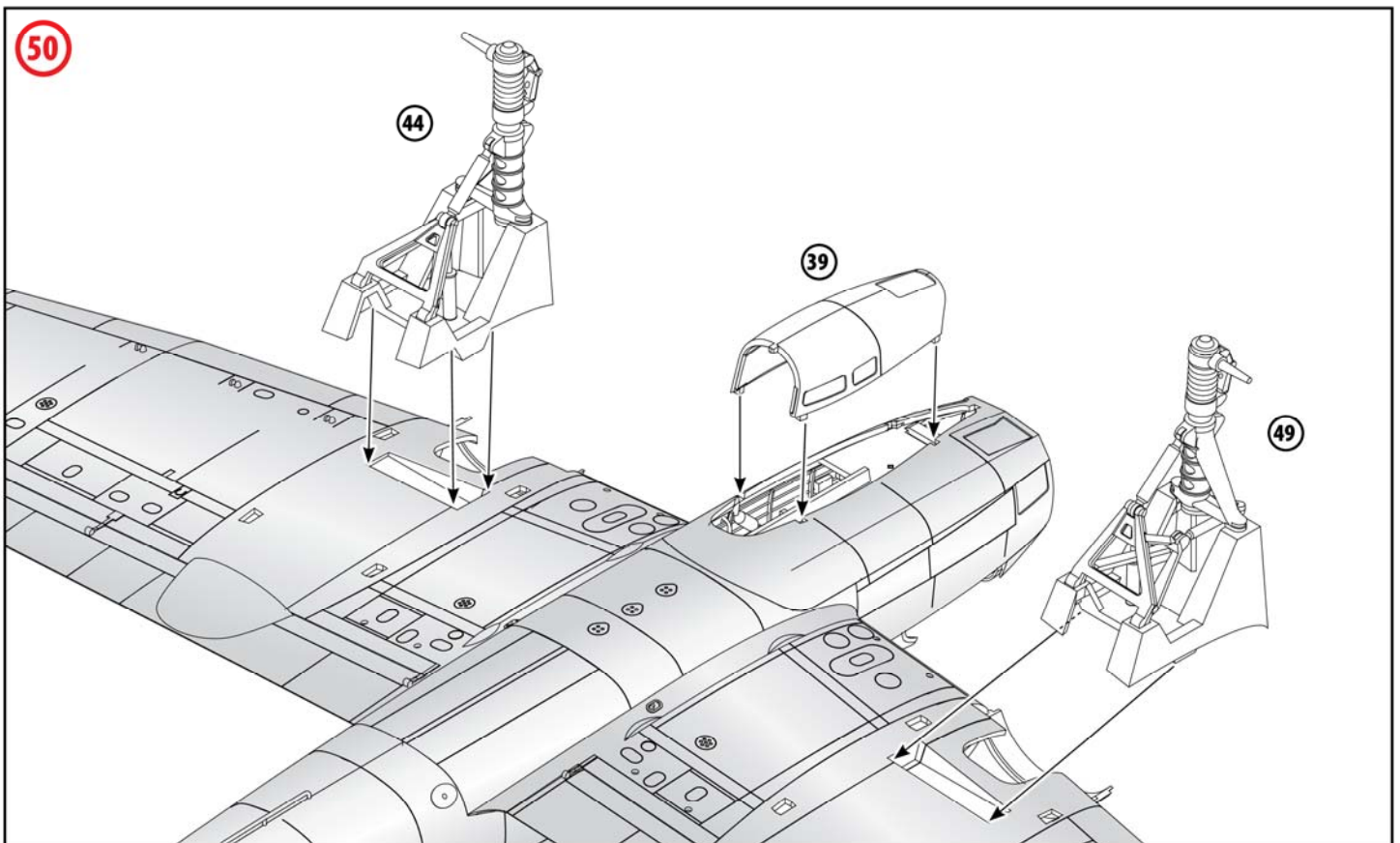
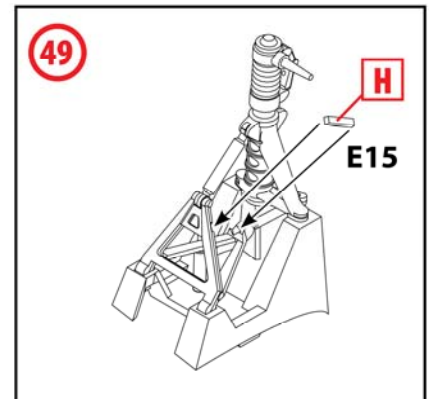
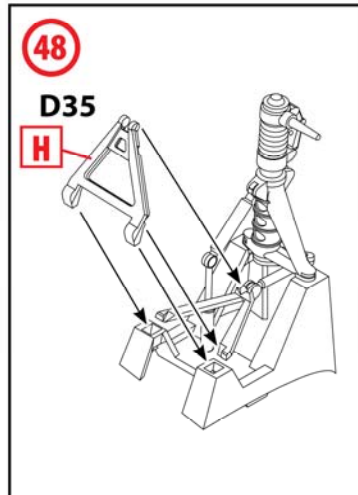
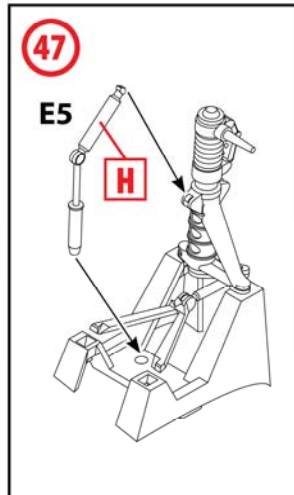
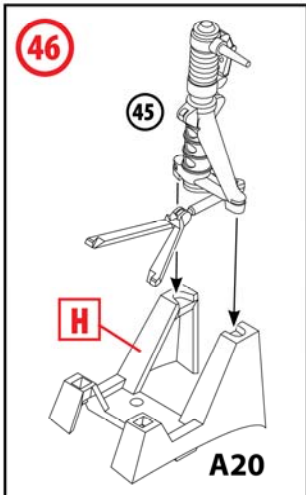
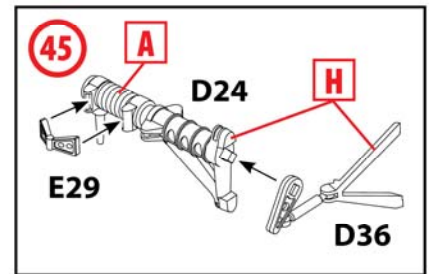
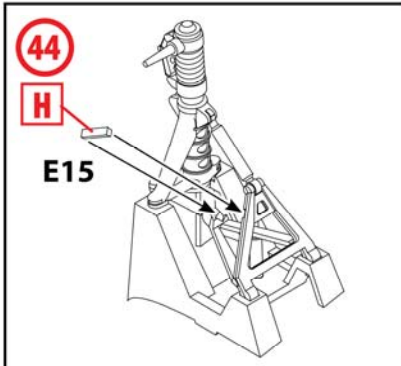
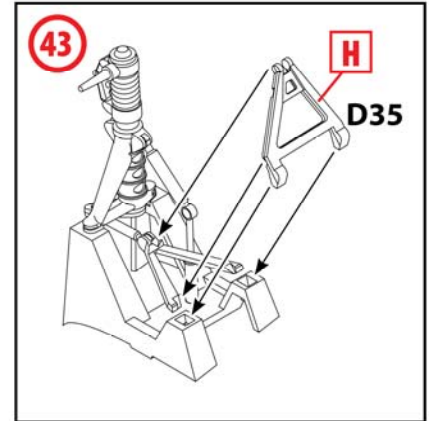
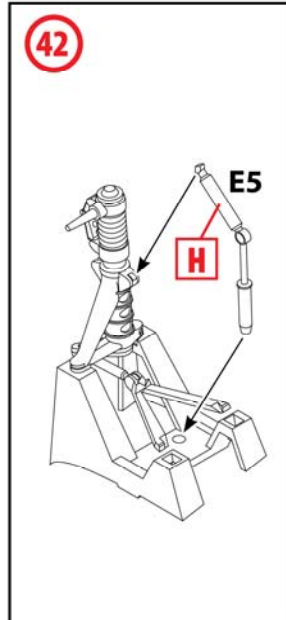
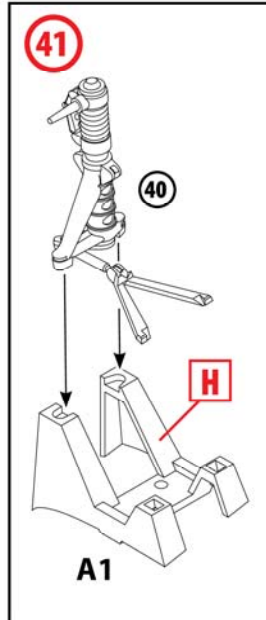
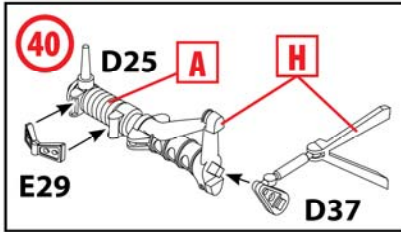

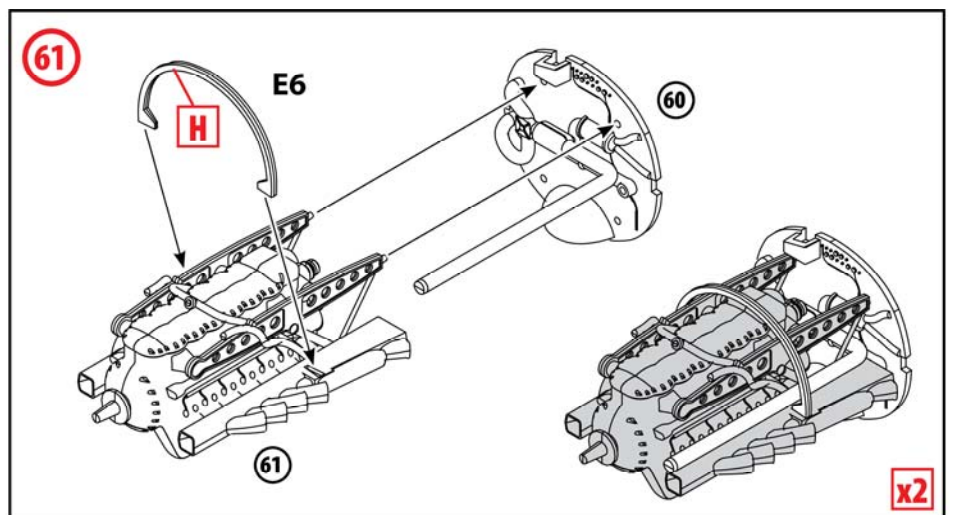
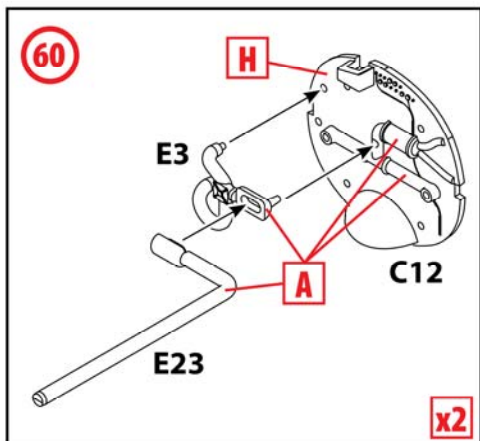
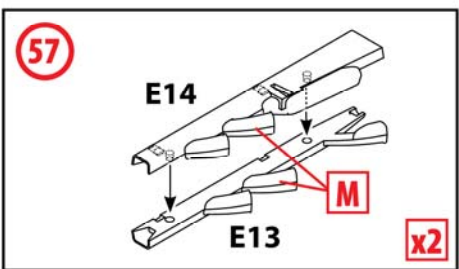
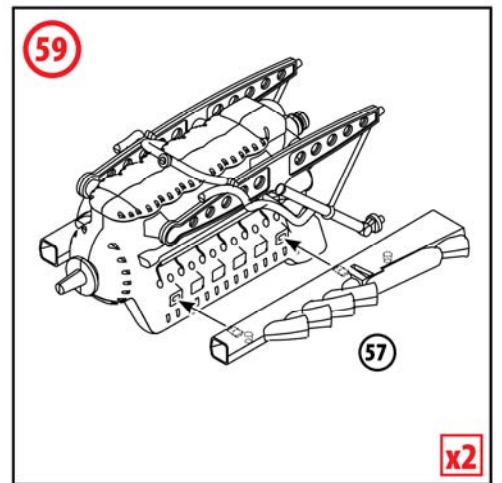
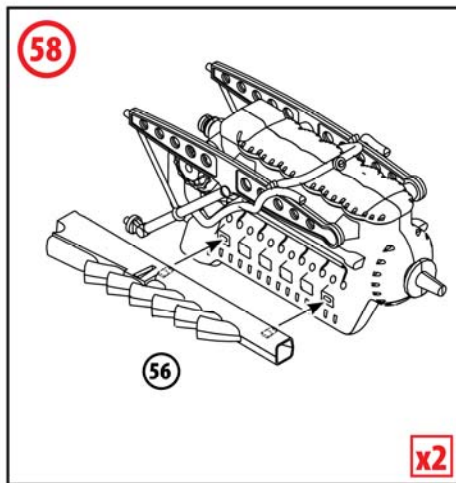
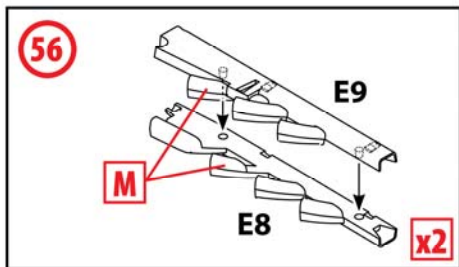
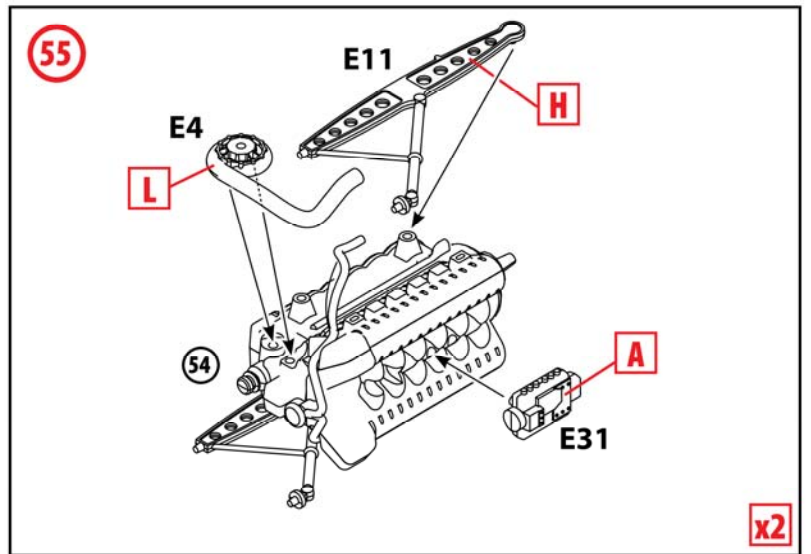
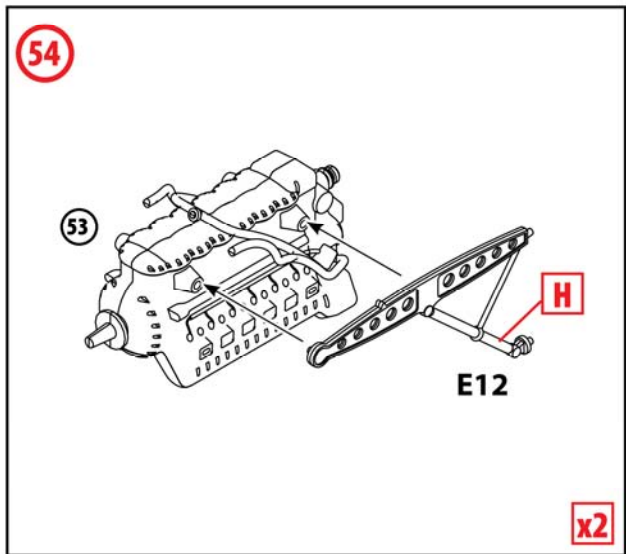
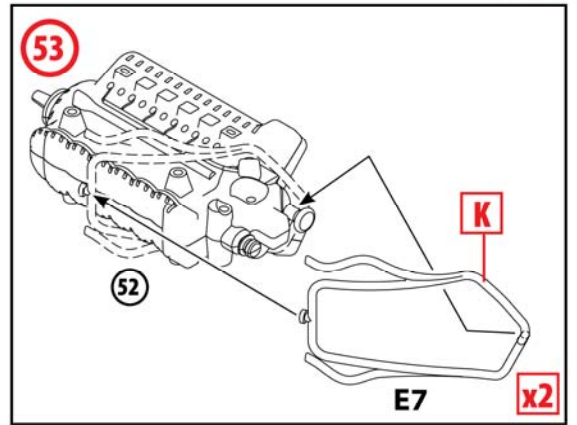
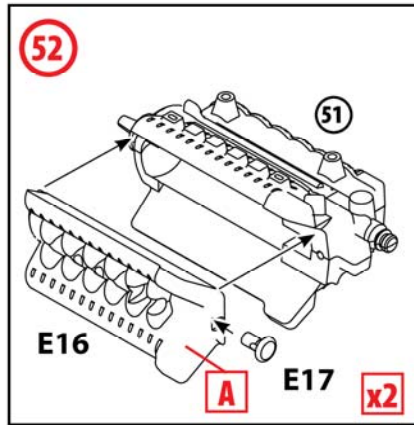
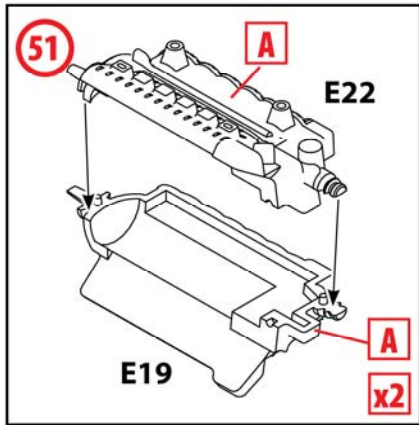

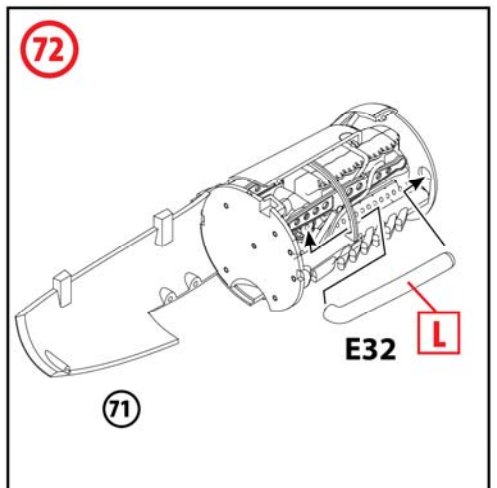
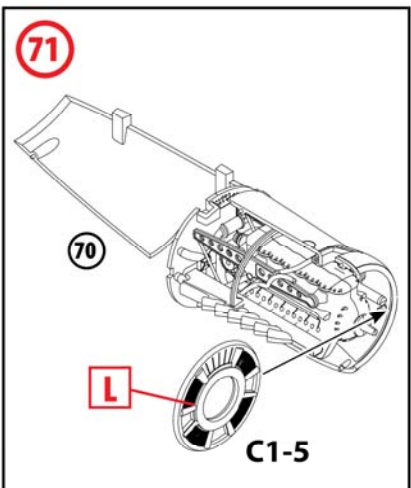
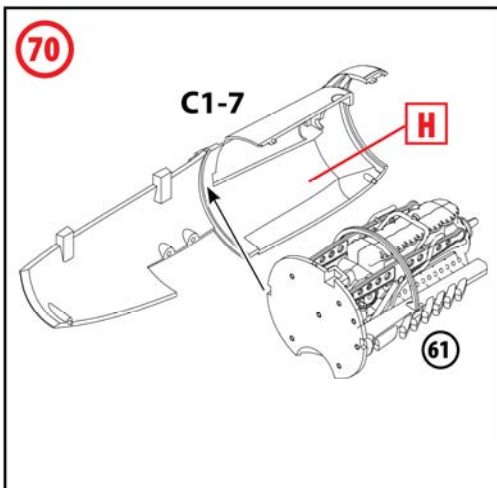
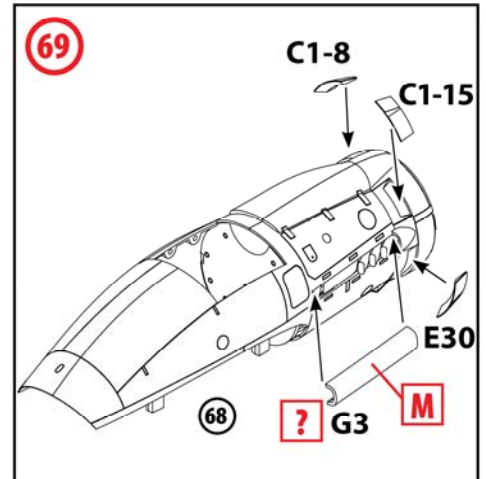
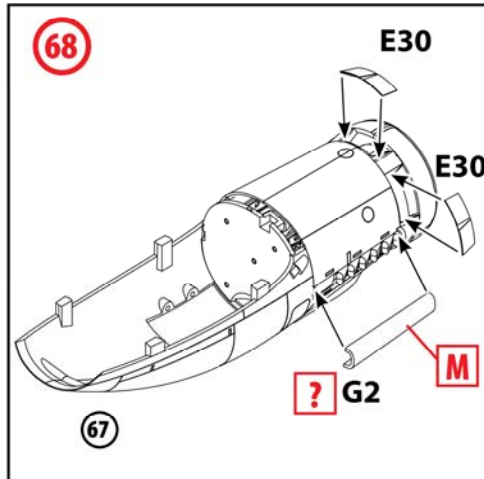
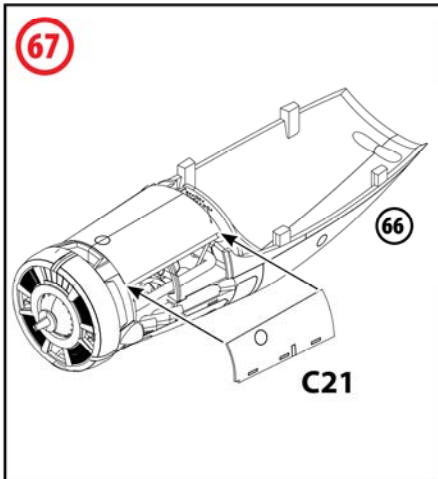
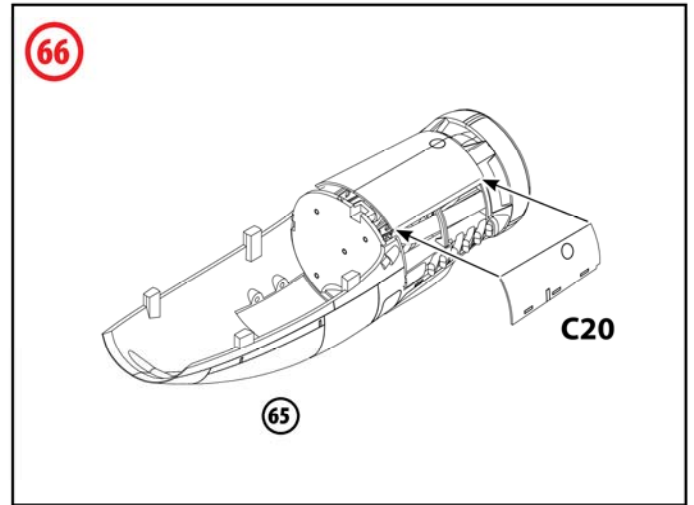
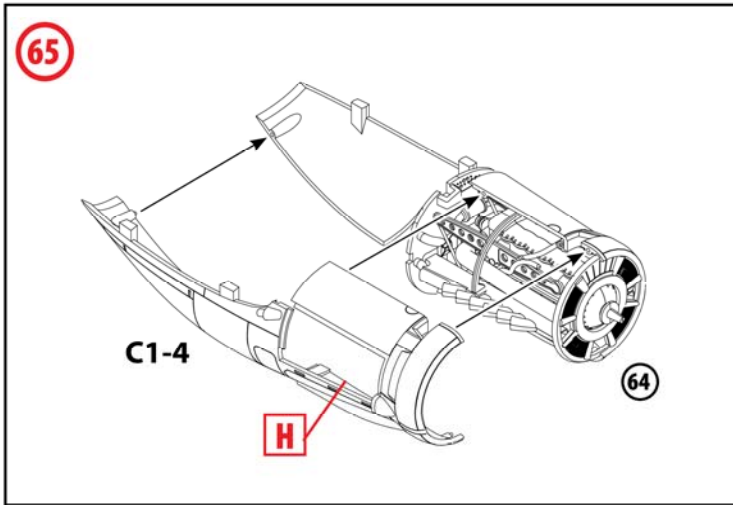
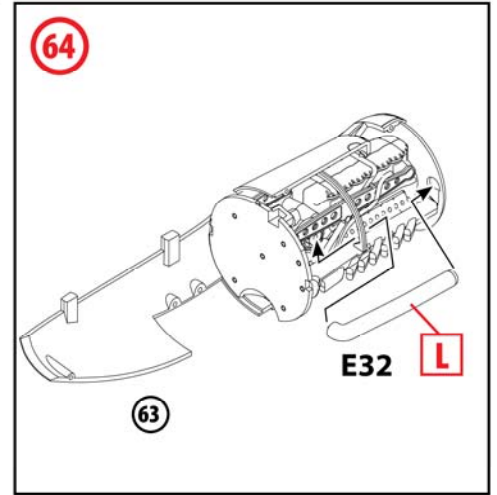
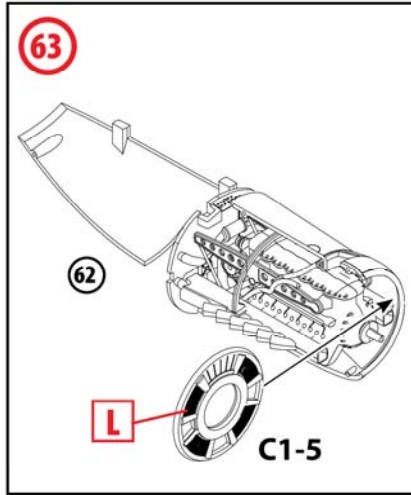
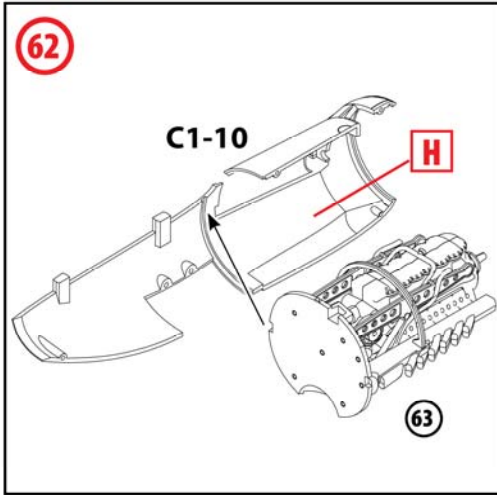

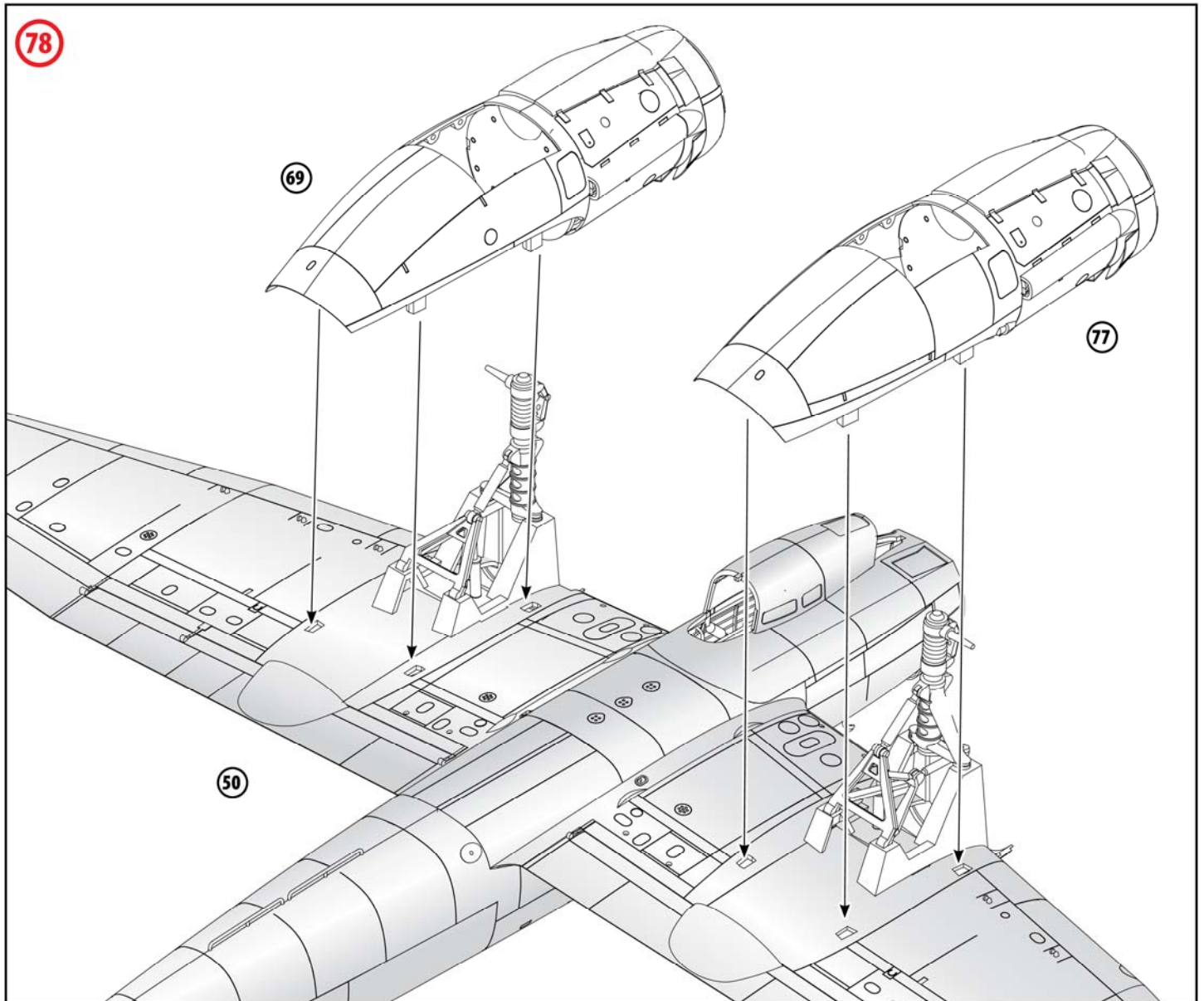
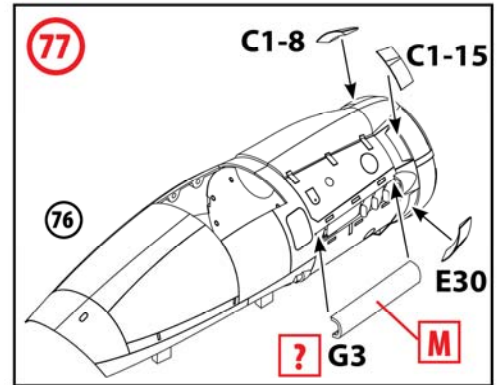
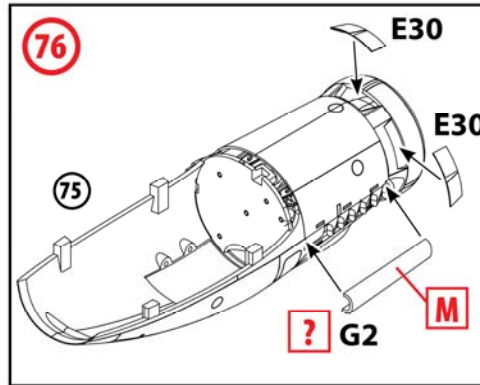
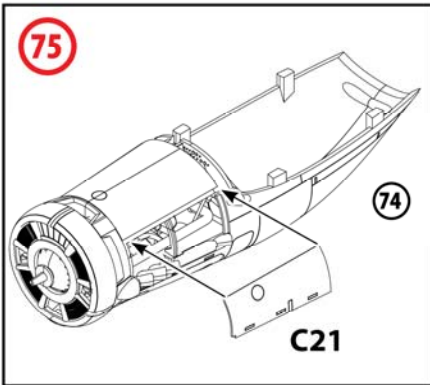
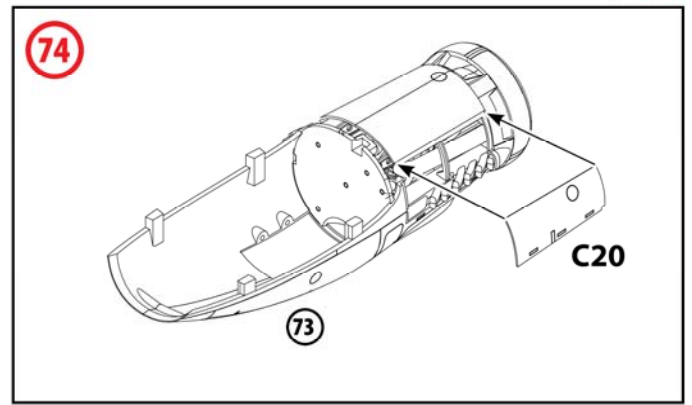
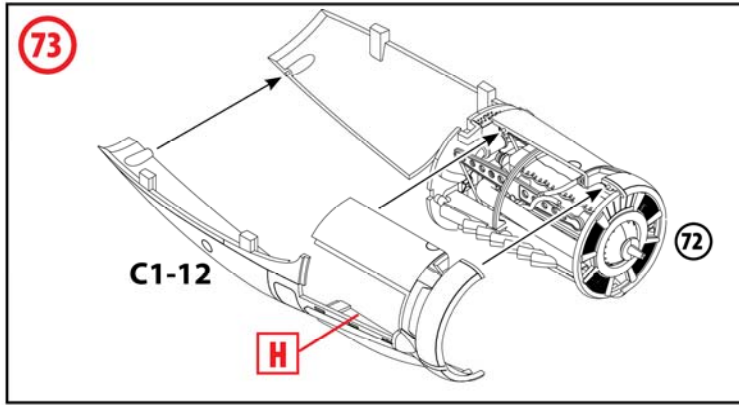

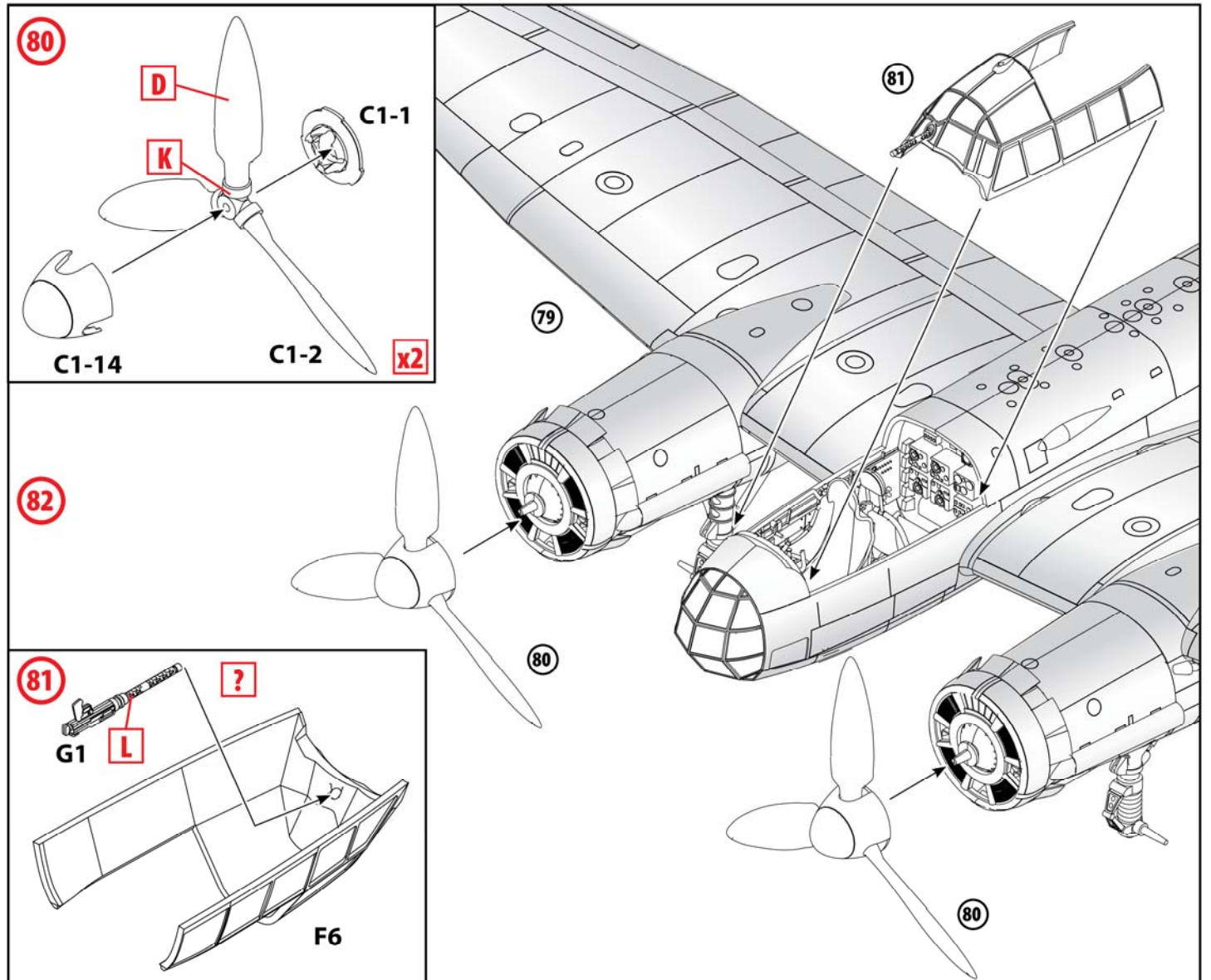
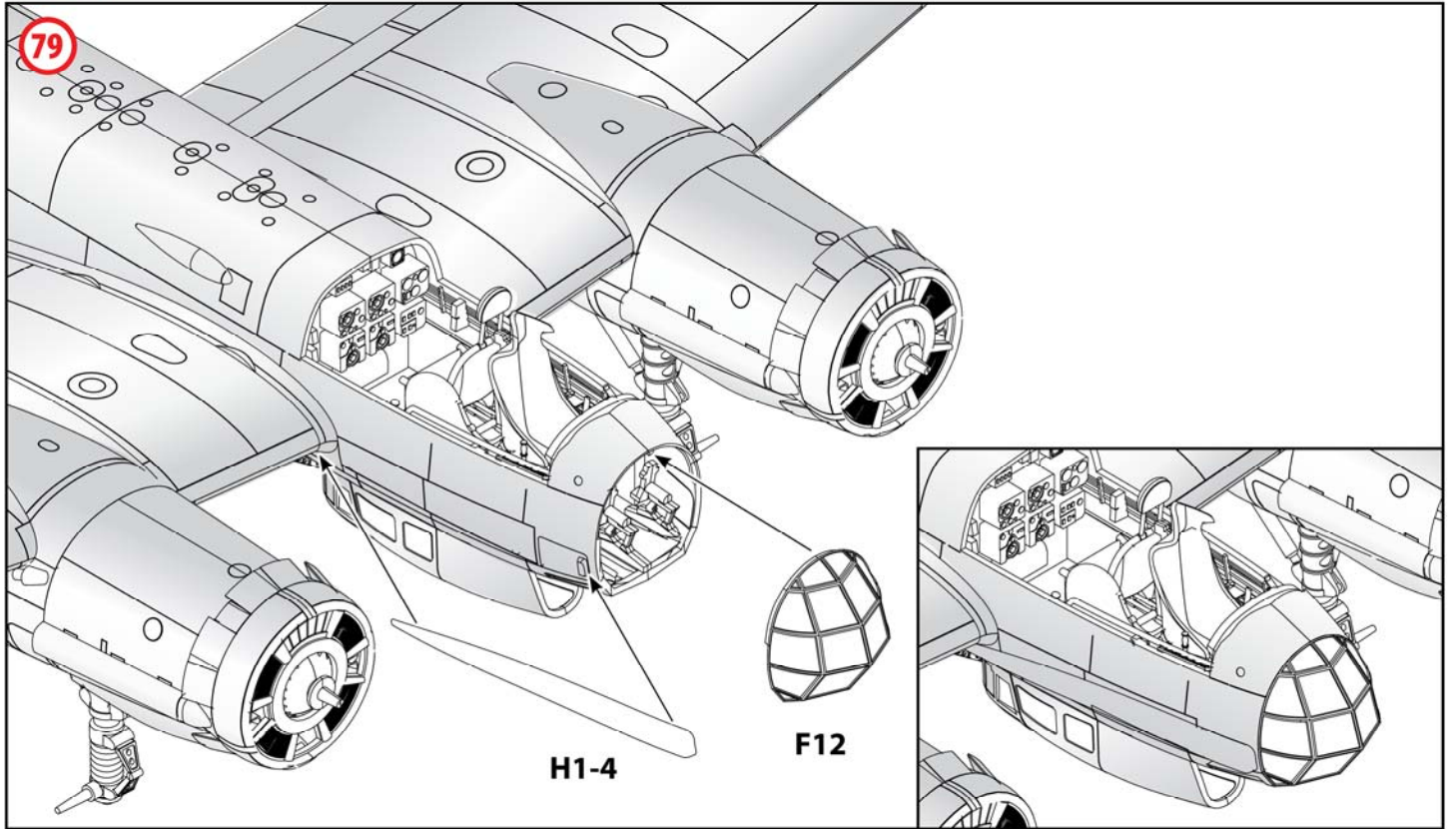

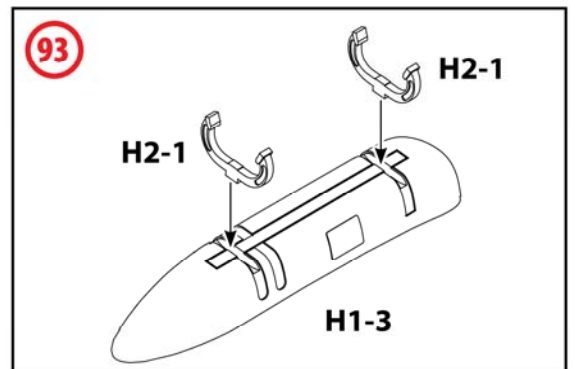
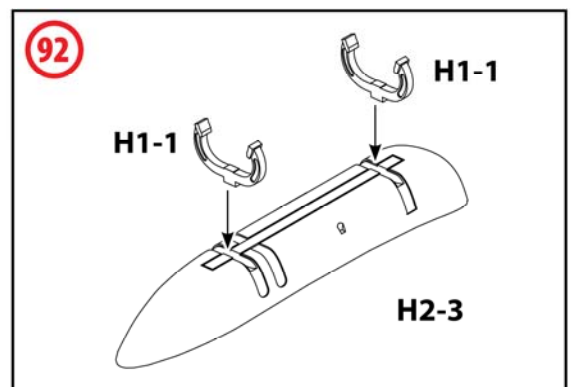
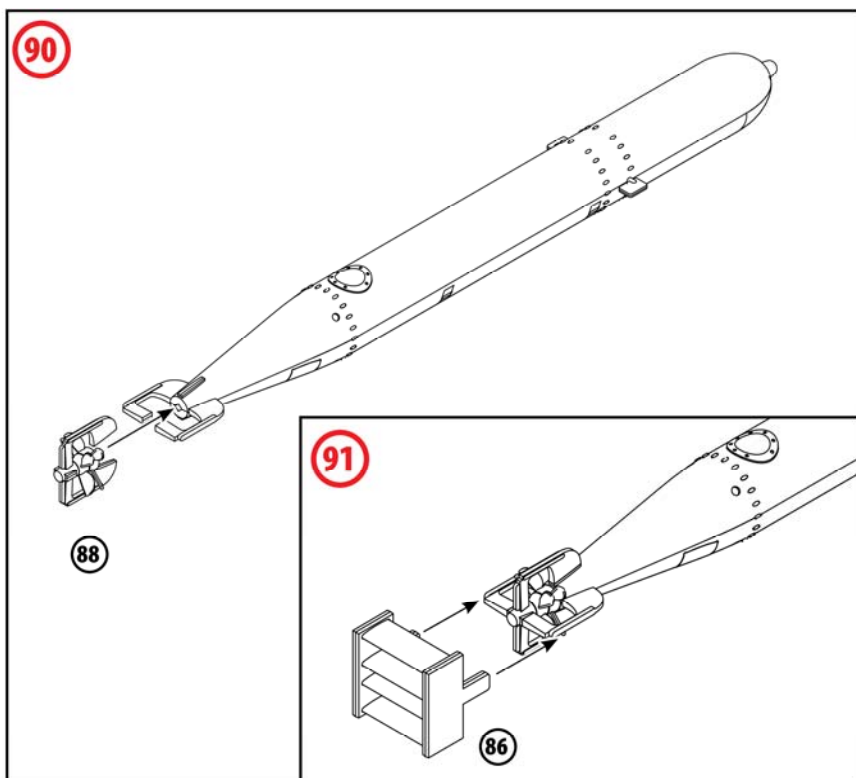
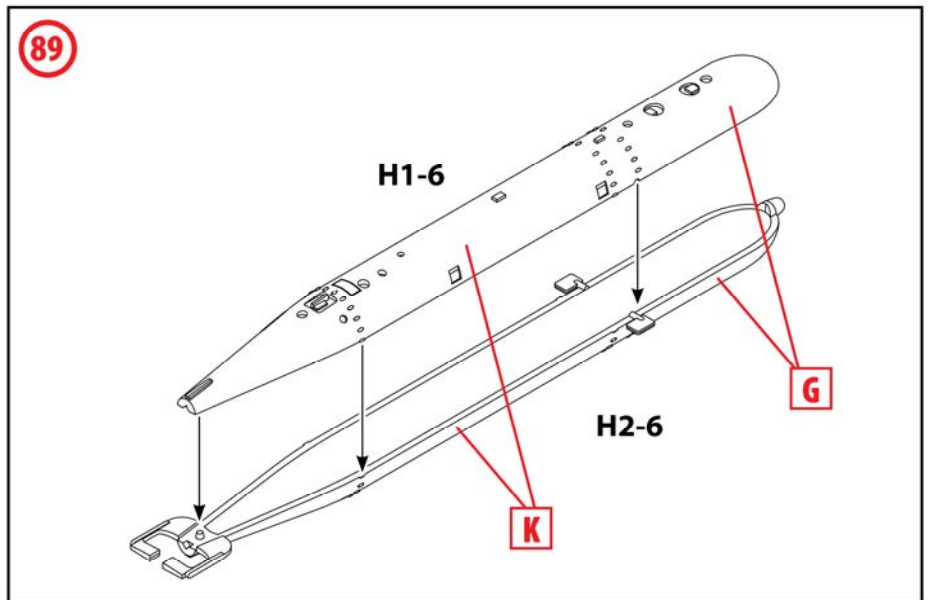
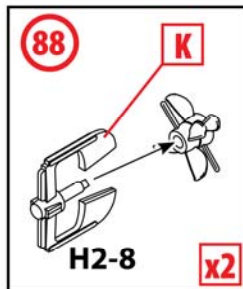
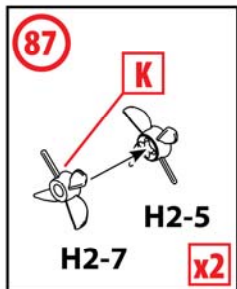
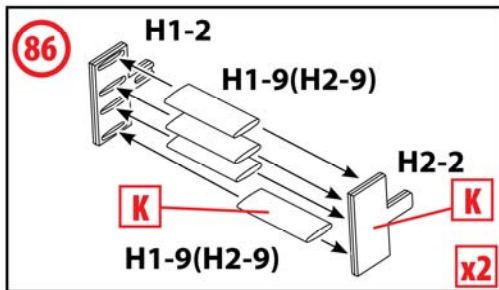
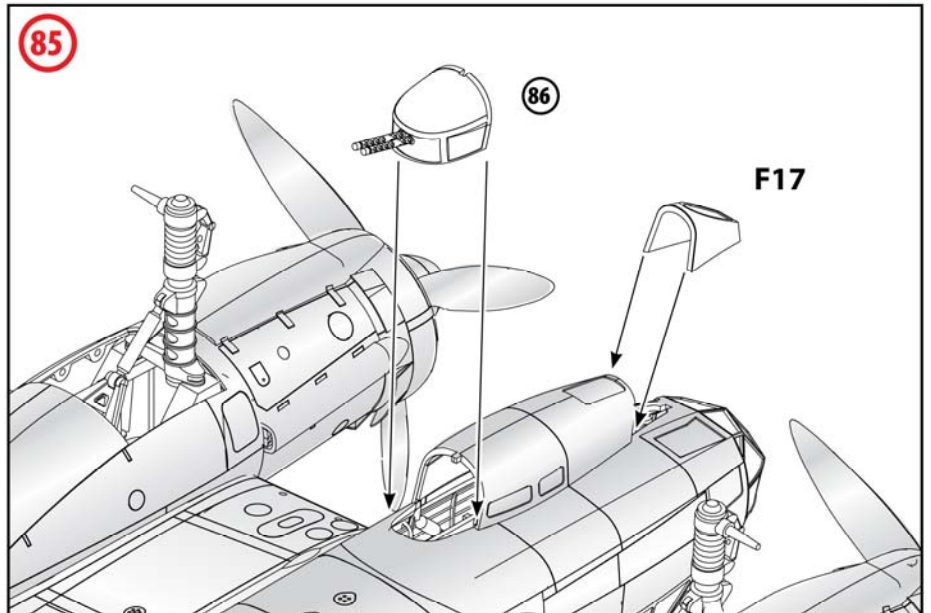
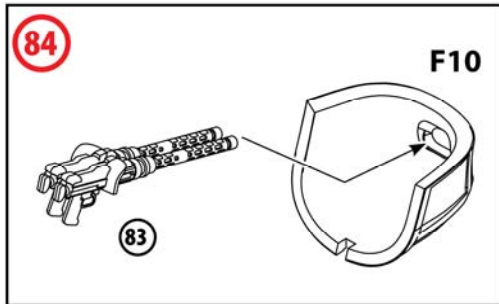
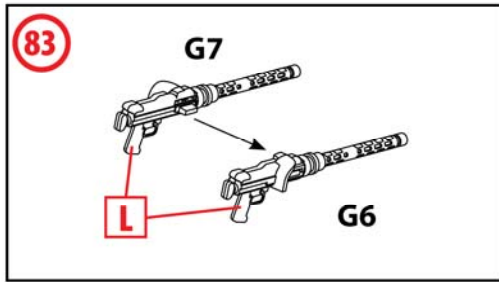

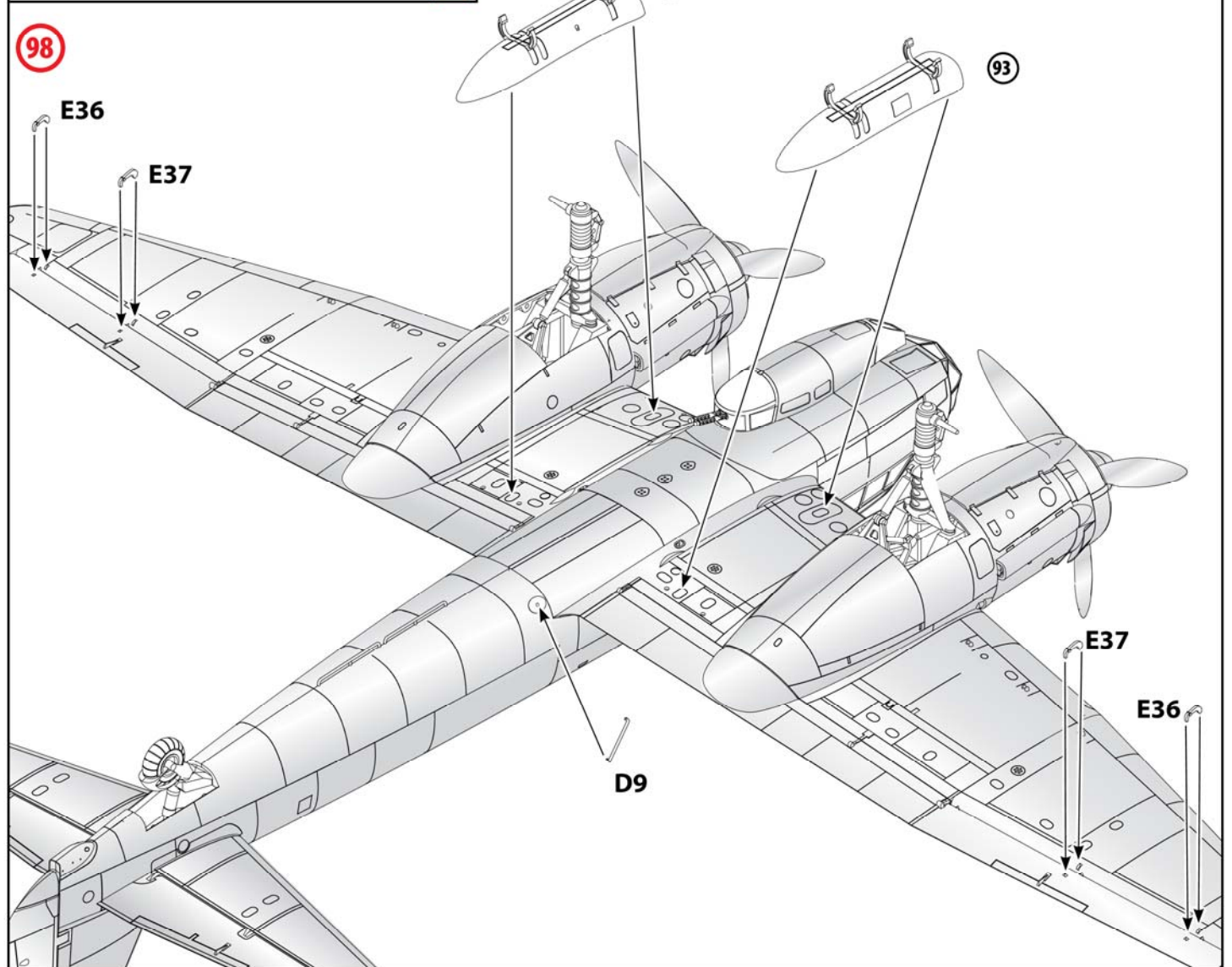
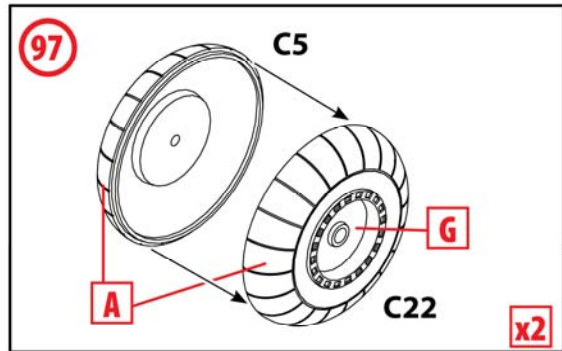
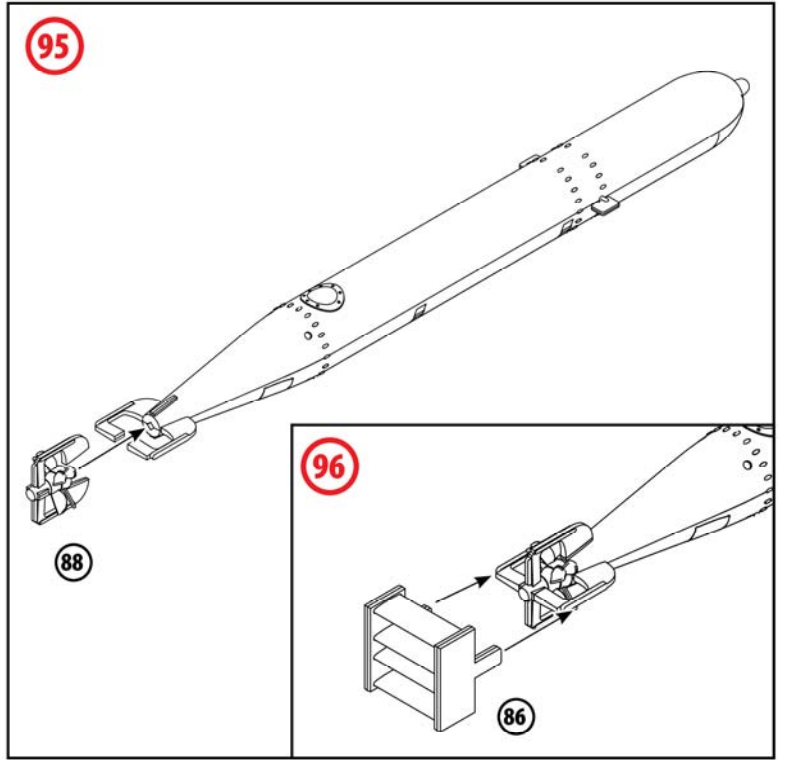
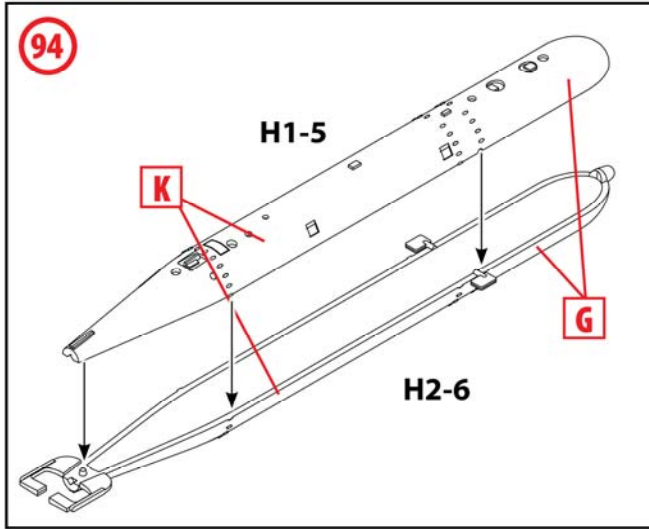

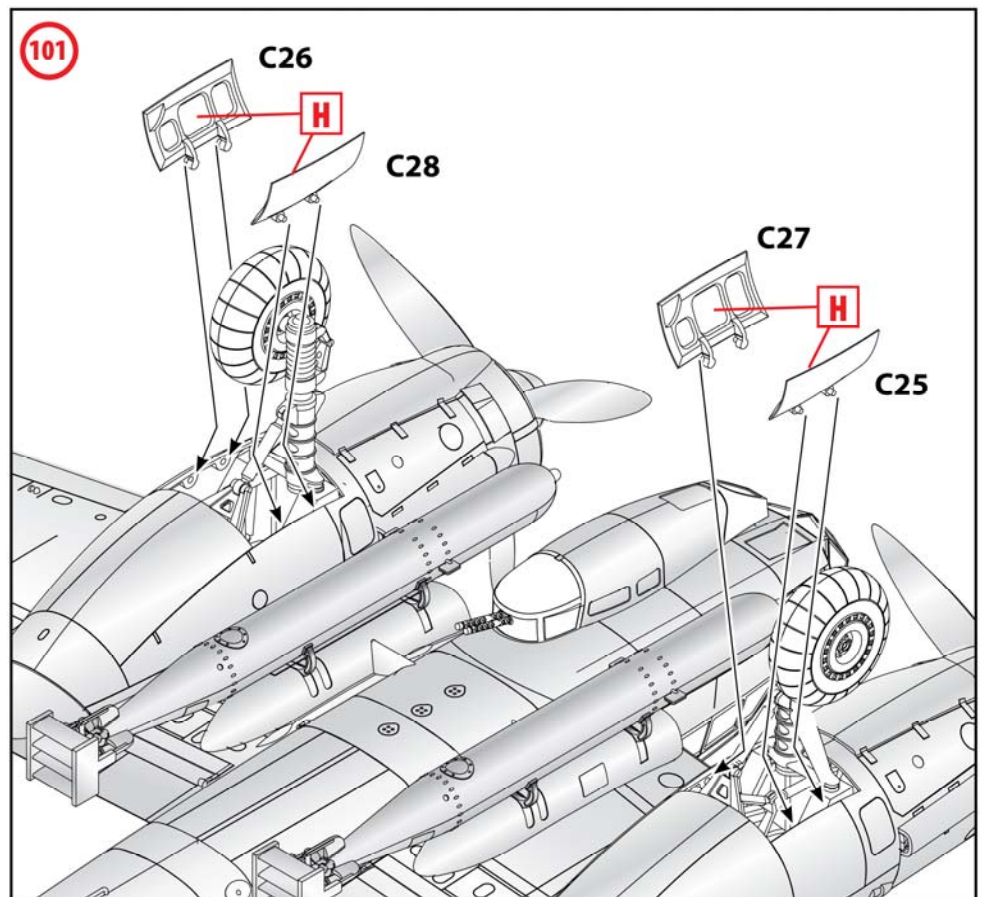
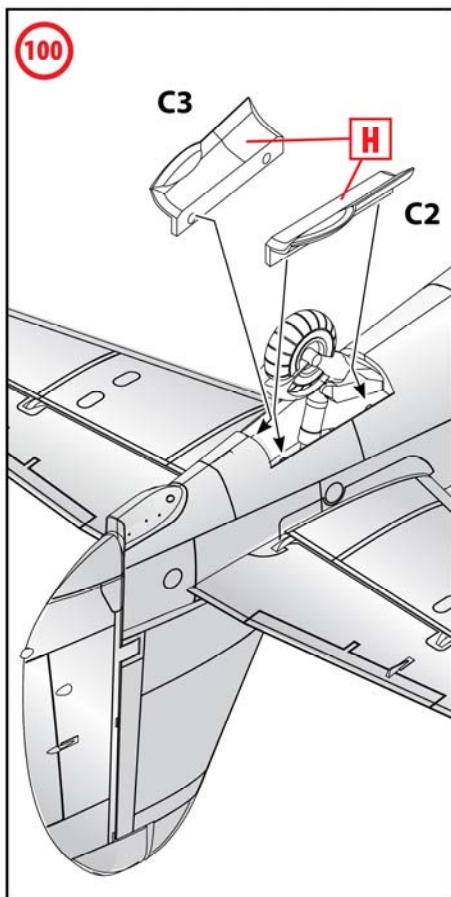
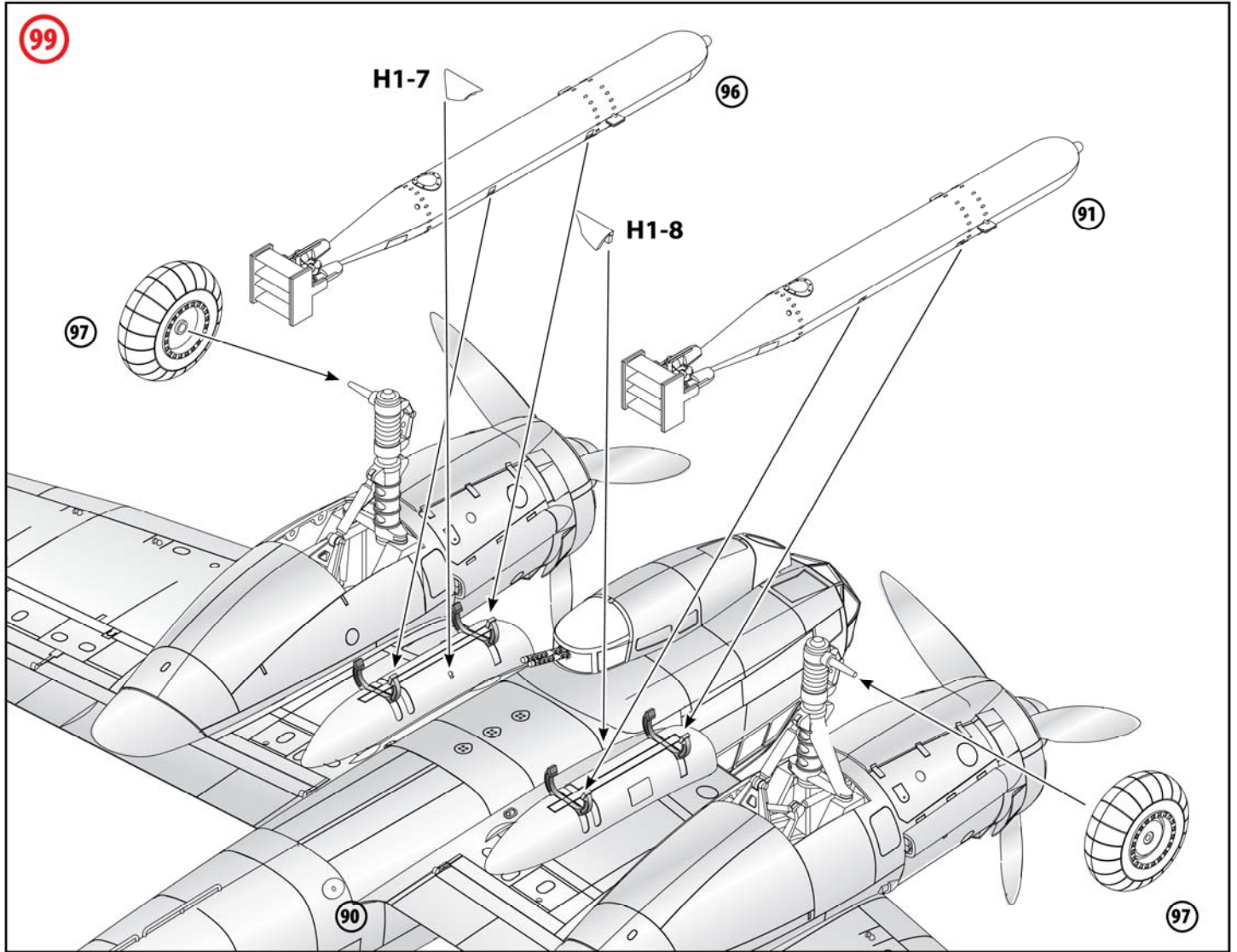

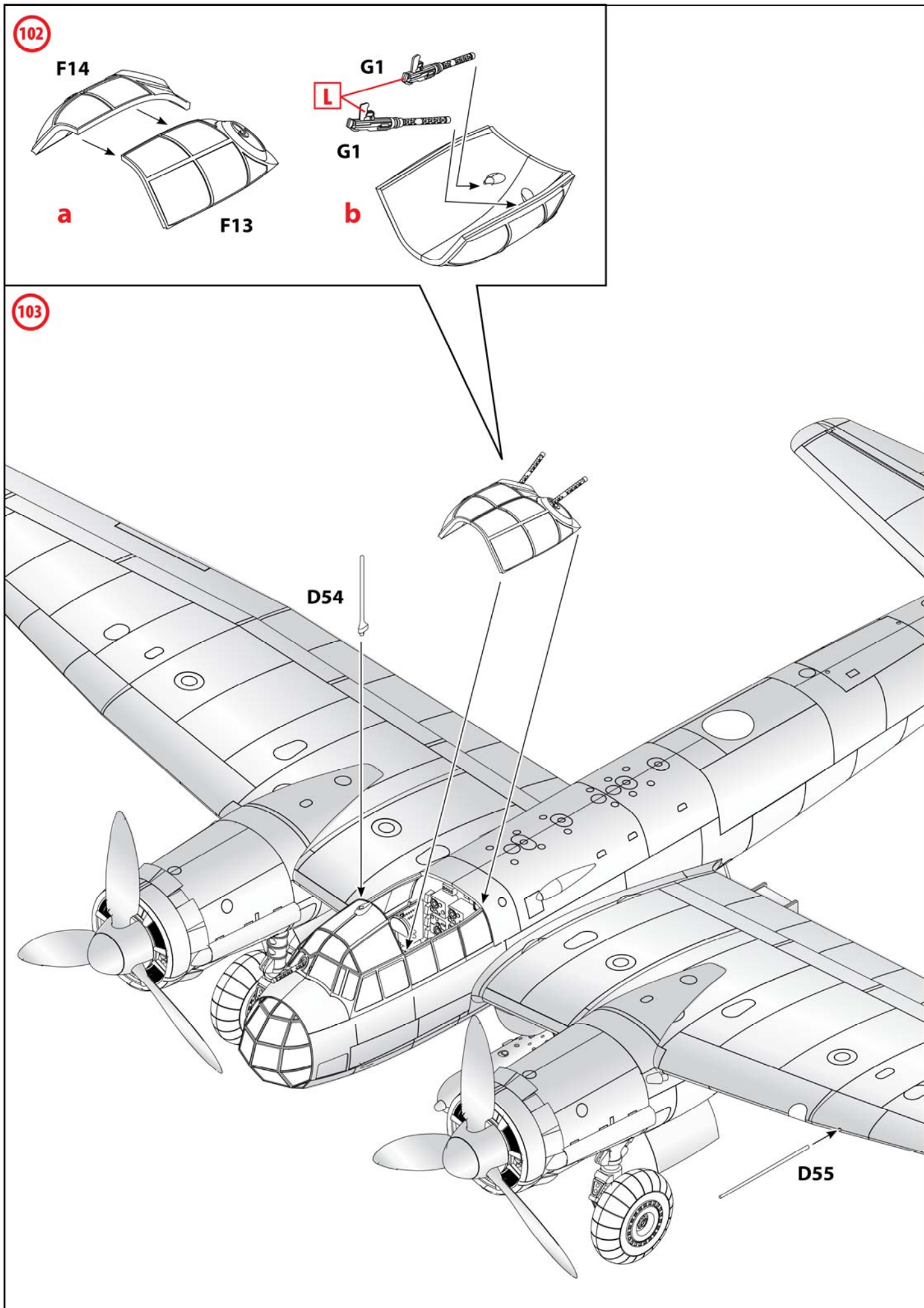

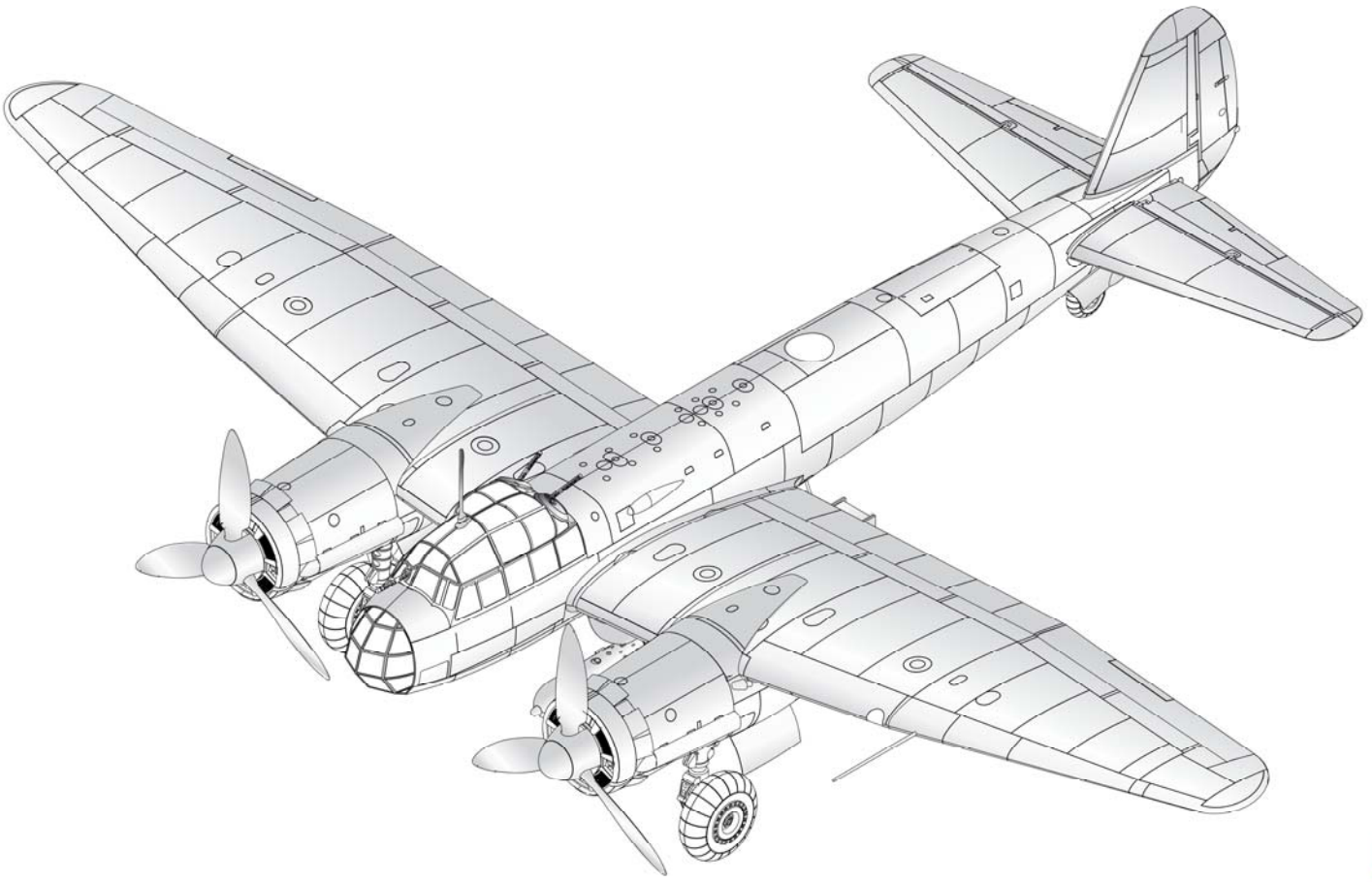

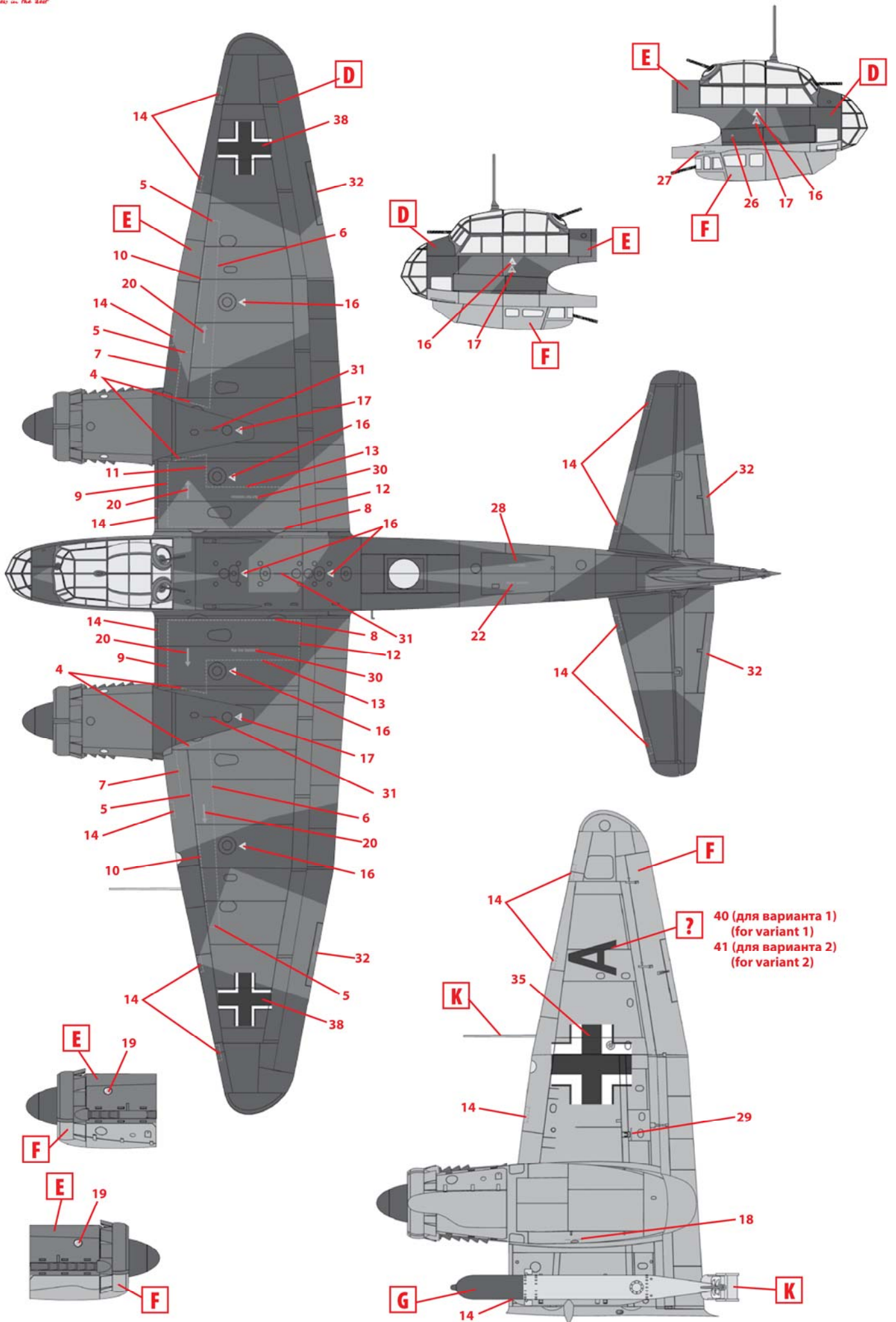

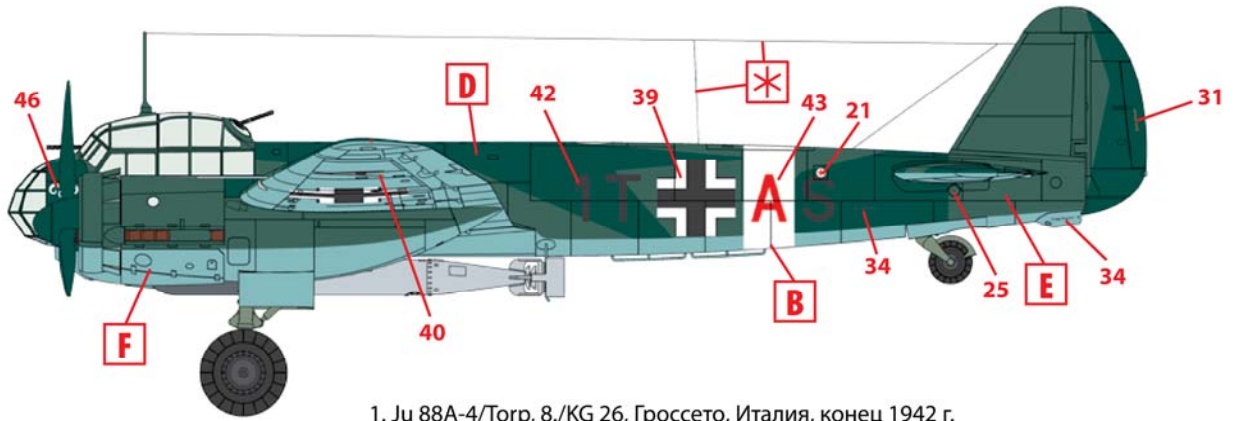

1. Ju 88A-4/Torp, 8./KG 26, Гроссето, Италия, конец 1942 г.
 Ju 88A-4/Torp, 8./KG 26, Grosseto, Italy, late 1942

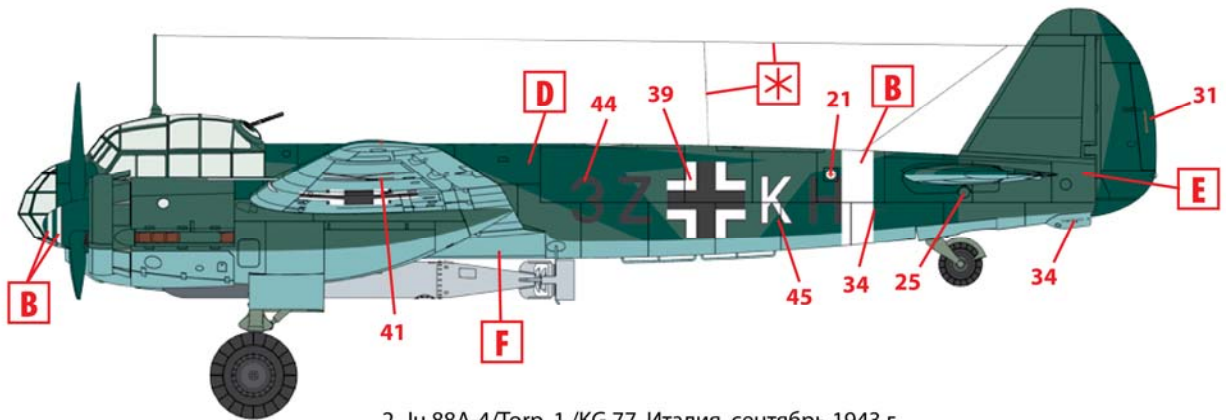
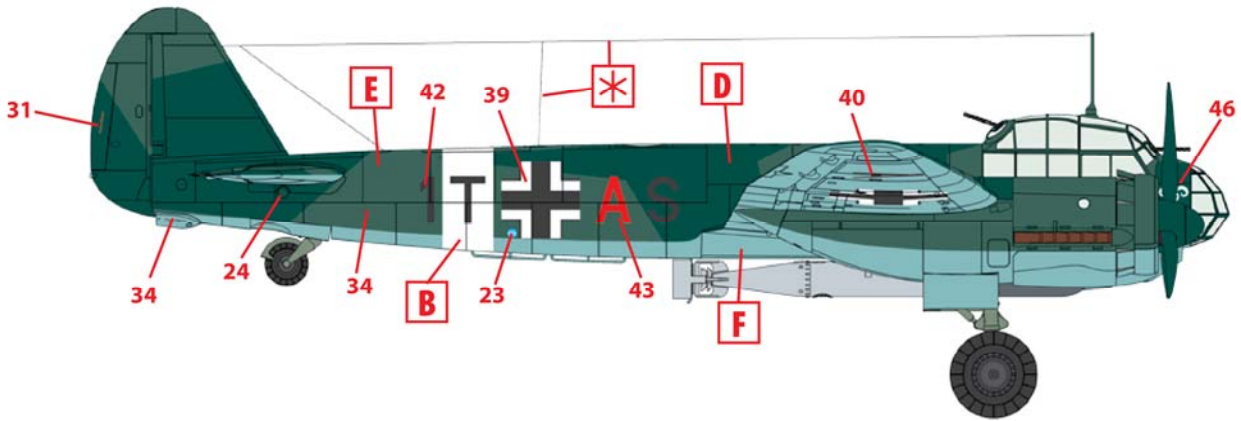

2. Ju 88A-4/Torp, 1./KG 77, Италия, сентябрь 1943 г.
 Ju 88A-4/Torp, 1./KG 77, Italy, September 1943

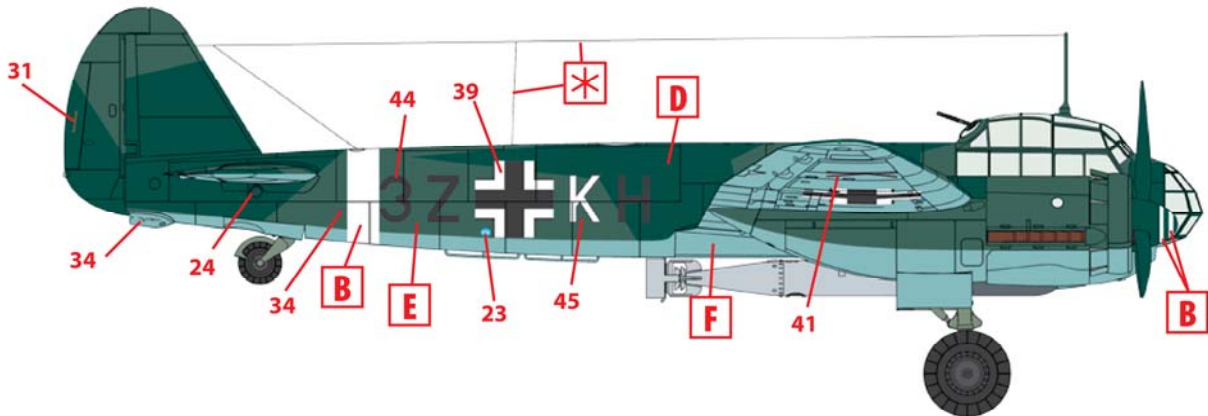

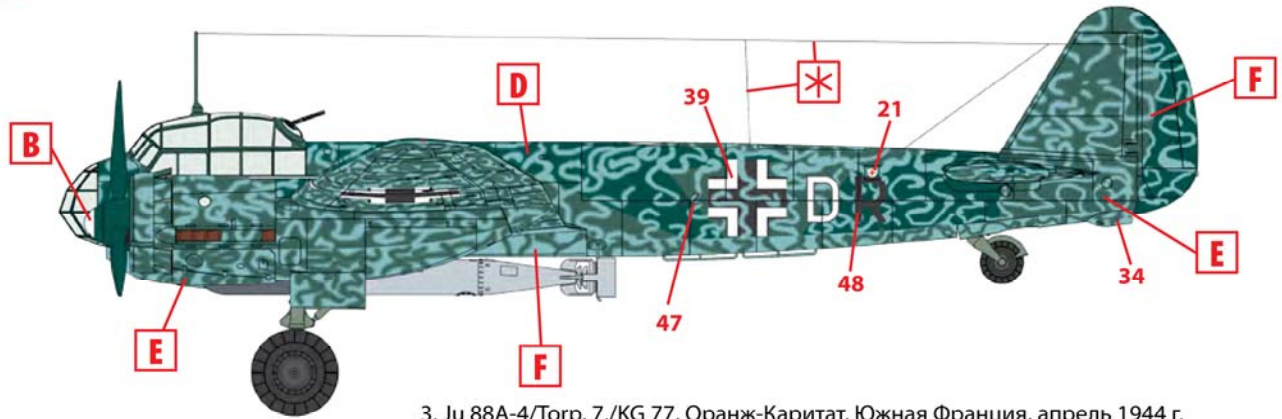

3. Ju 88A-4/Torp, 7./KG 77, Оранже-Каритат, Южная Франция, апрель 1944 г.
 Ju 88A-4/Torp, 7./KG 77, Orange-Karitat, Southern France, April 1944

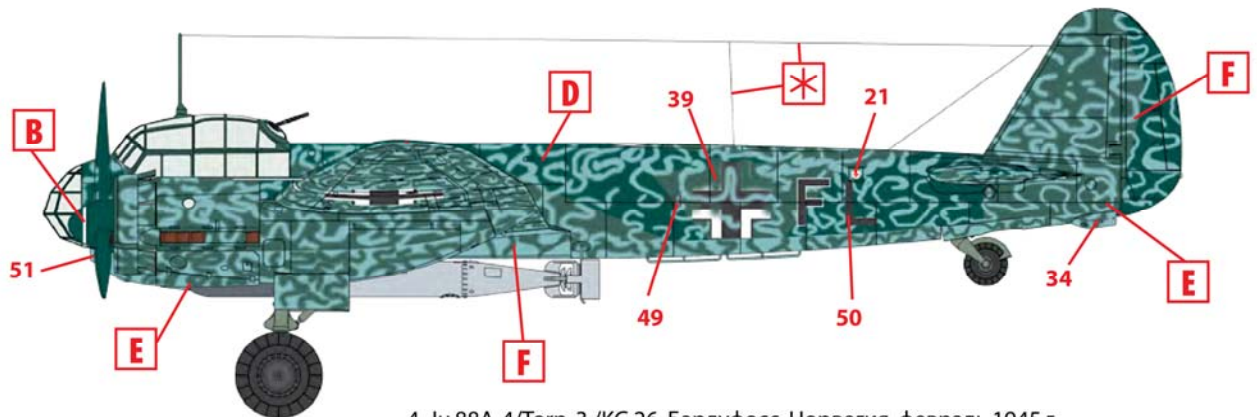
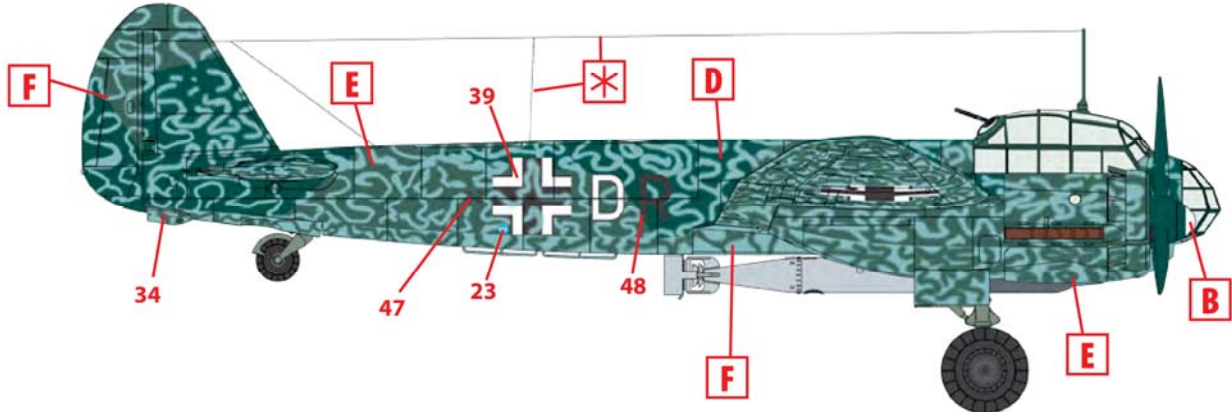

4. Ju 88A-4/Torp, 3./KG 26, Бардусфосс, Норвегия, февраль 1945 г.
 Ju 88A-4/Torp, 3./KG 26, Bardufoss, Norway, February 1945

